



DEPARTMENT OF REGULATORY AND ECONOMIC RESOURCES (RER)  
 BOARD AND CODE ADMINISTRATION DIVISION

MIAMI-DADE COUNTY  
 PRODUCT CONTROL SECTION  
 11805 SW 26 Street, Room 208  
 Miami, Florida 33175-2474  
 T (786) 315-2590 F (786) 315-2599  
[www.miamidade.gov/economy](http://www.miamidade.gov/economy)

**NOTICE OF ACCEPTANCE (NOA)**

**GAF**  
**1 Campus Drive**  
**Parsippany, NJ. 07054**

**SCOPE:**

This NOA is being issued under the applicable rules and regulations governing the use of construction materials. The documentation submitted has been reviewed and accepted by Miami-Dade County RER - Product Control Section to be used in Miami Dade County and other areas where allowed by the Authority Having Jurisdiction (AHJ).

This NOA shall not be valid after the expiration date stated below. The Miami-Dade County Product Control Section (In Miami Dade County) and/or the AHJ (in areas other than Miami Dade County) reserve the right to have this product or material tested for quality assurance purposes. If this product or material fails to perform in the accepted manner, the manufacturer will incur the expense of such testing and the AHJ may immediately revoke, modify, or suspend the use of such product or material within their jurisdiction. RER reserves the right to revoke this acceptance, if it is determined by Miami-Dade County Product Control Section that this product or material fails to meet the requirements of the applicable building code.

This product is approved as described herein, and has been designed to comply with the Florida Building Code including the High Velocity Hurricane Zone of the Florida Building Code.

**DESCRIPTION: Roof Edge Termination Systems**

**LABELING:** Each unit shall bear a permanent label with the manufacturer's name or logo, city, state and following statement: "Miami-Dade County Product Control Approved", unless otherwise noted herein.

**RENEWAL** of this NOA shall be considered after a renewal application has been filed and there has been no change in the applicable building code negatively affecting the performance of this product.

**TERMINATION** of this NOA will occur after the expiration date or if there has been a revision or change in the materials, use, and/or manufacture of the product or process. Misuse of this NOA as an endorsement of any product, for sales, advertising or any other purposes shall automatically terminate this NOA. Failure to comply with any section of this NOA shall be cause for termination and removal of NOA.

**ADVERTISEMENT:** The NOA number preceded by the words Miami-Dade County, Florida, and followed by the expiration date may be displayed in advertising literature. If any portion of the NOA is displayed, then it shall be done in its entirety.

**INSPECTION:** A copy of this entire NOA shall be provided to the user by the manufacturer or its distributors and shall be available for inspection at the job site at the request of the Building Official.

This NOA renews and revises NOA No. 16-0315.04 and consists of pages 1 through 31.  
 The submitted documentation was reviewed by Alex Tigera.



NOA No.: 17-0822.07  
 Expiration Date: 10/18/22  
 Approval Date: 11/02/17  
 Page 1 of 31

## ROOFING COMPONENT APPROVAL

**Category:** Roofing  
**Sub-Category:** Termination Components  
**Materials:** Steel, Aluminum

### MANUFACTURING LOCATIONS:

1. Arden, N.C.

### TRADE NAMES OF PRODUCTS MANUFACTURED OR LABELED BY APPLICANT:

TABLE 1

<u>Product Name</u>	<u>Dimensions</u>	<u>Test Specification</u>	<u>Product Description</u>
<b>M-Weld Snap-On Coping</b>	Maximum length 10' Max wall width 16.75" 6.0" face leg, 4.0" back leg	TAS 111 (C)	Metal snap-on coping with intermittent clips for capping parapet walls. Available in 40" clip spacing
<b>M-Weld Snap-On Coping Plus</b>	Maximum length 10' Max wall width 24.75" 6.0" face leg, 4.0" back leg	TAS 111 (C)	Decorative metal coping cap with galvanized steel anchor/support clips. Available in 40" clip spacing.
<b>EverGuard EZ Fascia EX</b>	Maximum length 10' Maximum face leg 11.25"	TAS 111 (B)	Two-part assembly with an extruded retainer and decorative snap-on fascia cover.
<b>EverGuard EZ Fascia EX Extender</b>	Maximum length 10' Maximum face leg 13"	TAS 111 (B)	Two-part assembly with an extruded retainer and decorative snap-on fascia cover.
<b>EverGuard EZ Fascia</b>	Maximum length 10'. Maximum face leg 10"	TAS 111 (B)	Two-part assembly with rigid formed retainer and a decorative snap-on fascia cover.
<b>EverGuard Snap-On Fascia</b>	Maximum length 10'. Maximum face leg 12"	TAS 111 (B)	Decorative metal fascia with continuous galvanized steel spring cleat.
<b>M-Weld NP Fascia</b>	Maximum length 10' Maximum face leg 12"	TAS 111 (B)	Continuous galvanized steel water dam exterior fascia and continuous galvanized steel retainer.
<b>M-Weld Gravel Stop MB Fascia Type B</b>	Maximum length 10' Maximum face leg 8"	TAS 111 (B)	Continuous anchor cleat and exterior fascia.



**TRADE NAMES OF PRODUCTS MANUFACTURED OR LABELED BY APPLICANT:**

**TABLE 1**

<u>Product Name</u>	<u>Dimensions</u>	<u>Test Specification</u>	<u>Product Description</u>
<b>M-Weld Gravel Stop MB Fascia Type G</b>	Maximum length 10' Maximum face leg 8"	TAS 111 (B)	Continuous anchor cleat and exterior fascia.
<b>EverGuard EZ Fascia AR</b>	Maximum length 10' Maximum face leg 8.25"	TAS 111 (B)	Two-part assembly with rigid formed retainer and a decorative snap-on fascia cover.
<b>M-Weld Formed Coping</b>	Maximum Length 10' Maximum face leg 10" Max wall width 24.5"	TAS 111 (C)	Decorative metal fascia with continuous galvanized steel anchor cleat.
<b>M-Weld Formed Coping Plus</b>	Maximum length 10' Maximum face leg 10" Max wall width 32.5"	TAS 111 (C)	Decorative metal fascia with continuous galvanized steel anchor cleat.
<b>EverGuard EdgeBox RI</b>	Maximum Length 10' Maximum face leg 4.5" Maximum cap width 5.5"	TAS 111 (B)	An engineered metal replacement system for roof nailers.
<b>M-Weld EZ Fascia EX</b>	Maximum length 10' Maximum face leg 11.25"	TAS 111 (B)	Two-part assembly with extruded retainer and a decorative snap-on fascia cover.
<b>M-Weld EZ Fascia EX Extender</b>	Maximum length 10' Maximum face leg 13"	TAS 111 (B)	Two-part assembly with an extruded retainer and decorative snap-on fascia cover.
<b>EverGuard Standard Gravel Stop Fascia</b>	Maximum length 10' Maximum face leg 8"	TAS 111 (B)	Metal Fascia with continuous galvanized steel water dam, and galvanized steel retainer
<b>EverGuard Standard Drip Edge Fascia</b>	Maximum length 10' Maximum face leg 8"	TAS 111 (B)	A metal fascia/edge system with a continuous galvanized steel cleat
<b>EverGuard Extender</b>	Maximum Length 10' Maximum face leg 8"	TAS 111 (B)	System used to extend the coverage of continuous water-tight metal systems.
<b>EverGuard Extender with Offset</b>	Maximum Length 10' Maximum face leg 8"	TAS 111 (B)	System used to extend the coverage of continuous water-tight metal systems.



**TRADE NAMES OF PRODUCTS MANUFACTURED OR LABELED BY APPLICANT:**

**TABLE 1**

<u>Product Name</u>	<u>Dimensions</u>	<u>Test Specification</u>	<u>Product Description</u>
EverGuard WR Box Gutter	Maximum length 10' Maximum face leg 6"	TAS 111 (B)	Gutters fabricated from either aluminum or prefinished steel
EverGuard WR Offset Gutter	Maximum length 10' Maximum face leg 6"	TAS 111 (B)	Gutters fabricated from either aluminum or prefinished steel
EverGuard WR Chamfer Gutter	Maximum length 10' Maximum face leg 6"	TAS 111 (B)	Gutters fabricated from either aluminum or prefinished steel

**EVIDENCE SUBMITTED:**

<u>Test Agency</u>	<u>Test Identifier</u>	<u>Description</u>	<u>Date</u>
Underwriters Laboratories	09NK15606	TAS 111	02/10/10
Factory Mutual	3053167	4435	11/14/16
	3060375	4435	04/3/17



**INSTALLATION:**

**Product Name**                                      **Test Specification**                                      **Product Description**

<b>M-Weld Snap-On Coping</b>	TAS 111 (C)	Metal snap-on coping with intermittent clips for capping parapet walls. <b>40” o.c. clip spacing.</b>
------------------------------	-------------	---

**M-Weld Snap-On Coping** – Maximum length 10’. Coping dimensions listed below. 20ga. galvanized steel hold down clip spaced 40” o.c. Installed with four 1.5” stainless steel hex head screws and washers and four 1.5” stainless steel nails on face leg of clips.

Material	Max Face Height (in.)	Max Wall Width (in.)	Max Back Height (in.)	Perimeter Pressure(psf)		Corner Pressure (psf)	
				Horizontal	Vertical	Horizontal	Vertical
0.040in. Alum	6	16	4	58	101	n/a	n/a
24ga. Steel	6	16	4	58	101	n/a	n/a

<b>M-Weld Snap-On Coping Plus</b>	TAS 111 (C)	Metal snap-on coping with intermittent clips for capping parapet walls available in <b>40” clip spacing.</b>
-----------------------------------	-------------	--

**M-Weld Snap-On Coping Plus** - Maximum length 10’. Coping dimensions listed below. 16ga. galvanized steel hold down cleat spaced 40” o.c. Installed with four 1.5” stainless steel hex head screws and washers and four 1.5” stainless steel nails on face leg of clips.

Material	Max Face Height (in.)	Max Wall Width (in.)	Max Back Height (in.)	Perimeter Pressure(psf)		Corner Pressure (psf)	
				Horizontal	Vertical	Horizontal	Vertical
0.050in. Alum	6	16	4	73	126	n/a	n/a
0.080in. Alum	6	16	4	87	151	73	152
22ga. Steel	6	24	4	73	126	n/a	n/a

<b>EverGuard EZ Fascia EX</b>	TAS 111 (B)	Two-part assembly with an extruded retainer and decorative snap-on fascia cover.
-------------------------------	-------------	--

**EverGuard EZ Fascia EX** - Maximum length 10’. Maximum face height listed below, minimum 0.050” extruded aluminum retainer bar with snap-on fascia cover. Installed with 1.5” stainless steel hex head screws 12” o.c.

Material	Max Face Height (in.)	Perimeter Pressure(psf)		Corner Pressure (psf)	
		Horizontal	Vertical	Horizontal	Vertical
0.040in. Alum	6.75	204	n/a	200	n/a
0.040in. Alum	8.25	146	n/a	145	n/a
0.040in. Alum	11.25	73	n/a	73	n/a
0.050in. Alum	11.25	116	n/a	127	n/a
24ga. Steel	6.75	247	n/a	253	n/a
24ga. Steel	8.25	160	n/a	163	n/a
24ga. Steel	11.25	87	n/a	91	n/a



<b>EverGuard EZ Fascia EX Extender</b>	TAS 111 (B)	Two-part assembly with an extruded retainer and decorative snap-on fascia cover			
<b>EverGuard EZ Fascia EX Extender</b> - Maximum length 10'. Maximum face height listed below. Minimum 0.050" extruded aluminum retainer bar with a 22ga. galvanized steel extender clip and a snap-on fascia cover. Installed with 1.5" stainless steel hex head screws 12" o.c.					
Material	Max Face Height (in.)	Perimeter Pressure(psf)		Corner Pressure (psf)	
		Horizontal	Vertical	Horizontal	Vertical
0.040in. Alum	13	73	n/a	73	n/a
0.050in. Alum	13	102	n/a	91	n/a
24ga. Steel	13	87	n/a	91	n/a

<b>EverGuard EZ Fascia</b>	TAS 111 (B)	Two-part assembly with rigid formed retainer and a decorative snap-on fascia cover.			
<b>EverGuard EZ Fascia</b> - Maximum length 10'. Maximum face width listed below. Minimum 20ga. galvanized steel cleat with snap-on fascia cover. Installed with 1.5" stainless steel hex head screws 12" o.c.					
Material	Max Face Height (in.)	Perimeter Pressure(psf)		Corner Pressure (psf)	
		Horizontal	Vertical	Horizontal	Vertical
0.040in. Alum	5.25	320	n/a	325	n/a
0.040in. Alum	6	204	n/a	200	n/a
0.040in. Alum	10	102	n/a	109	n/a
24ga. Steel	5.25	378	n/a	379	n/a
24ga. Steel	6	247	n/a	236	n/a
24ga. Steel	10	131	n/a	127	n/a
0.039in. Zinc	6	189	n/a	182	n/a
0.039in. Zinc	10	131	n/a	127	n/a



<b>EverGuard Snap-On Fascia</b>	TAS 111 (B)	Decorative metal fascia with continuous galvanized steel spring cleat.
---------------------------------	-------------	--

**EverGuard Snap-On Fascia** - Maximum length 10'. Maximum face width listed below. 22ga. or 24ga. galvanized steel spring cleat with snap-on fascia cover. Installed with 1.5" ring shank nails 12" o.c. For 6" face, base clip is secured with a row of fasteners spaced 12" o.c. For 6"-12" face, base clip is secured with two staggered rows on vertical face and one row 12" o.c. on horizontal face.

Material	Max Face Height (in.)	Retainer (ga.)	Perimeter Pressure(psf)		Corner Pressure (psf)	
			Horizontal	Vertical	Horizontal	Vertical
0.050in. Alum	6	24	73	n/a	73	n/a
0.050in. Alum	9	22	87	n/a	91	n/a
0.050in. Alum	12	22	116	n/a	109	n/a
24ga. Steel	6	24	87	n/a	91	n/a
24ga. Steel	9	22	102	n/a	91	n/a
24ga. Steel	12	22	102	n/a	91	n/a

<b>M-Weld NP Fascia</b>	TAS 111 (B)	Continuous galvanized steel water dam exterior fascia and continuous galvanized steel retainer.
-------------------------	-------------	---

**M-Weld NP Fascia** - Maximum length 10'. Face width listed below. Minimum 20ga. galvanized steel continuous retainer with fascia cover. Installed with 1.5" ring shank nails 12" o.c. For 6" face, base clip is secured with a row of fasteners spaced 12" o.c. For 6"-12" face, base clip is secured with two staggered rows on vertical face.

Material	Max Face Height (in.)	Perimeter Pressure(psf)		Corner Pressure (psf)	
		Horizontal	Vertical	Horizontal	Vertical
0.040in. Alum	6	218	n/a	218	n/a
0.050in. Alum	12	146	n/a	145	n/a
24ga. Steel	6	233	n/a	236	n/a



<b>M-Weld Gravel Stop MB Fascia Type B</b>	TAS 111 (B)	Continuous anchor cleat and exterior fascia.
--	-------------	--

**M-Weld Gravel Stop MB Fascia Type B** - Maximum length 10'. Maximum face width listed below. 24ga. galvanized steel retainer with fascia cover. Installed as noted below:

1. Installed with 1.5" ring shank nails 12" o.c. in two staggered rows on vertical face and one row 12" o.c. on horizontal face.

Material	Max Face Height (in.)	Perimeter Pressure(psf)		Corner Pressure (psf)	
		Horizontal	Vertical	Horizontal	Vertical
0.040in. Alum	5	247	n/a	236	n/a
0.040in. Alum	8	175	n/a	182	n/a
24ga. Steel	5	233	n/a	236	n/a
24ga. Steel	8	160	n/a	163	n/a

2. Installed with 1.5" stainless steel ring shank nails 12" o.c. on top flange and 12" o.c. on retainer face.

Material	Max Face Height (in.)	Perimeter Pressure(psf)		Corner Pressure (psf)	
		Horizontal	Vertical	Horizontal	Vertical
0.040in. Alum	5	305	n/a	307	n/a
24ga. Steel	5	305	n/a	307	n/a

<b>M-Weld Gravel Stop MB Fascia Type G</b>	TAS 111 (B)	Continuous anchor cleat and exterior fascia.
--	-------------	--

**M-Weld Gravel Stop MB Fascia Type G** - Maximum length 10'. Face width listed below. Minimum 24ga. galvanized steel anchor cleat with fascia cover. Installed with 1.5" ring shank nails 12" o.c. staggered pattern on top flange and 12" o.c. on cleat face.

Material	Max Face Height (in.)	Perimeter Pressure(psf)		Corner Pressure (psf)	
		Horizontal	Vertical	Horizontal	Vertical
0.040in. Alum	4	204	n/a	200	n/a
0.040in. Alum	5	247	n/a	236	n/a
0.040in. Alum	8	175	n/a	182	n/a
24ga. Steel	4	175	n/a	163	n/a
24ga. Steel	5	247	n/a	236	n/a
24ga. Steel	8	102	n/a	91	n/a





<b>EverGuard EZ Fascia AR</b>	TAS 111 (B)	Two-part assembly with a rigid formed retainer and a decorative snap-on fascia cover.
-------------------------------	-------------	---

**EverGuard EZ Fascia AR** - Maximum length 10'. Maximum face height listed below. Fascia cover snapped into place over 0.050 aluminum retainers. Installed with 1.5" stainless steel fastener spaced 12" o.c.

Material	Max Face Height (in.)	Perimeter Pressure(psf)		Corner Pressure (psf)	
		Horizontal	Vertical	Horizontal	Vertical
0.040in. Alum	6	218	n/a	218	n/a
0.040in. Alum	6.75	204	n/a	200	n/a
0.040in. Alum	8.25	116	n/a	109	n/a
24ga. Steel	5.25	276	n/a	271	n/a
24ga. Steel	6	218	n/a	218	n/a
24ga. Steel	8.25	160	n/a	163	n/a
0.039in Zinc	6	189	n/a	200	n/a

<b>M-Weld Formed Coping</b>	TAS 111 (C)	Decorative metal fascia with continuous galvanized steel anchor cleat.
-----------------------------	-------------	--

**M-Weld Formed Coping** - Maximum length 10'. Maximum face measurements listed below. Minimum 20ga. continuous galvanized steel cleat with a 0.040" aluminum or 24ga. galvanized steel coping cap. Installed with 1.5" ring shank nails, spaced 12" o.c and 1.5" stainless steel screws @ 12" o.c.

Material	Max Face Height (in.)	Max Wall Width (in.)	Max Back Height (in.)	Perimeter Pressure(psf)		Corner Pressure (psf)	
				Horizontal	Vertical	Horizontal	Vertical
0.040in. Alum	6	16	4	58	101	n/a	n/a
24ga. Steel	10	16	6	102	176	91	190
24ga. Steel	10	24	6	87	151	73	152



<b>M-Weld Formed Coping Plus</b>	TAS 111 (C)	Decorative metal fascia with continuous galvanized steel anchor cleat.
----------------------------------	-------------	--

**M-Weld Formed Coping Plus** - Maximum length 10'. Maximum face measurements listed below. 16ga. continuous galvanized steel cleat with an aluminum or galvanized steel coping cap. Installed with 1.5" ring shank nails, spaced 12" o.c and 1.5" stainless steel screws @ 12" o.c.

Material	Max Face Height (in.)	Max Wall Width (in.)	Max Back Height (in.)	Perimeter Pressure(psf)		Corner Pressure (psf)	
				Horizontal	Vertical	Horizontal	Vertical
0.050in. Alum	6	24	4	116	202	91	190
0.050in. Alum	6	32	4	116	202	91	190
0.080in. Alum	6	16	4	261	453	218	455
22ga. Steel	6	24	4	116	202	91	190
24ga. Steel	6	32	4	87	151	73	152
24ga. Steel	10	32	6	73	126	n/a	n/a

<b>EverGuard EdgeBox RI</b>	TAS 111 (B)	An engineered metal replacement system for roof nailers.
-----------------------------	-------------	--

**EverGuard EdgeBox RI**- Maximum length 10'. 5.5" face width, 4.5" face leg, 4.5" back leg. Minimum 20ga. galvanized steel two-piece unit. Installed to the bottom with #14 Universal fasteners, spaced at 12" o.c. and top secured with #14 HD fasteners spaced at 48" o.c. and #14 Universal fasteners at 12" o.c. through each side of EverGuard EdgeBox RI.

Material	Max Face Height (in.)	Max Wall Width (in.)	Max Back Height (in.)	Perimeter Pressure(psf)		Corner Pressure (psf)	
				Horizontal	Vertical	Horizontal	Vertical
20ga. Steel	4.5	5.5	4.5	523	n/a	434	n/a

<b>M-Weld EZ Fascia EX</b>	TAS 111 (B)	Decorative metal fascia with continuous extruded aluminum bar
----------------------------	-------------	---

**M-Weld EZ Fascia EX** - Maximum length 10'. Maximum face height listed below, minimum 0.050" extruded aluminum retainer bar with snap-on fascia cover. Installed with 1.5" stainless steel hex head screws 12" o.c.

Material	Max Face Height (in.)	Perimeter Pressure(psf)		Corner Pressure (psf)	
		Horizontal	Vertical	Horizontal	Vertical
0.040in. Alum	6.75	204	n/a	200	n/a
0.040in. Alum	8.25	146	n/a	145	n/a
0.040in. Alum	11.25	73	n/a	73	n/a
0.050in. Alum	11.25	116	n/a	127	n/a
24ga. Steel	6.75	247	n/a	253	n/a
24ga. Steel	8.25	160	n/a	163	n/a
24ga. Steel	11.25	87	n/a	91	n/a



<b>M-Weld EZ Fascia EX Extender</b>	TAS 111 (B)	Two-part assembly with an extruded retainer and decorative snap-on fascia cover			
<b>M-Weld EZ Fascia EX Extender</b> - Maximum length 10'. Maximum face height listed below. Minimum 0.050" extruded aluminum or 22ga. continuous steel retainer with fascia cover. Installed with 1.5" stainless steel hex head screws 12" o.c.					
Material	Max Face Height (in.)	Perimeter Pressure(psf)		Corner Pressure (psf)	
		Horizontal	Vertical	Horizontal	Vertical
0.040in. Alum	13	73	n/a	73	n/a
0.050in. Alum	13	102	n/a	91	n/a
24ga. Steel	13	87	n/a	91	n/a

<b>EverGuard Standard Gravel Stop Fascia</b>	TAS 111 (B)	Metal Fascia with continuous galvanized steel water dam, and galvanized steel retainer			
<b>EverGuard Standard Gravel Stop Fascia</b> – Maximum length 10'. Maximum face height 8". Minimum 24ga. galvanized steel cleat with a 24ga. galvanized steel or 0.040 aluminum fascia cover. Installed with 1.5" galvanized ring shank nail at 12" o.c.					
Material	Max Face Height (in.)	Perimeter Pressure(psf)		Corner Pressure (psf)	
		Horizontal	Vertical	Horizontal	Vertical
0.040in. Alum	4	204	n/a	200	n/a
0.040in. Alum	5	247	n/a	236	n/a
0.040in. Alum	8	175	n/a	182	n/a
24ga. Steel	4	175	n/a	163	n/a
24ga. Steel	5	247	n/a	236	n/a
24ga. Steel	8	102	n/a	91	n/a

<b>EverGuard Standard Drip Edge Fascia</b>	TAS 111 (B)	A metal fascia/edge system with a 24ga. continuous anchor cleat.			
<b>EverGuard Standard Drip Edge Fascia</b> – Maximum length 10'. Maximum face height 8.0". 20ga. galvanized steel cleat or 24ga. galvanized steel cleat with fascia cover. Installed with 1.5" stainless steel ring shank at 12" o.c. 2 rows all sizes.					
Material	Max Face Height (in.)	Perimeter Pressure(psf)		Corner Pressure (psf)	
		Horizontal	Vertical	Horizontal	Vertical
0.032in. Alum	5.5	233	n/a	236	n/a
0.040in. Alum	8	189	n/a	182	n/a
24ga. Steel	5.5	218	n/a	218	n/a
24ga. Steel	8	189	n/a	182	n/a



<b>EverGuard Extender</b>	TAS 111 (B)	System used to extend the coverage of continuous water-tight metal systems.			
<b>EverGuard Extender</b> – Maximum length 10'. Maximum face height 8.0". 24ga. galvanized steel cleat with fascia cover. Installed 1.5" stainless steel ring shank at 12" o.c.					
Material	Max Face Height (in.)	Perimeter Pressure(psf)		Corner Pressure (psf)	
		Horizontal	Vertical	Horizontal	Vertical
0.040in. Alum	8	58	n/a	73	n/a
0.050in. Alum	8	102	n/a	91	n/a
24ga. Steel	8	73	n/a	73	n/a

<b>EverGuard Extender with Offset</b>	TAS 111 (B)	System used to extend the coverage of continuous water-tight metal systems			
<b>EverGuard Extender with Offset</b> – Maximum length 10'. Maximum face height 8.0". 24ga. galvanized steel cleat with fascia cover. Installed 1.5" stainless steel ring shank at 12" o.c.					
Material	Max Face Height (in.)	Perimeter Pressure(psf)		Corner Pressure (psf)	
		Horizontal	Vertical	Horizontal	Vertical
0.040in. Alum	8	58	n/a	73	n/a
0.050in. Alum	8	102	n/a	91	n/a
24ga. Steel	8	73	n/a	73	n/a

<b>EverGuard WR Box Gutter</b>	TAS 111 (C)	Gutters fabricated from either aluminum or prefinished steel				
<b>EverGuard WR Box Gutter</b> – Maximum length 10'. Maximum face width 7 ¾", 6" face leg. 0.050 aluminum or 24ga. galvanized steel gutter and 1" wide two-piece extruded aluminum gutter bracket. Installed 1.5" universal fasteners at 24" o.c.						
Material	Max Face Height (in.)	Max Top Width (in.)	Perimeter Pressure(psf)		Corner Pressure (psf)	
			Horizontal	Vertical	Horizontal	Vertical
0.040in. Alum	6	7.75	87	151	109	228
24ga. Steel	6	7.75	87	151	109	228

<b>EverGuard WR Offset Gutter</b>	TAS 111 (C)	Gutters fabricated from either aluminum or prefinished steel.				
<b>EverGuard WR Offset Gutter</b> – Maximum length 10'. Maximum face width 7 ¾", 6" face leg. 0.050 aluminum or 24ga. galvanized steel gutter and 1" wide two-piece extruded aluminum gutter bracket. Installed 1.5" universal fasteners at 24" o.c.						
Material	Max Face Height (in.)	Max Top Width (in.)	Perimeter Pressure(psf)		Corner Pressure (psf)	
			Horizontal	Vertical	Horizontal	Vertical
0.040in. Alum	6	7.75	87	151	109	228
24ga. Steel	6	7.75	87	151	109	228



<b>EverGuard WR Chamfer Gutter</b>		TAS 111 (C)		Gutters fabricated from either aluminum or prefinished steel			
<b>EverGuard WR Chamfer Gutter</b> – Maximum length 10'. Maximum face width 7 ¾", 6" face leg. 0.050 aluminum or 24ga. galvanized steel gutter and 1" wide two-piece extruded aluminum gutter bracket. Installed 1.5" universal fasteners at 24" o.c.							
Material	Max Face Height (in.)	Max Top Width (in.)	Perimeter Pressure(psf)		Corner Pressure (psf)		
			Horizontal	Vertical	Horizontal	Vertical	
0.040in. Alum	6	7.75	87	151	109	228	
24ga. Steel	6	7.75	87	151	109	228	

**LIMITATIONS:**

1. All products listed herein shall be installed in accordance with the requirements set forth in RAS 111.
2. Maximum dimensions shall be as outlined in Detail Drawings herein.
3. All products listed herein shall be installed in conjunction with GAF’s required accessories including but not limited to: miters, splice caps, splice plates, corners, end caps, pier caps, etc.
4. Downspout scuppers and spill out scuppers shall be fabricated and installed in accordance with RAS 111.
5. If required, install water cut-off as recommended by the membrane manufacturer and under the anchor bar.
6. Contractor shall check as-built conditions and verify roof edge details for accuracy to fit as built conditions prior to installation. Installer shall comply with GAF’s published installation requirements.
7. Fasteners shall be GAF’s approved fasteners.
8. Fasteners shall provide a minimum pull out resistance of 240lbf (109 kg) into the substrate being fastened into. When tested in accordance with TAS 105.
9. No exposed fasteners shall be permitted.
10. All fasteners shall be of compatible materials
11. Finishes shall be natural aluminum mill finish, or pre-coated Kynar 500. All coatings shall be in compliance with the Florida Building Code (FBC).
12. The maximum design pressures listed herein are applicable to the perimeter areas of the roof. Increased design pressures for corner areas, in compliance with applicable building code may be met through rational analysis by increasing the number of attachment points in these areas. The maximum fastener spacing noted in the “Systems Description” section of this approval shall not be exceeded. All rational analysis computations shall be prepared, signed and sealed by a Florida Registered Professional Engineer, Registered Architect, or Registered Roof Consultant.
13. All products listed herein shall have a quality assurance audit in accordance with the Florida Building Code and Rule 61G20-3 of the Florida Administrative Code.
14. All approved products listed herein shall be labeled and shall bear the imprint or identifiable marking of the manufacturer's name or logo, city, state and following statement: "Miami-Dade County Product Control Approved" or the Miami-Dade County Product Control Seal as shown below.



## M-Weld Snap-On Coping

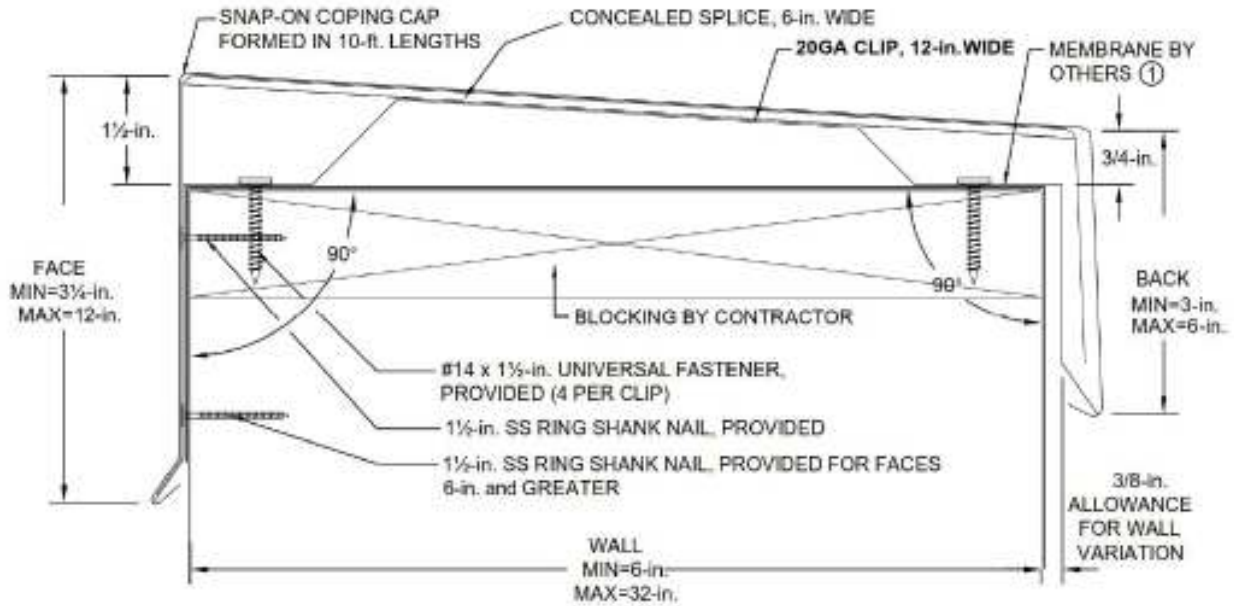

① Contact manufacturer for coping design on walls outside these parameters.

## M-Weld Snap-On Coping Plus

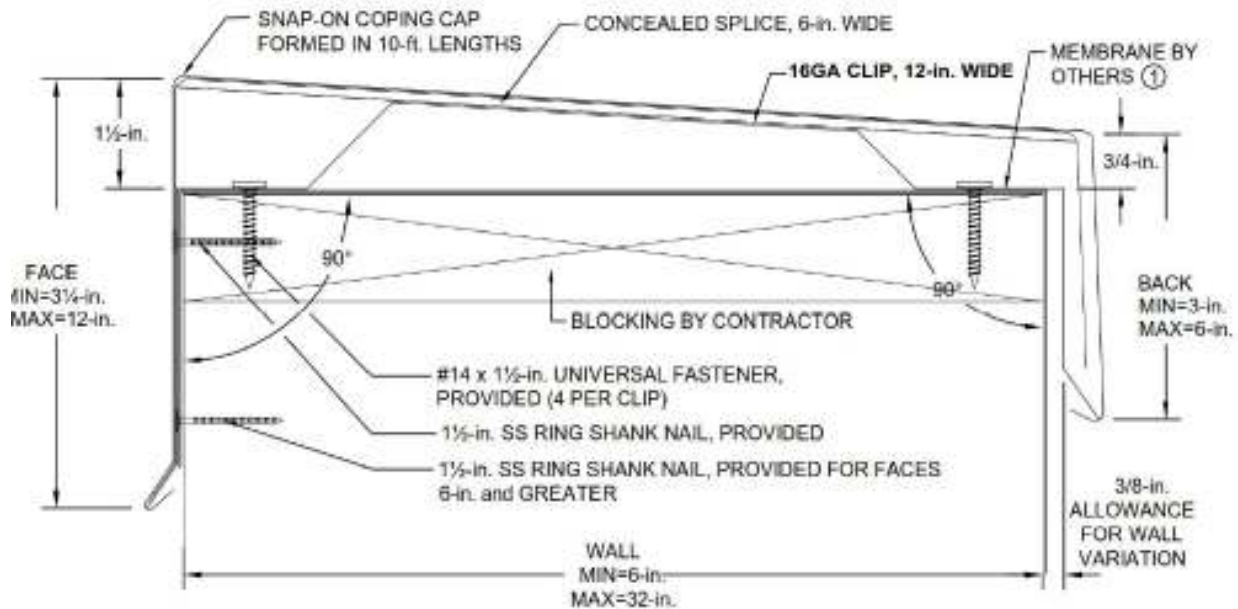

① Contact manufacturer for coping design on walls outside these parameters.

### EverGuard EZ Fascia EX

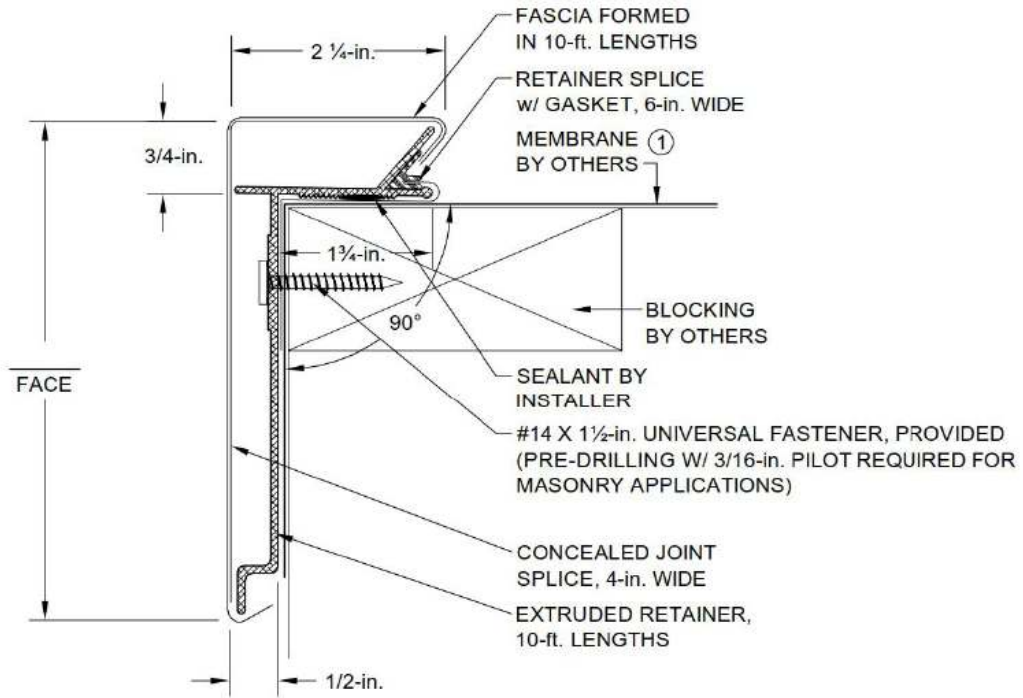

① Coordinate installation with membrane manufacturer.



## EverGuard EZ Fascia EX Extender

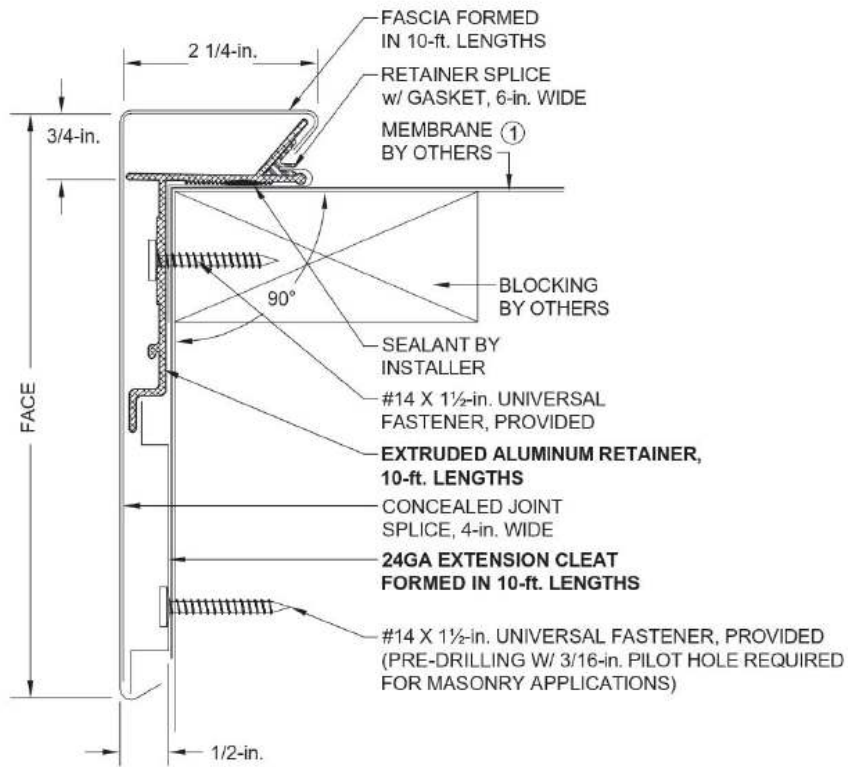

① Coordinate installation with membrane manufacturer.





## EverGuard EZ Fascia

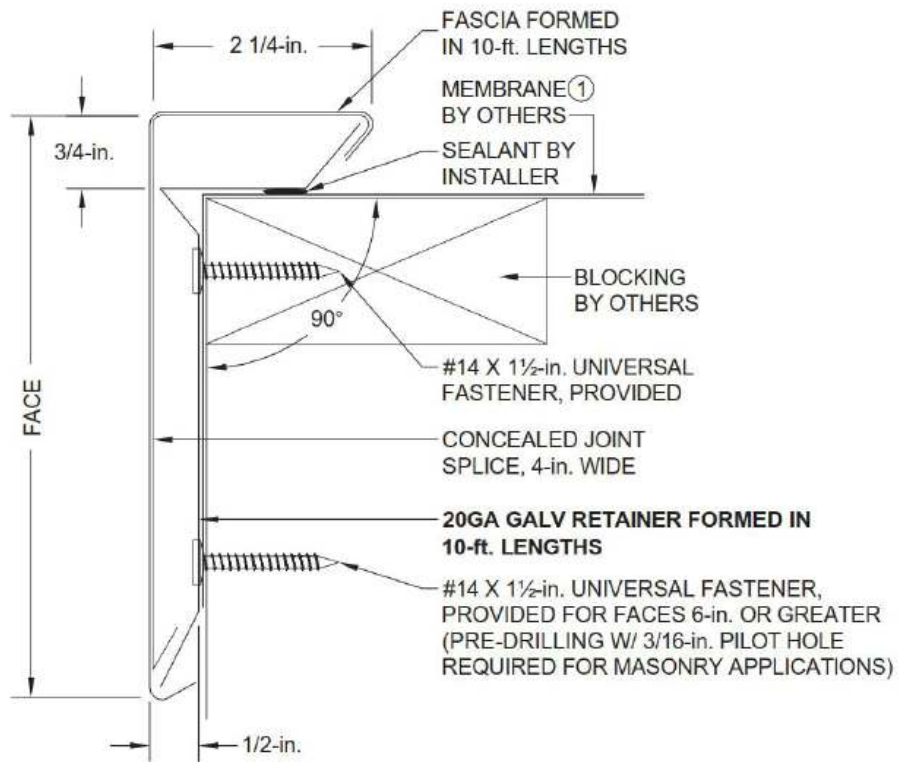

① Coordinate installation with membrane manufacturer.



## EverGuard Snap-On Fascia

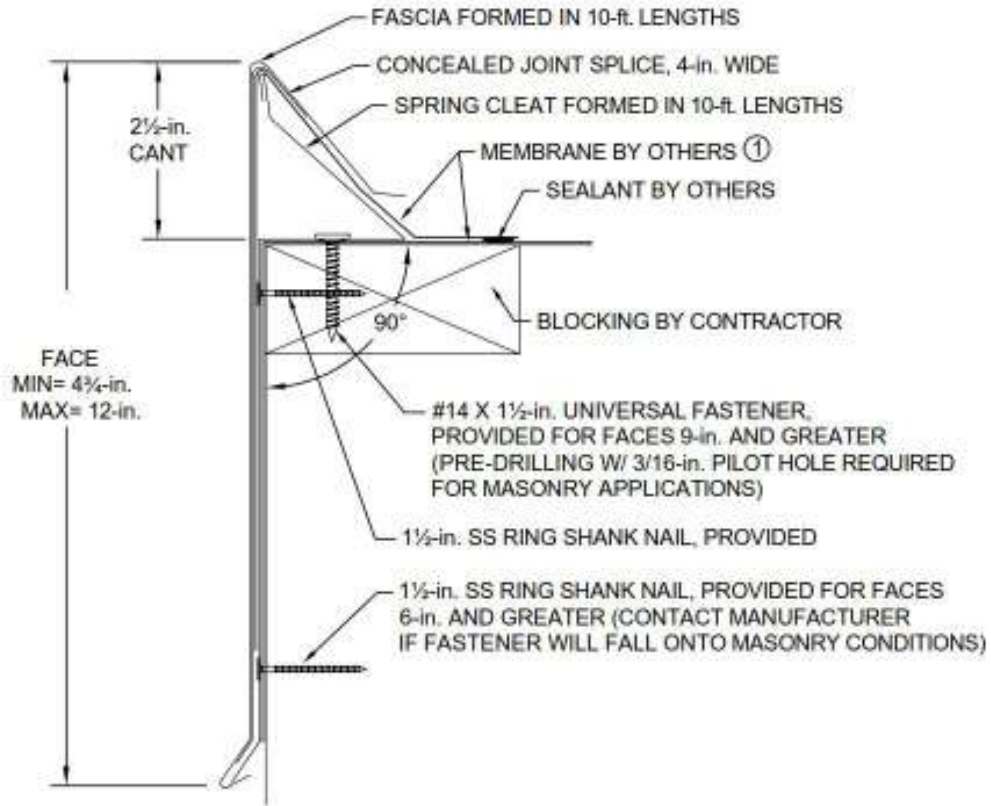

① Coordinate installation with membrane manufacturer. (Maximum thickness = 0.060 EPDM)



### M-Weld NP Fascia

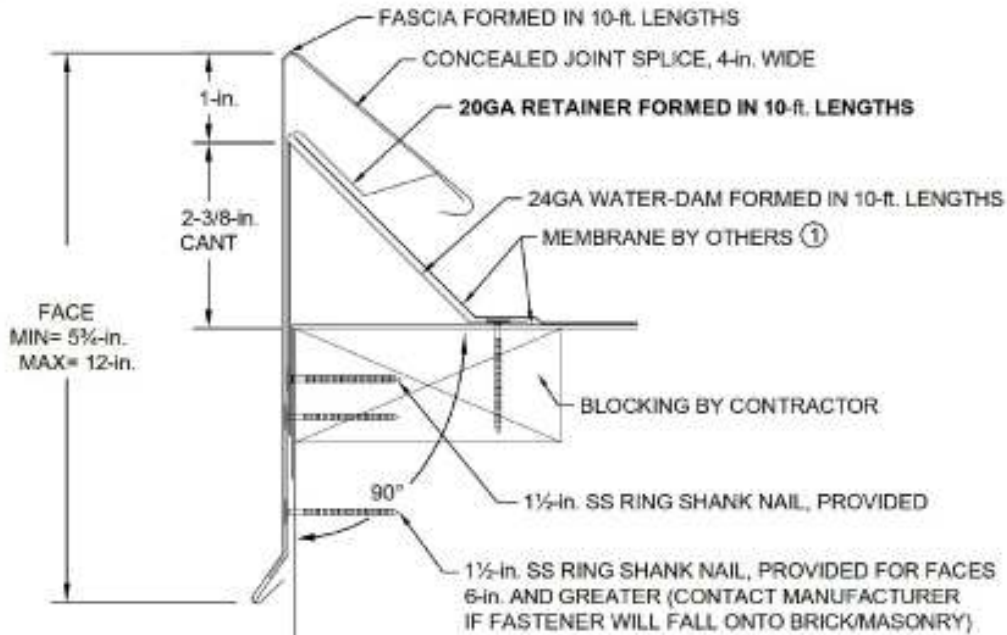

① Coordinate installation with membrane manufacturer.

### M-Weld Gravel Stop MB Fascia Type B

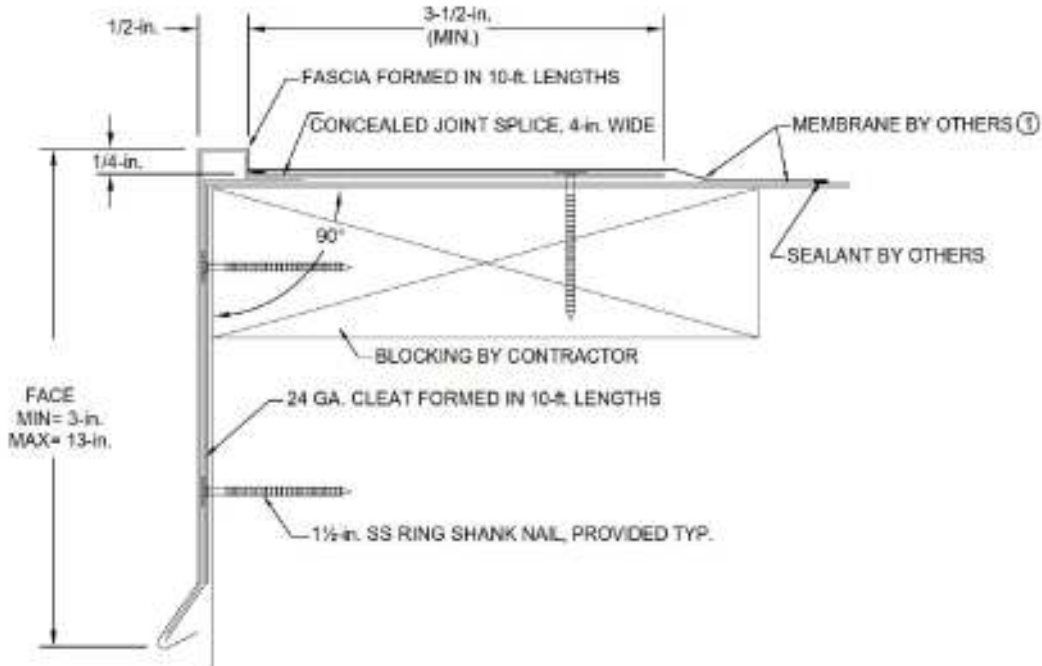

① Coordinate installation with membrane manufacturer.



### M-Weld Gravel Stop MB Fascia Type G

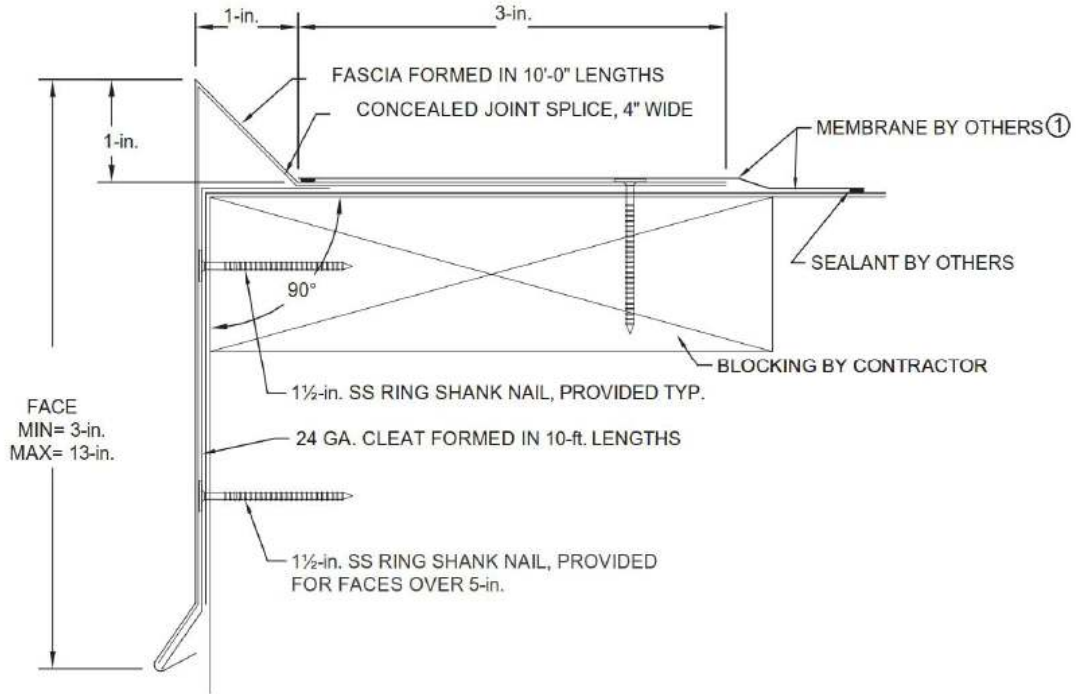

① Coordinate installation with membrane manufacturer.



### EverGuard EZ Fascia AR

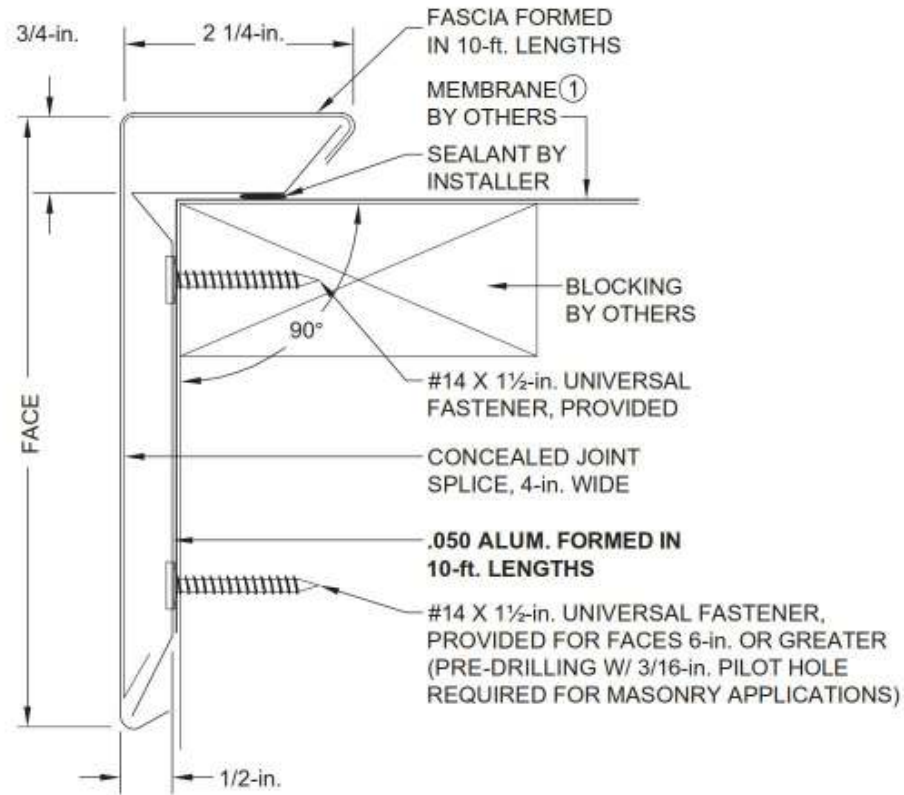

① Coordinate installation with membrane manufacturer.



### M-Weld Formed Coping

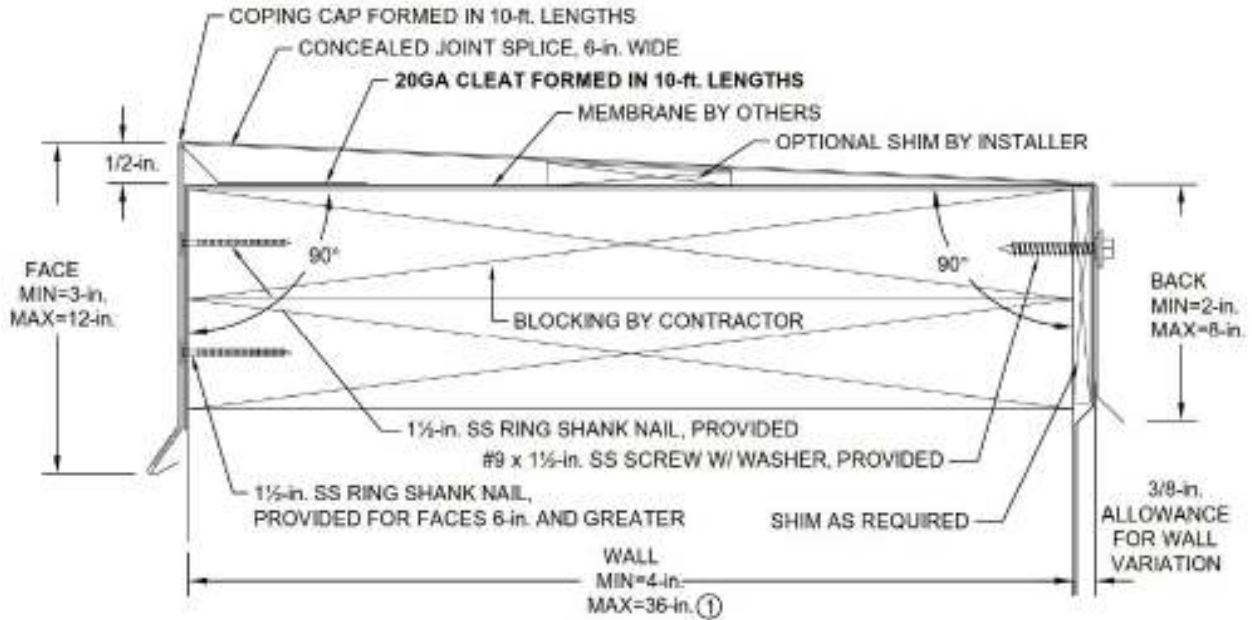

① Contact manufacturer for coping design on walls outside these parameters.

### M-Weld Formed Coping Plus

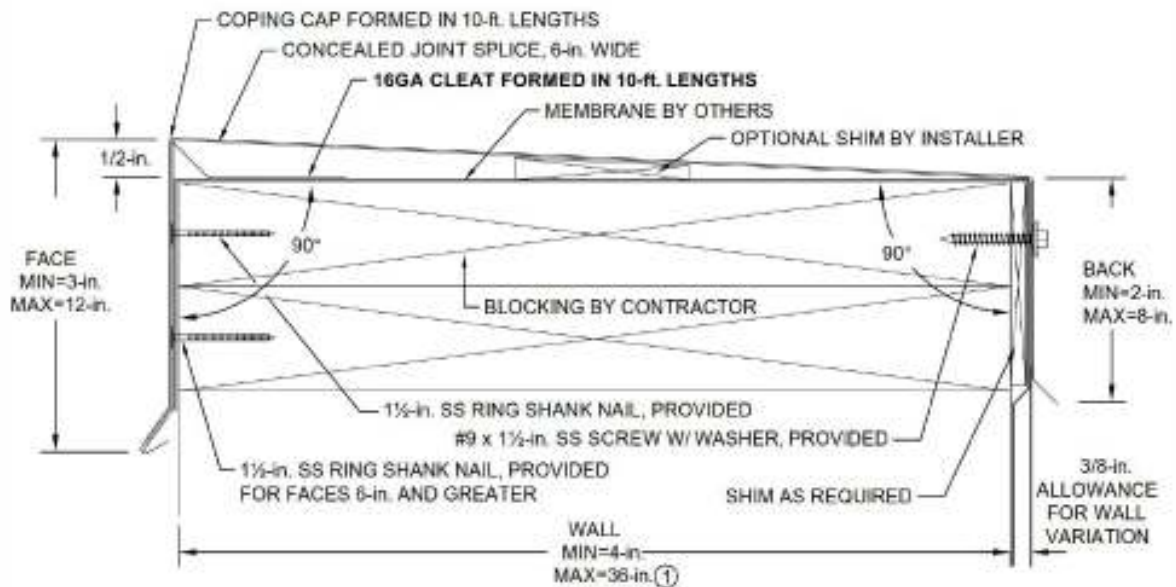

① Contact manufacturer for coping design on walls outside these parameters.



## EverGuard EdgeBox RI

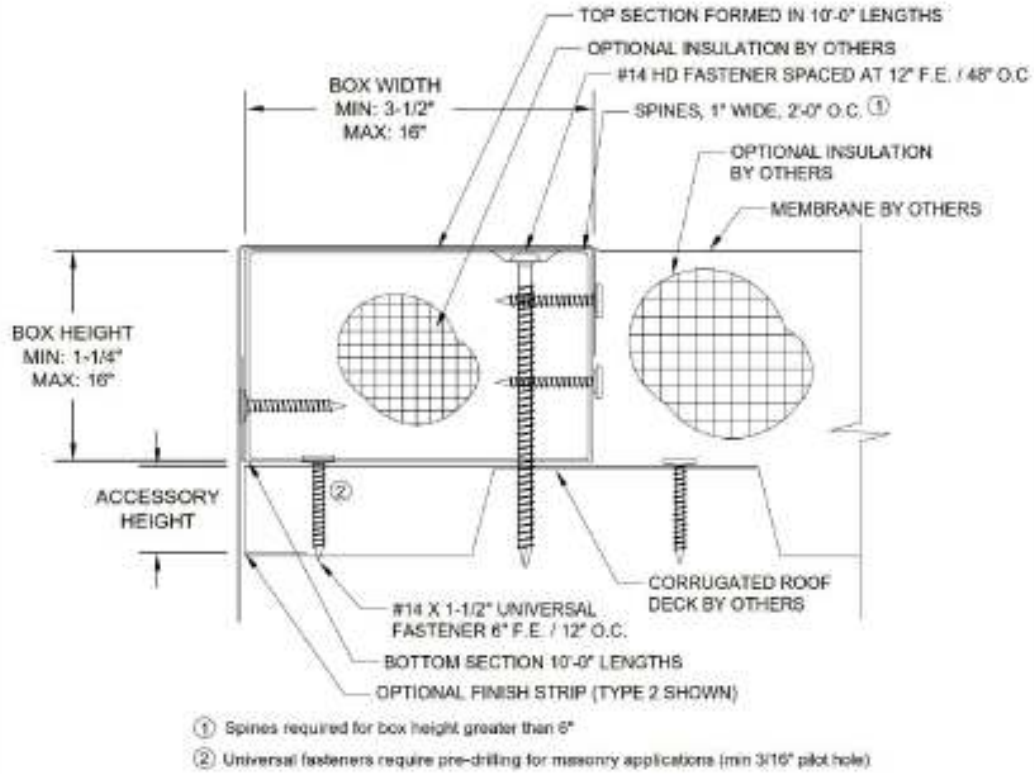

**M-Weld EZ Fascia EX**

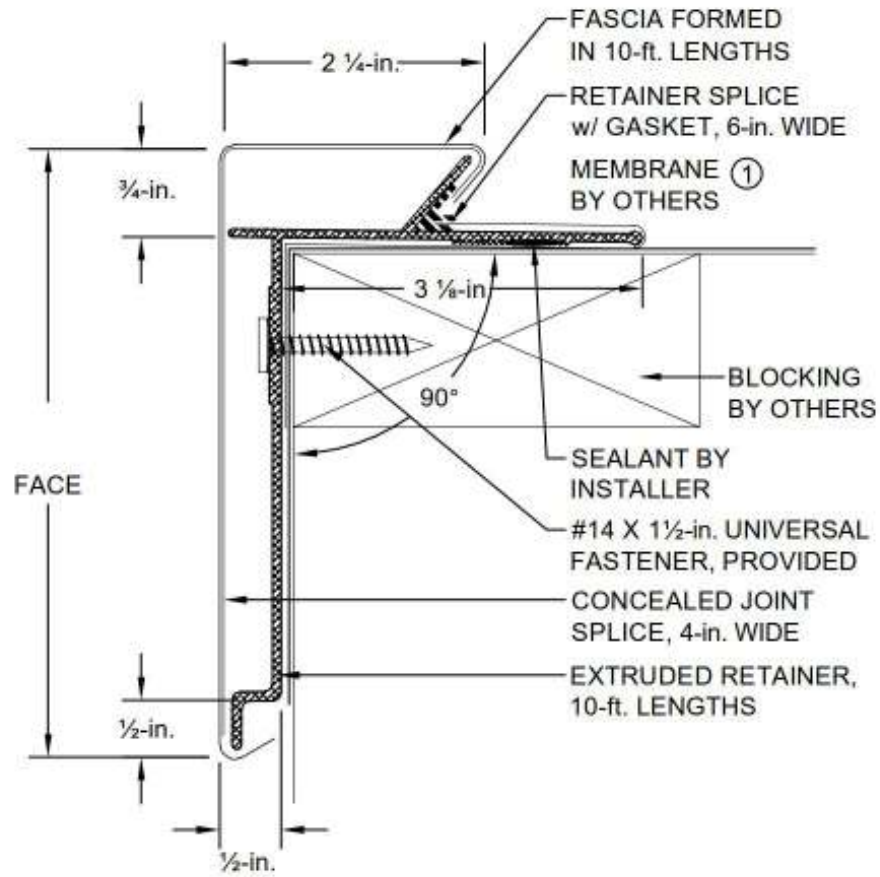

① Coordinate installation with membrane manufacturer.



### M-Weld EZ Fascia EX Extender

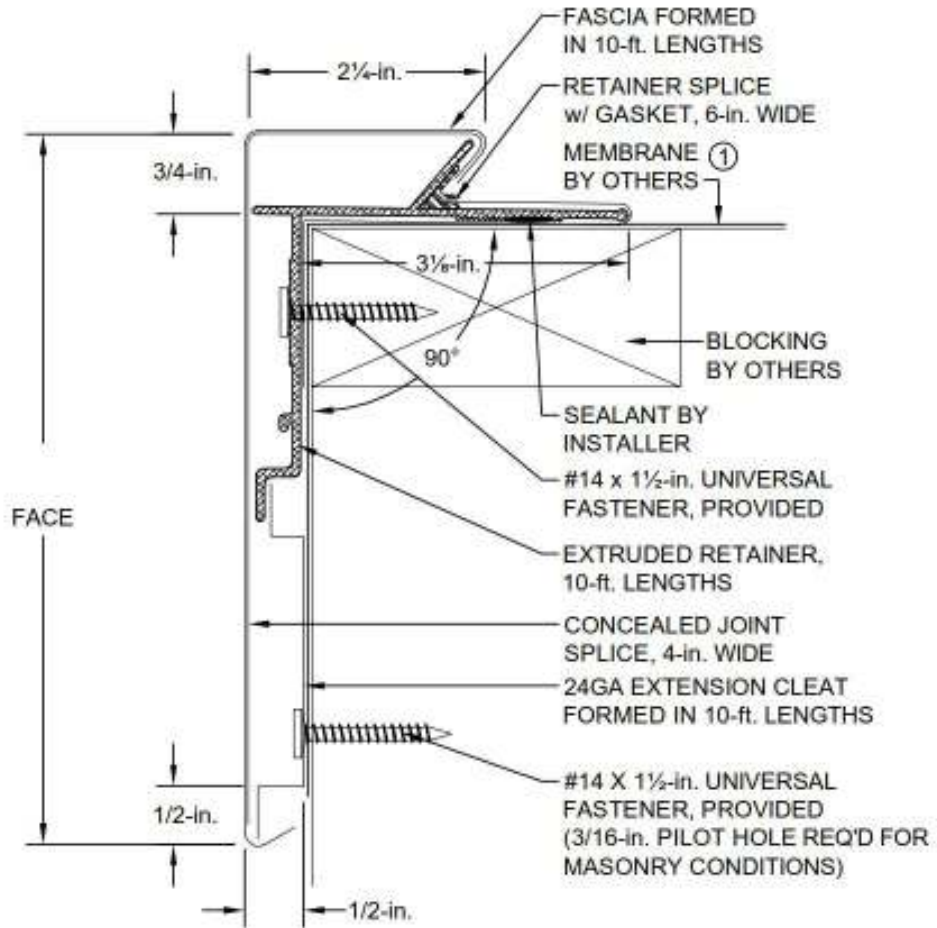

① Coordinate installation with membrane manufacturer.

### EverGuard Standard Gravel Stop Fascia

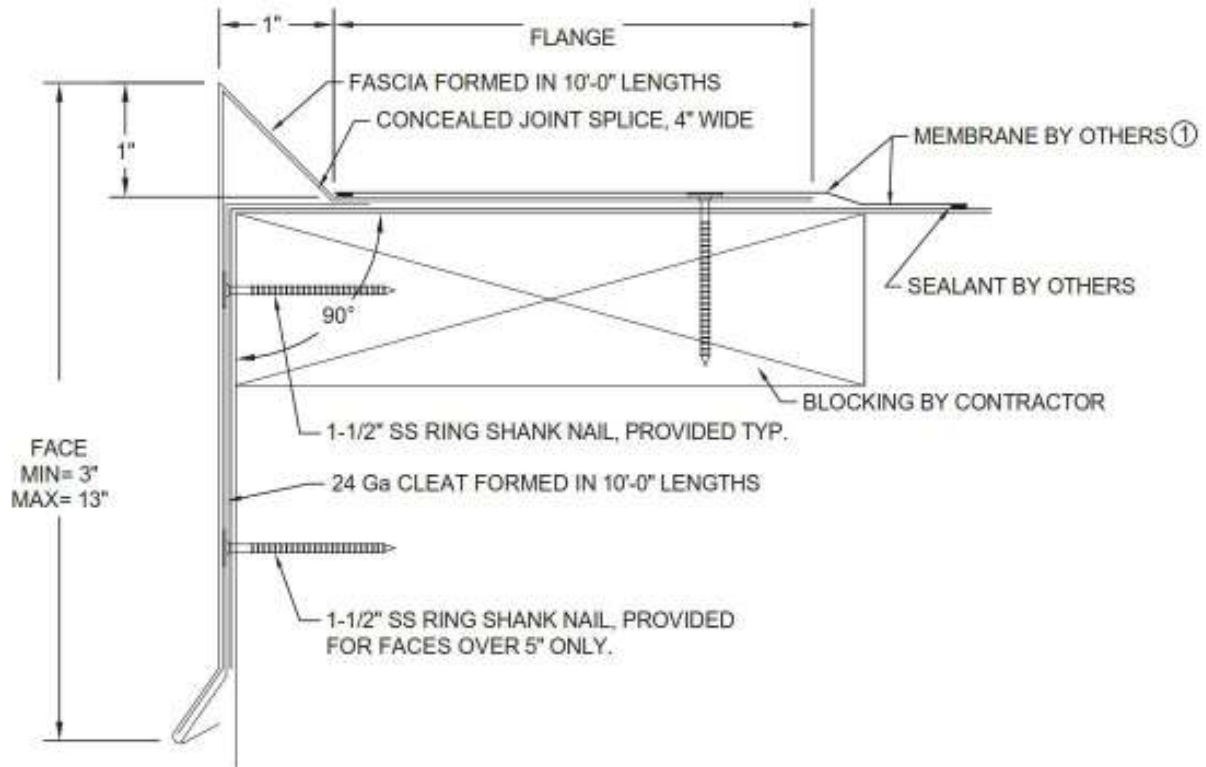

① Coordinate installation with membrane manufacturer.

### EverGuard Standard Drip Edge Fascia

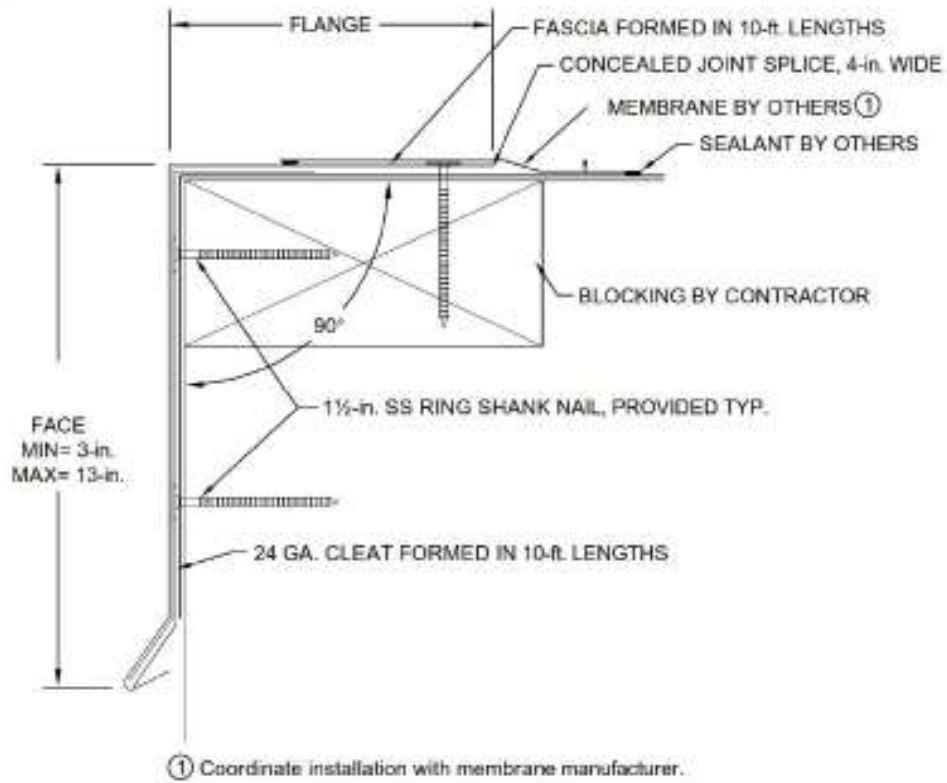

### EverGuard Extender

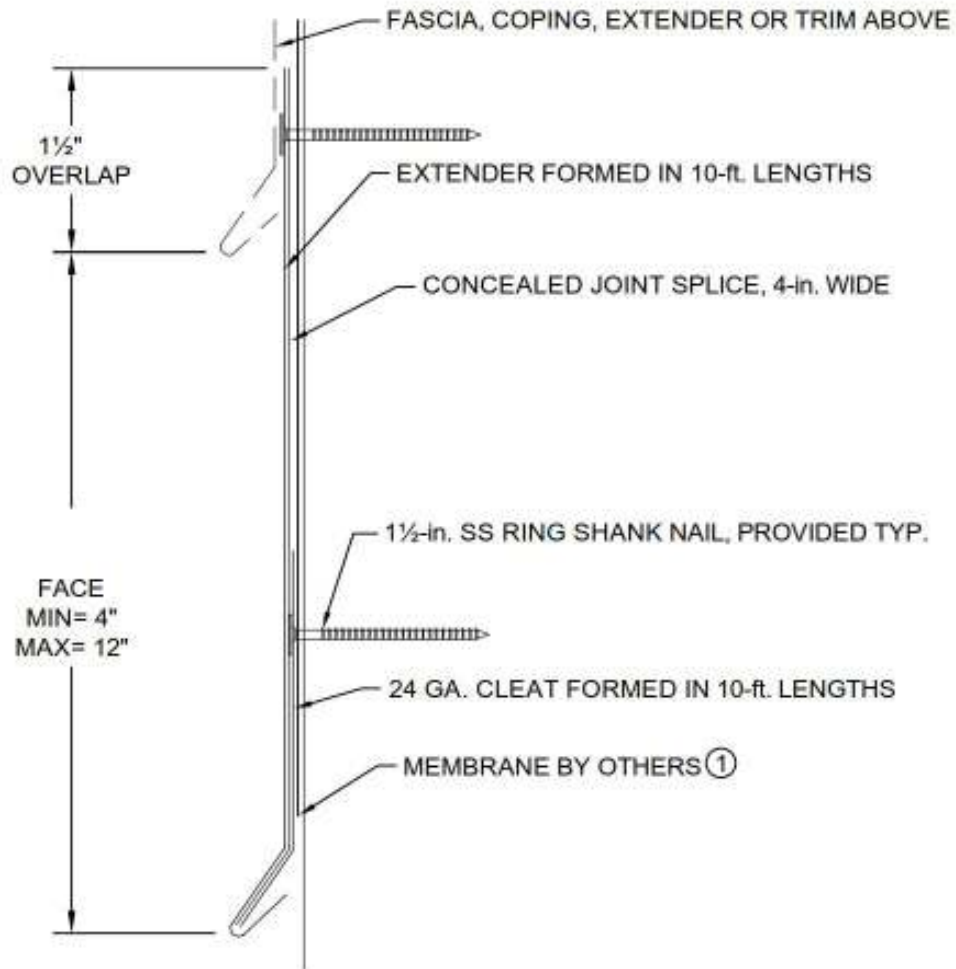

① Coordinate installation with membrane manufacturer.

### EverGuard Extender with Offset

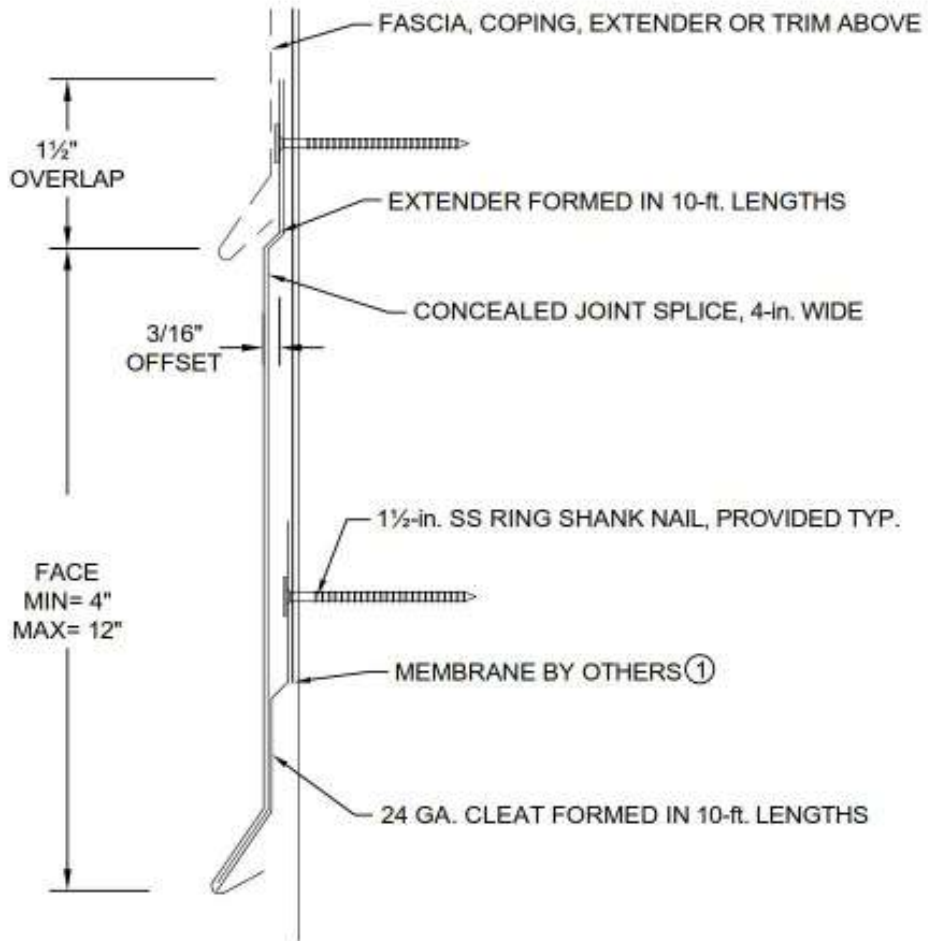

① Coordinate installation with membrane manufacturer.

### EverGuard WR Box Gutter

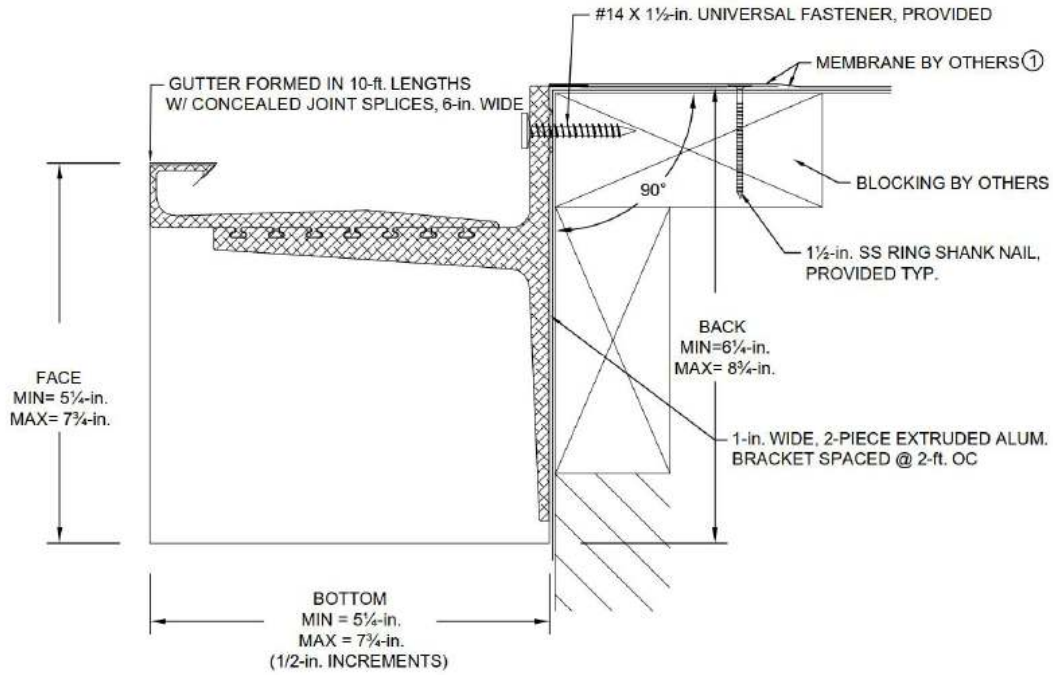

① Coordinate installation with membrane manufacturer.

### EverGuard WR Offset Gutter

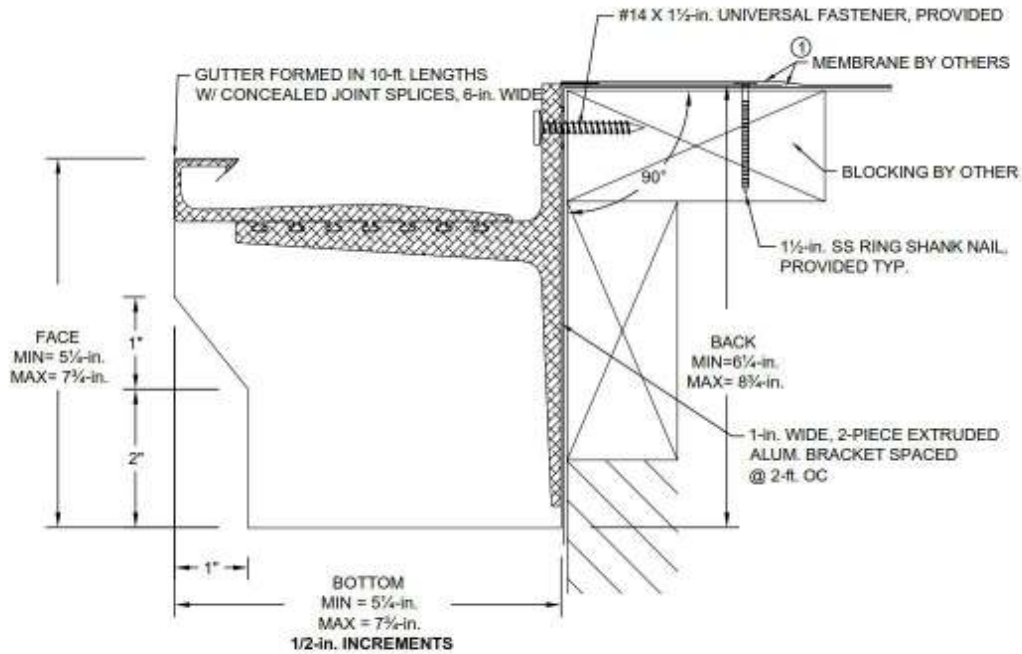

① Coordinate installation with membrane manufacturer.

EverGuard WR Chamfer Gutter

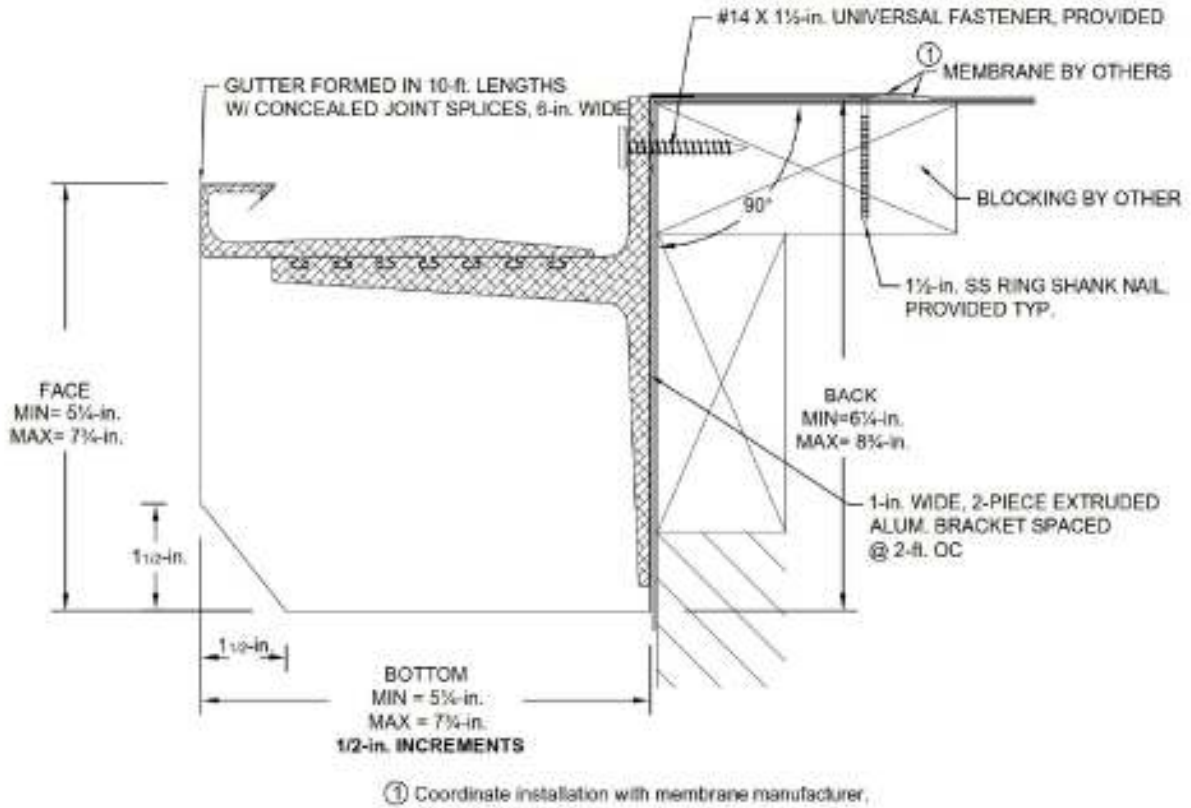

**END OF THIS ACCEPTANCE**

