



# FrictionCoat Aggregate System

Product Data Sheet



## PRODUCT DESCRIPTION

StreetBond® FrictionCoat Aggregate System is not a coating, but rather a specially formulated aggregate system. The system includes high-PSV (Polished Stone Value), angular, 1.0 to 1.5mm calcined bauxite aggregates bound by a quick-setting polymer-modified cement. Rheology modifiers and curing agents facilitate the creation of a strong, highly textured surface. Included as friction layer in conjunction with StreetBond® SB150, StreetBond® FrictionCoat Aggregate System is an integral part of the StreetBond® Premium System which creates a highly durable and skid resistant coating.

## WARRANTY

See applicable warranties and guarantees for complete coverage and restrictions.

## PACKAGING & SHELF LIFE

One unit of StreetBond® FrictionCoat Aggregate System consists of:

One 1 gallon (3.8 liter) jug of StreetBond® Friction-Coat Aggregate System Resin

One 34.4 lb (15.6 kg) bag of Dry Hardener and Street-Bond® FrictionCoat Aggregate System Aggregate Supplement

**Note:** One (1) unit of colorant (sold separately) is required for each unit of StreetBond® FrictionCoat Aggregate System.

Shelf life 24 months if unopened containers stored between 40°F and 90°F (4°C and 32°C).

## BASIC USES & ADVANTAGES

The viscosity of the StreetBond® FrictionCoat Aggregate System material allows the applicator to create a splatter of encapsulated aggregates. These concrete "islands" of encapsulated aggregate produce high points that support vehicular traffic and significantly increase the durability of the StreetBond® Premium System compared with Street-Bond® coatings alone.

StreetBond® FrictionCoat Aggregate System makes up the second layer (Friction) of the StreetBond® Premium System between the foundation and the 2 finish layers of StreetBond® SB150.

### Basic Uses:

- Friction layer of the StreetBond® Premium System for higher traffic volume situations and higher speed turning areas
- Can be used on concrete with proper surface preparation (see Substrate Guide).

## PRODUCT CHARACTERISTICS

STREETBOND® FRICTIONCOAT	
Weight	35 lbs.
Application Temperature	+ 50°F to 105°F (Ambient) (10°C to 40°C)

StreetBond® Colorant Colors	See GAF.com for colors
-----------------------------	------------------------

## APPLICATION INSTRUCTIONS

**Mixing:** Add StreetBond® FrictionCoat Aggregate System resin into a clean 5 gal (19L) pail along with a unit of Colorant, mix for 30 seconds then add StreetBond® FrictionCoat Aggregate System supplement slowly to the pail while mixing, continuing to mix another 3 minutes.

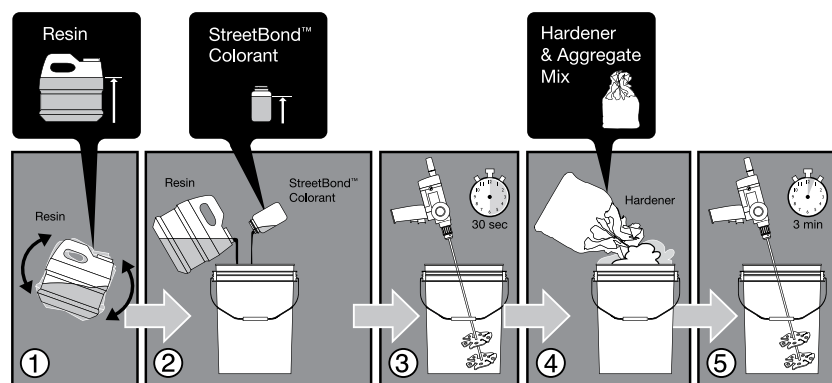

All mixed product must be used within 45 minutes.

**Surface Preparation:** Dirt, debris, water and contaminants sitting on the surface will affect adhesion. You must thoroughly clean the surface using a broom and backpack blower or in severe situations, a power washer. Areas containing chemical contaminants such as vehicle fluids need to be treated using an environmentally friendly degreasing solution. Proper removal of contaminants and degreasing solution is necessary. Care should be taken to ensure that the substrate is dry before applying the coating.

Foundation layer of StreetBond® SB150 must be dry before StreetBond® FrictionCoat Aggregate System can be applied.

**Recommended Application:** Add mixed coating to a modified Graco Hand Held Hopper or equivalent that can shoot straight down using a 90° flexible 1½" elbow and a short length of 1½" pipe (extra parts may be required). Use an 8mm (gray) nozzle with the air pressure set between 8-12psi (0.5 to 0.8 bar) to get the desired splatter. Apply

GAF Liquid-Applied

January 2016, supercedes December 2014

For technical, system, and warranty information, visit [gaf.com](http://gaf.com) or call 1-800-766-3411.

continued on back



# FrictionCoat Aggregate System

Product Data Sheet

## APPLICATION INSTRUCTIONS, CONT'D

in a circular pattern 16-20 inches (40 to 50cm) above the ground. Work along the ground slowly to get consistent texture. Large aggregate should be completely imbedded in the coatings.

If the large aggregate is not surrounded by coating reduce air pressure to avoid separation and create a large build. You may need to adjust the air slightly as the hopper empties to maintain texture. Applied as a single layer, the approximate coverage rate is 300 ft<sup>2</sup> per unit (about 28 m<sup>2</sup> per unit).

Allow coating to dry throughout and be stable enough to walk on before applying the final two finish layers of regular StreetBond® SB150. Friction layer will take longer to dry due to its thickness.

Coating must be allowed to cure before introducing traffic. Cure times vary based on climate conditions, but tend to be within 8-24 hours. For more information, consult the StreetBond® Premium System Product Data Sheet.

### Recommended Premium System Application Coverage Rates:

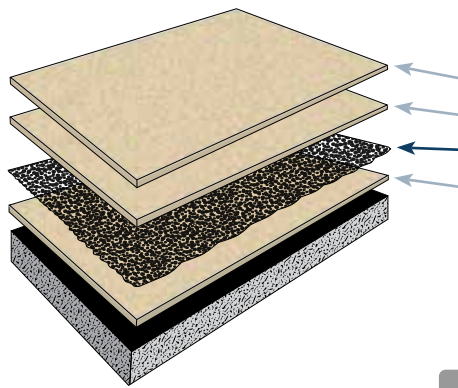

Layer	Coverage rate per unit*	
	ft <sup>2</sup>	m <sup>2</sup>
Finish Coat - Layer 2 (StreetBond® SB150)	600	55.74
Finish Coat - Layer 1 (StreetBond® SB150)	600	55.74
<b>StreetBond® FrictionCoat Aggregate System</b>	<b>300</b>	<b>27.8</b>
Foundation Coat (StreetBond® SB150)	300-400	27.8-37.1

\*Approximations based on flat and textured surfaces. Porosity of mix design affects coverage rates.

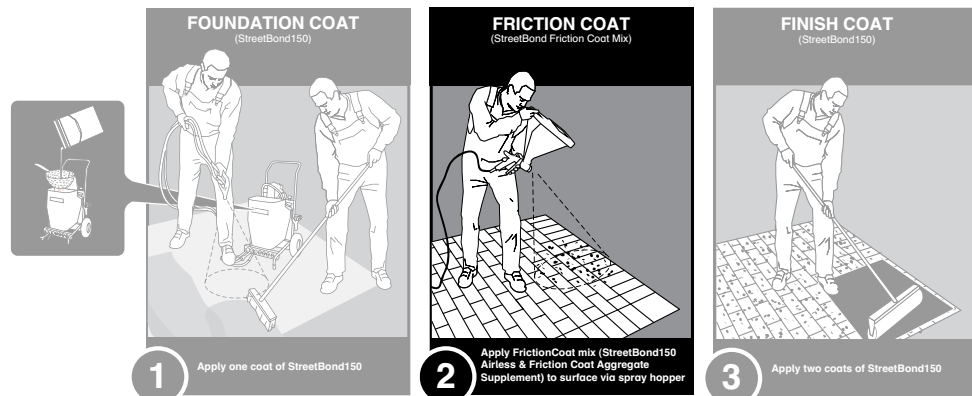

## LIMITATIONS & PRECAUTIONS

The material will set up quickly if left mixed in a pail. Mix only what will be used immediately. StreetBond® **FrictionCoat** Aggregate System is not designed to be used on its own, only in conjunction with materials outlined above. Do not walk on the StreetBond® **FrictionCoat** Aggregate

System layer until it is stable. Opening traffic to the project too early can cause premature loss of aggregate resulting in poor performance. No precipitation should be expected within 24 hours.

## CLEAN UP

Thoroughly rinse application equipment with clean water before product sets, especially inside the hopper gun chamber.

## SAFETY & HANDLING

For specific information regarding safe handling of this material please refer to the Safety Data Sheet (SDS).

### GAF

1 Campus Drive  
Parsippany, NJ 07054  
1-800-ROOF-411  
gaf.com

See applicable warranties and guarantees for complete coverage and restrictions.