

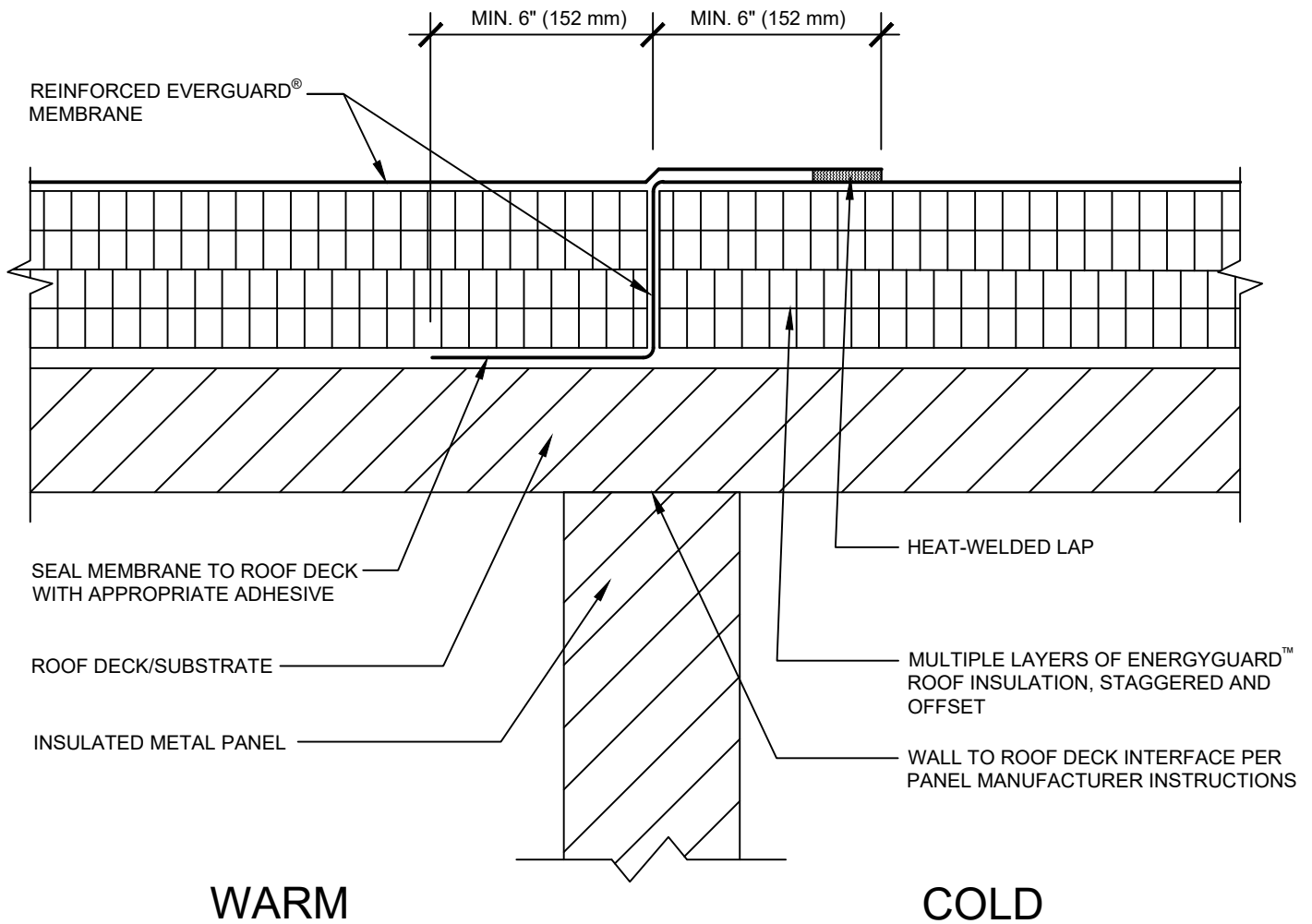

**SINGLE-PLY: TPO & PVC 60-80 mil membranes**



**NOTE:**

1. FOR STEEL ROOF DECKS: FILL STEEL DECK FLUTES WITH SPRAY FOAM INSULATION PRIOR TO THE INSTALLATION OF ABOVE DECK INSULATION A MINIMUM OF 12 INCHES (305 mm) FROM FACE OF WALL ON EACH SIDE, BOTH SIDES OF WALL.
2. AIR SEAL WALL-TO-ROOF DECK INTERFACE PER ARCHITECTURAL DRAWINGS.



**COLD TO WARM TRANSITION TIE-IN WITH WALL BELOW ROOF DECK**

DRAWING #  
**130C**

THIS DETAIL APPLIES TO:  
ADHERED SYSTEMS  
MECHANICALLY ATTACHED SYSTEMS  
RHINOBOND® SYSTEMS

ISSUE / REVISION DATE  
**3/1/21**

SCALE  
N.T.S.

**LEGEND**

- HEAT-WELDED
- EVERGUARD® BONDING ADHESIVE