

**20-YEAR MAX
WARRANTY**

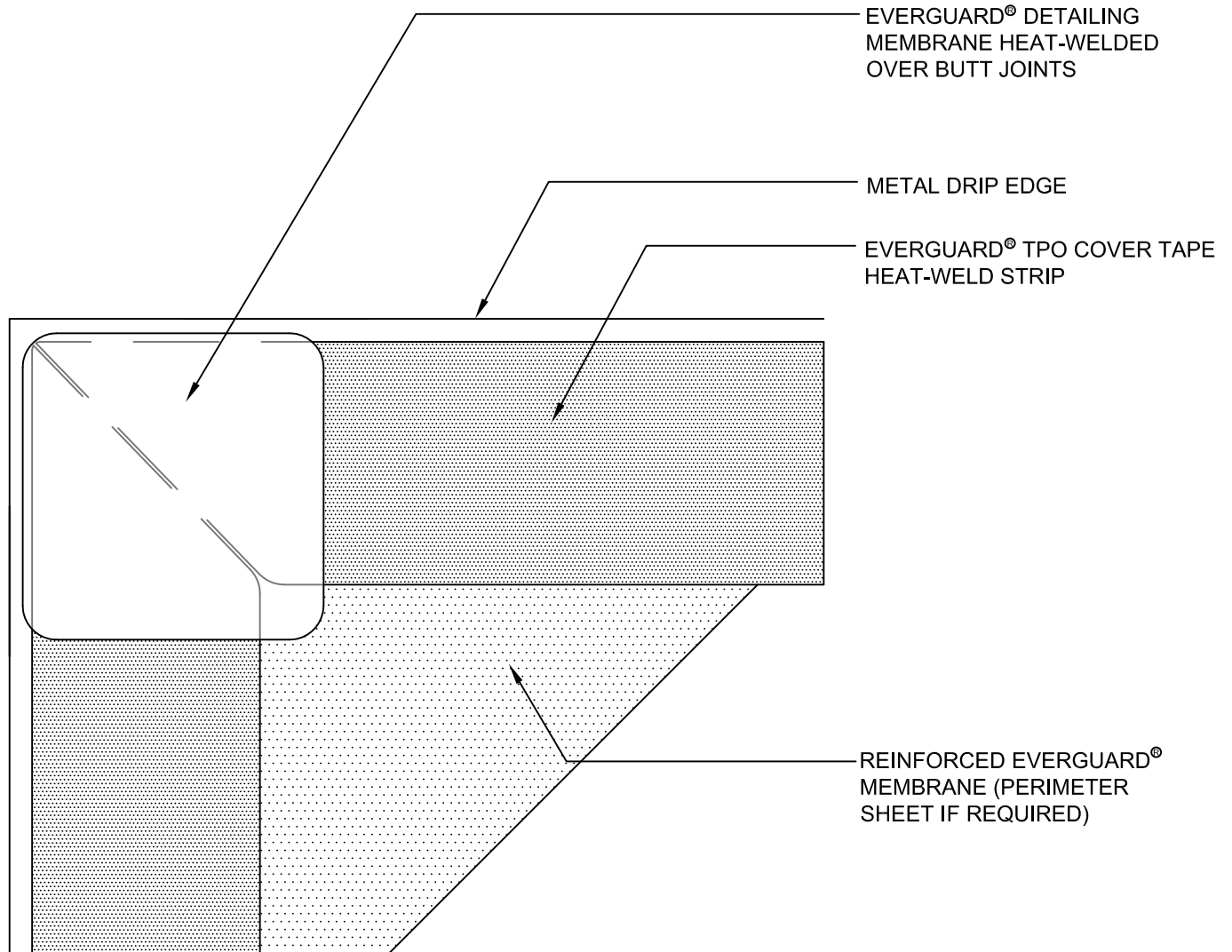

NOTE:

1. EVERGUARD® TPO COVER TAPE HEAT-WELD STRIP ONLY TO BE USED WITH TPO MEMBRANE SYSTEMS ONLY.
2. PRIME THE METAL ONLY WITH EVERGUARD TPO PRIMER. DO NOT SPILL PRIMER ON WELDED SEAM AREA.
3. HEAT WELD THE MEMBRANE (NON-ADHESIVE SIDE ONLY) TO MEMBRANE AREA USING EITHER A ROBOTIC OR HAND WELDER TO SPEC.
4. REFER TO DETAIL 218 FOR EVERGUARD® COVER TAPE HEATWELD ROOF EDGE INSTALLATION.



EverGuard
SINGLE-PLY ROOFING SYSTEMS
ROOF EDGE SERIES

DRAWING #

221

**TPO COVER TAPE HEAT-WELD AT
METAL DRIP EDGE CORNER DETAIL**

THIS DETAIL APPLIES TO:
Adhered Systems
Mechanically Attached Systems
Self-Adhered Systems
TriPosite Systems

www.gaf.com
1 Campus Drive,
Parsippany, NJ 07054

SCALE
N.T.S.

REVISION DATE
8-3-16