

MAXIMUM ROOF
SLOPE 3:12

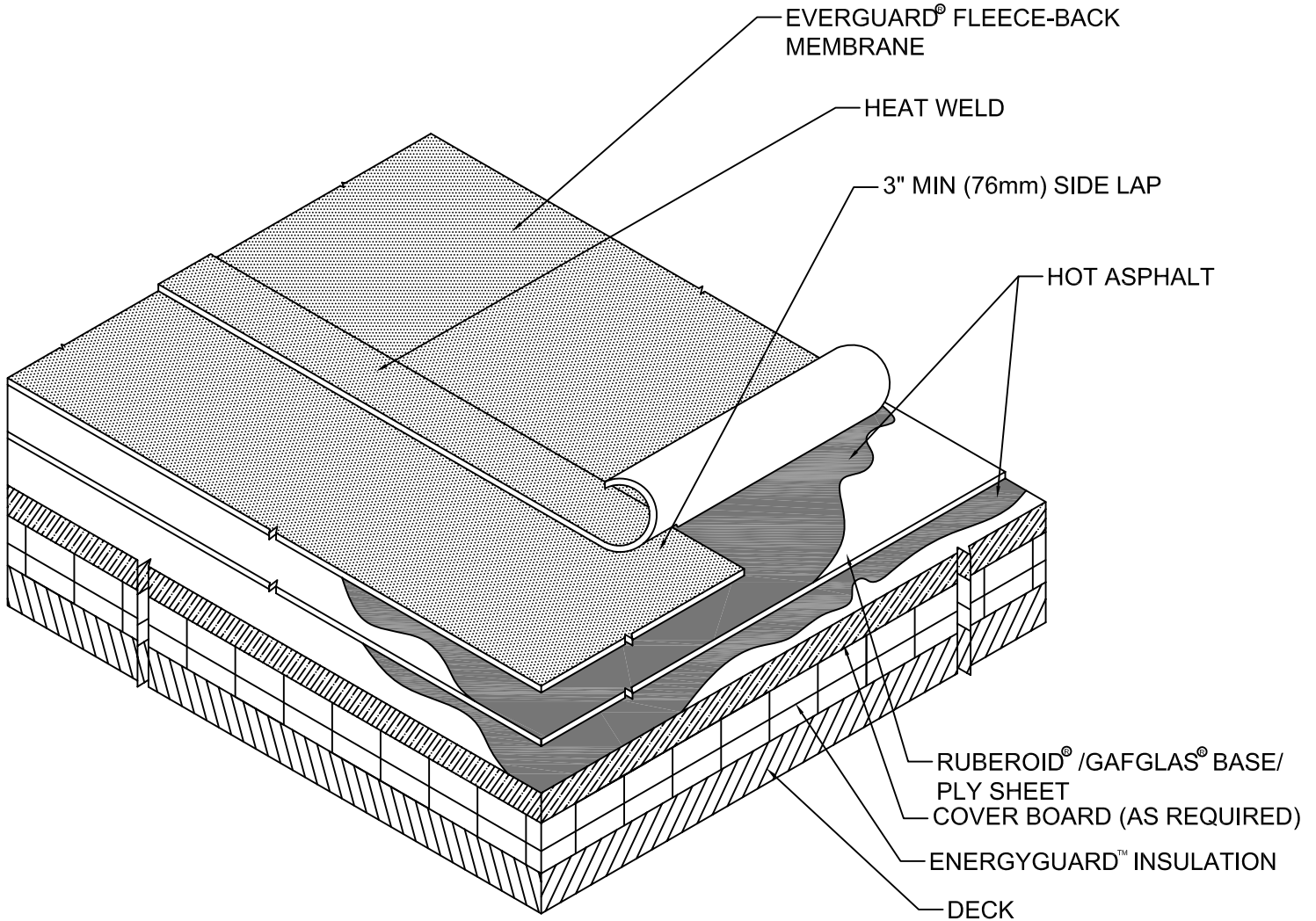

NOTE:

1. FOR SLOPES LESS THAN 1/2:12, TYPE III OR IV ASPHALT CAN BE USED. TYPE IV MUST BE USED ON ALL SLOPES 1/2:12 AND OVER.
2. ASPHALT SHALL BE APPLIED AT ITS EVT TEMPERATURE TO OBTAIN A PROPER BOND, TYPICALLY WITHIN THE RANGE OF 425°F (218°C) TO 475°F (246°C), IN A UNIFORM LAYER, WITHOUT VOIDS, AT A RATE OF 25 LB (11.3kg) PER SQUARE (9.2sq. m) ±20%
3. RUN SHEETS PERPENDICULAR WITH GUTTER



www.gaf.com
1 Campus Drive,
Parsippany, NJ 07054



DRAWING #
100D
SCALE
N.T.S.

TRIPOSITE SYSTEM DETAIL

THIS DETAIL APPLIES TO:
TRIPOSITE
SYSTEMS

REVISION DATE
6-1-16