

SINGLE-PLY: TPO & PVC 60-80 mil membranes

ALTERNATE INSTALLATION
[12" (305 mm) OR MORE OF INSULATION]

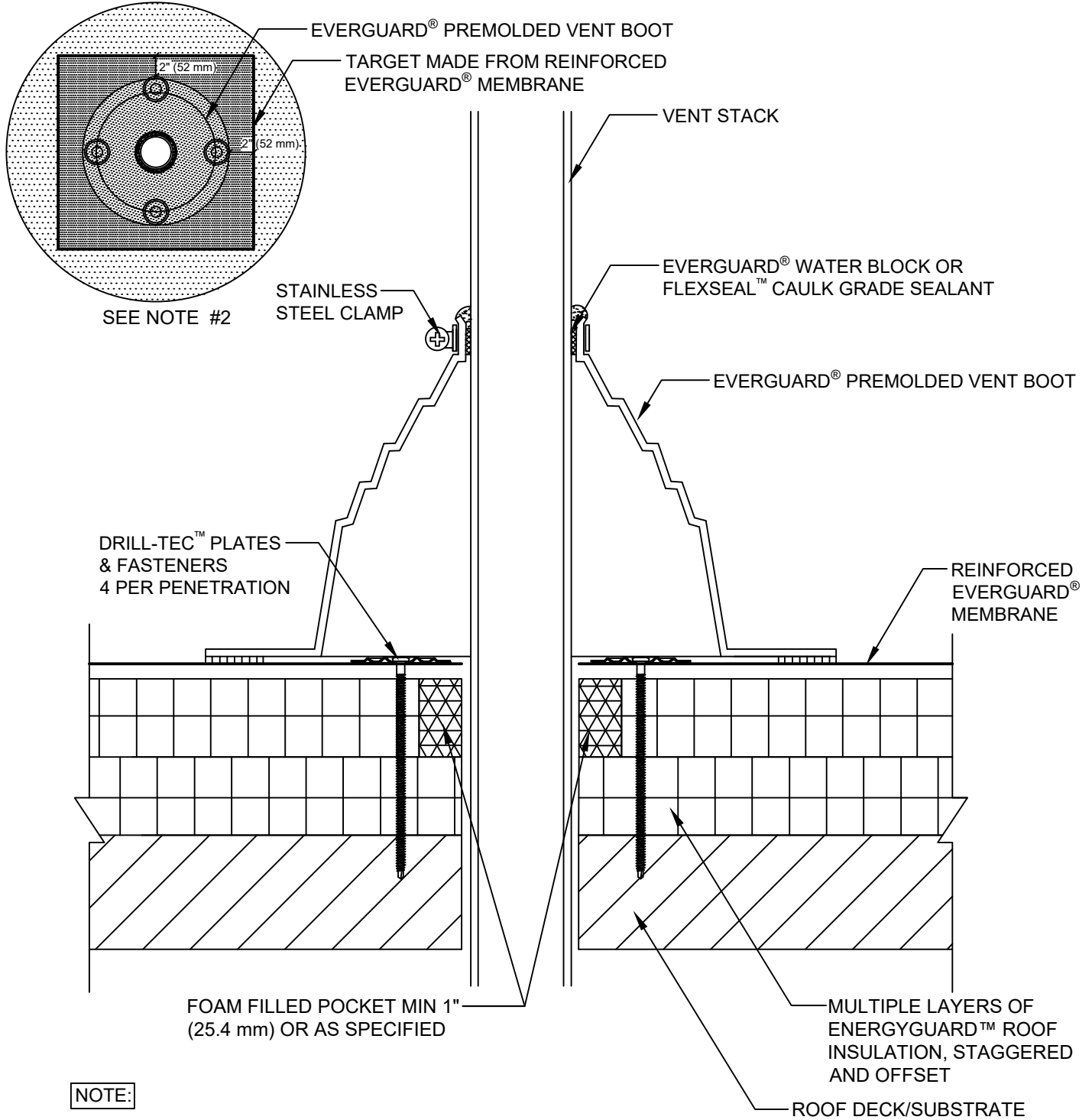

NOTE:

1. DO NOT CUT SIDE OF PREMOLDED BOOT. IT MUST BE PULLED OVER VENT PIPE.
2. IF THE PLATES AND FASTENERS INTRUDE INTO BOOT FLANGE AREA, THEN A TARGET MUST FIRST BE INSTALLED OVER PLATES AND FASTENERS BEFORE BOOT INSTALLATION.



PREMOLDED VENT BOOT FLASHING DETAIL

DRAWING #
506B

THIS DETAIL APPLIES TO:
ADHERED SYSTEMS
MECHANICALLY ATTACHED SYSTEMS
RHINO BOND® SYSTEMS

ISSUE / REVISION DATE
11/30/20

SCALE
N.T.S.

LEGEND

- HEAT-WELDED
- FLEXSEAL™ CAULK GRADE SEALANT