

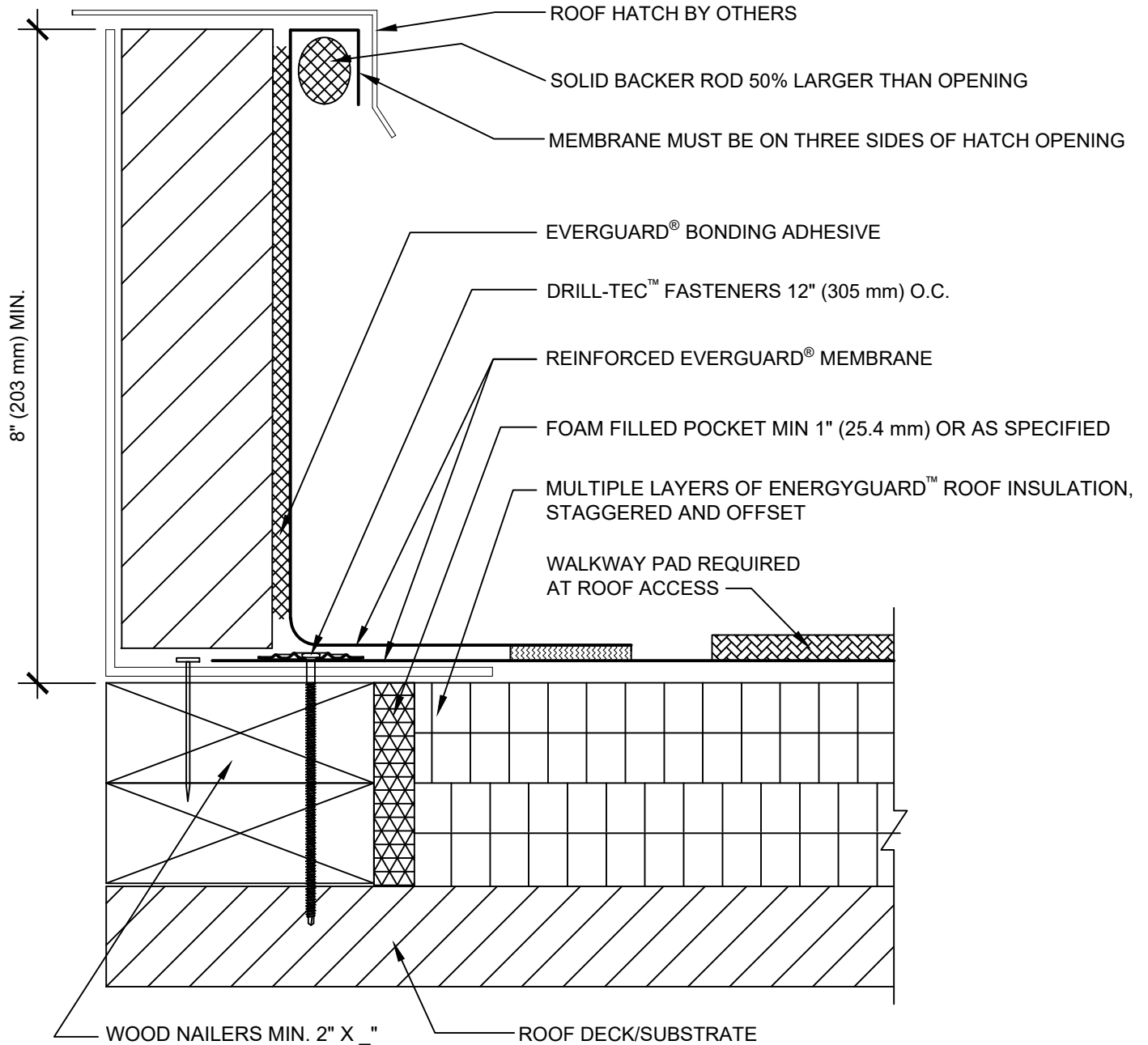

SINGLE-PLY: TPO & PVC 60-80 mil membranes



NOTE:

1. FOR STEEL ROOF DECKS: FILL STEEL DECK FLUTES WITH SPRAY FOAM INSULATION PRIOR TO THE INSTALLATION OF ABOVE DECK INSULATION A MINIMUM OF 12 INCHES (305 mm) FROM FACE OF OPENING.



ROOF HATCH DETAIL - AMBIENT INTERIOR CONDITIONS

DRAWING #
505B

THIS DETAIL APPLIES TO:
ADHERED SYSTEMS
MECHANICALLY ATTACHED SYSTEMS
RHINOBOND® SYSTEMS

ISSUE / REVISION DATE
3/29/21

SCALE
N.T.S.

LEGEND

- HEAT-WELDED
- EVERGUARD® BONDING ADHESIVE