

**LIQUID APPLIED  
MEMBRANE**

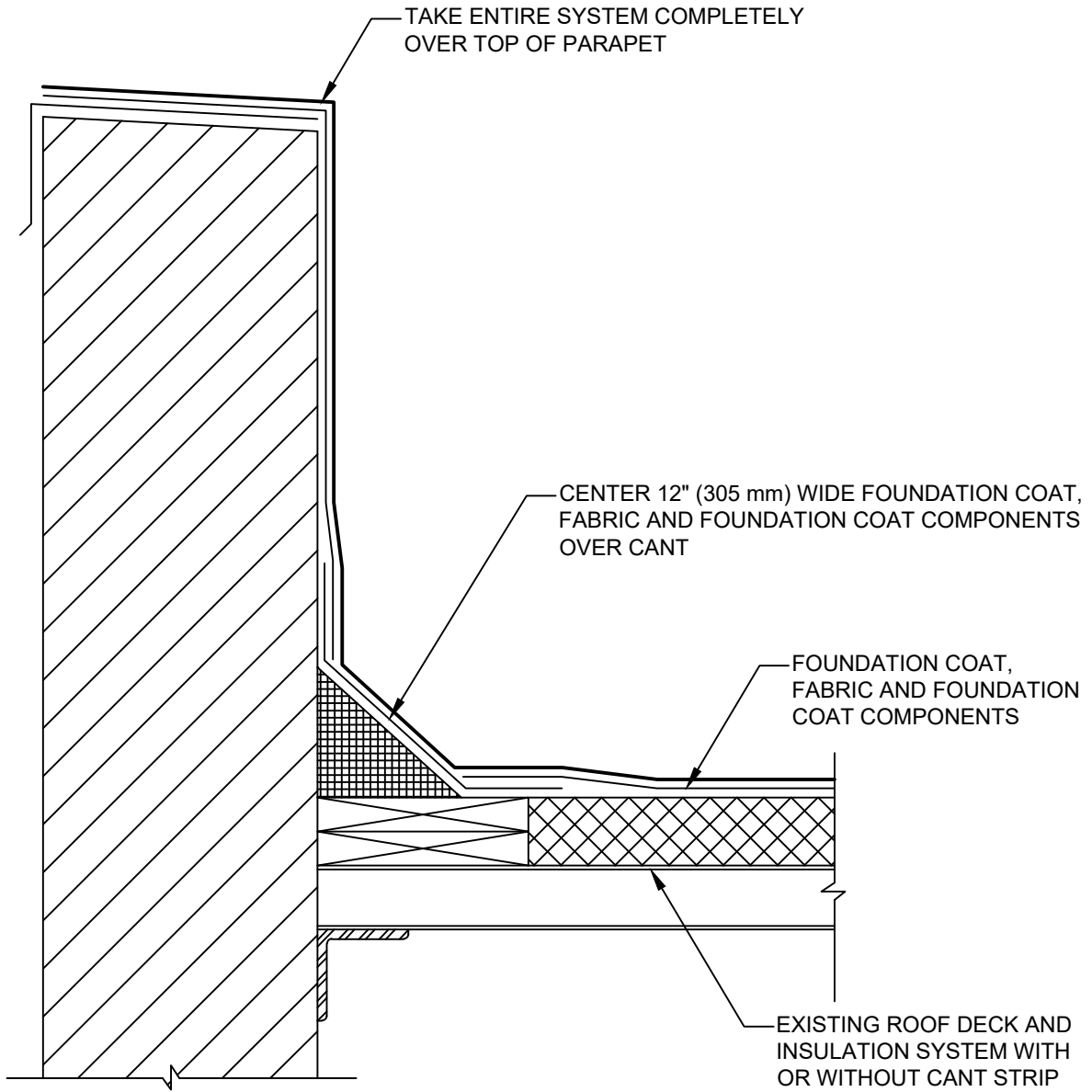

**NOTE:**

1. ALL FLASHING SHALL BE DESIGNED FOR THE APPLICABLE CONDITIONS. METAL THICKNESS, FASTENERS AND LAPPING SHALL BE AS SPECIFIED BY THE ROOF DESIGNER.
2. HYDROSTOP™ PREMIUMCOAT® SYSTEM - FOUNDATION COAT, FABRIC, FOUNDATION COAT, AND FINISH COAT COMPONENTS.
3. PRIMING - REFER TO HYDROSTOP™ SPECIFICATIONS FOR DECK PRIMING REQUIREMENTS.



**DRIP EDGE PARAPET WALL DETAIL**

DRAWING #  
**302**

ISSUE / REVISION DATE  
**2/20/20**

SCALE  
N.T.S.

**LEGEND**

— FINISH COAT COMPONENT  
OVER ENTIRE ROOF, COLOR  
AS SPECIFIED