

GAF

EVERGUARD PRO DRIP EDGE

FLAT ROOF FLANGE

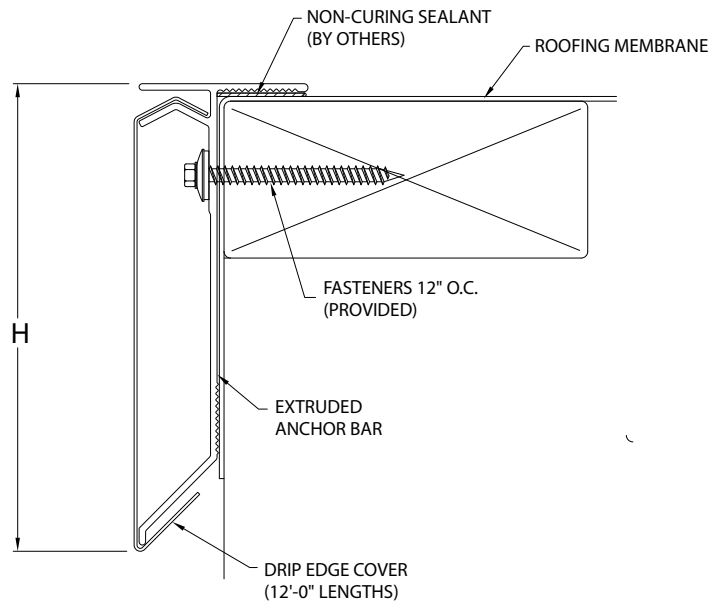

PITCHED ROOF FLANGE

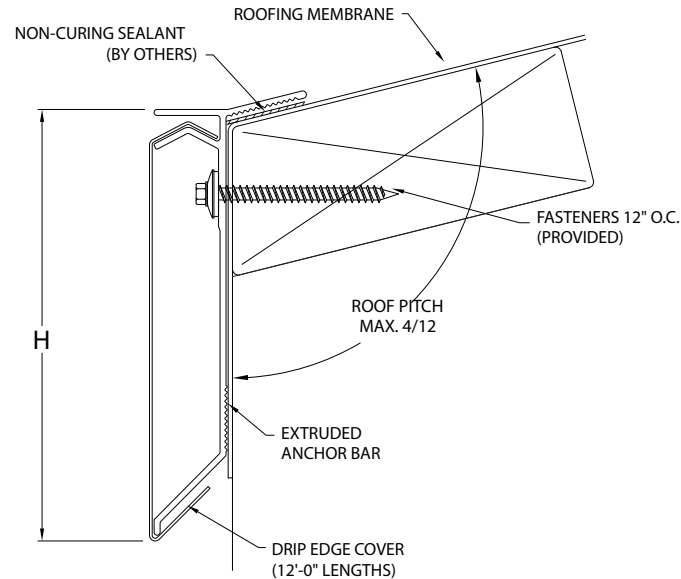

DIMENSIONS

PRODUCT ID. NO.	H DIM	ROOF FLANGE (SELECT ONE)
ADE-30	3"	<input type="checkbox"/> FLAT <input type="checkbox"/> PITCHED
ADE-45	4 1/2"	
ADE-60	6"	
ADE-75	7 1/2"	
		ROOF PITCH MAX. 4/12 PITCH

MATERIAL

- ☐ 24 Ga. Galv. Steel
☐ 22 Ga. Galv. Steel
☐ .040" Aluminum

Color: _____

Finish: _____

Substrate: ☐ Wood
☐ Masonry
☐ Metal

If substrate is not given, wood fasteners will be provided.

☐ OTHER: _____

QUANTITIES

_____ Lineal Feet (12'-0" Lengths)
 _____ Outside Miter (90°)
 _____ Inside Miter (90°)
 _____ Right Endcap
 _____ Left Endcap

NOTES

- Fascia cover provided with lap joints
- For non-90 miters, see separate print approval
- Product should be installed per provided installation instructions
- ANSI/SPRI/FM 4435/ES-1 Test Pressure up to 98 psf

APPROVALS



ANSI/SPRI/FM 4435/ES-1
Test Pressures listed in notes

PROJECT INFO

Project Name: _____

Architect: _____

Roofing Contractor: _____

Project Type: _____

☐ By selecting this box you have verified and confirmed that dimensions, sizes, and quantities are correct. All products will be installed in strict accordance with printed instructions.

Date: _____

GAF
 1 Campus Drive,
 Parsippany, NJ 07054
 USA
 973-628-3000
 WWW.GAF.COM

SHT# _____ of _____

DATE: **07/10/24**

DRN BY: **MM**

CKD BY: **MM**

DWG #: 25010-42513

REV: **A**