

(A) CORNER

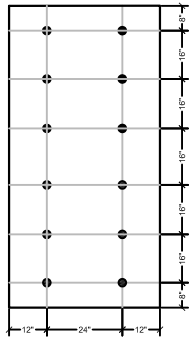

12 FASTENERS PER BOARD

(B) PERIMETER

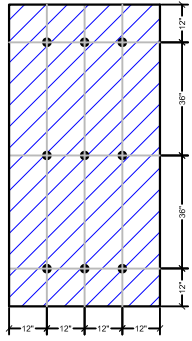

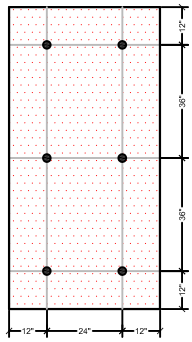

9 FASTENERS PER BOARD

(C) FIELD



6 FASTENERS PER BOARD

ZONE LEGEND

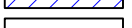
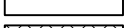
-  FIELD
-  PERIMETER
-  CORNER
-  TRANSITION

NOTE:

1. SEE EVERGUARD® SYSTEM GUIDELINES IN SPEC MANUAL TO DETERMINE PERIMETER AND PENETRATION FASTENER SPACING FOR VARIOUS DECK TYPES AND WIND UPLIFT REQUIREMENTS.
2. IF A PORTION OF A BOARD EXTENDS INTO ANOTHER ZONE, IT MUST DEFER TO THE ZONE THE GREATER FASTENING PATTERN.

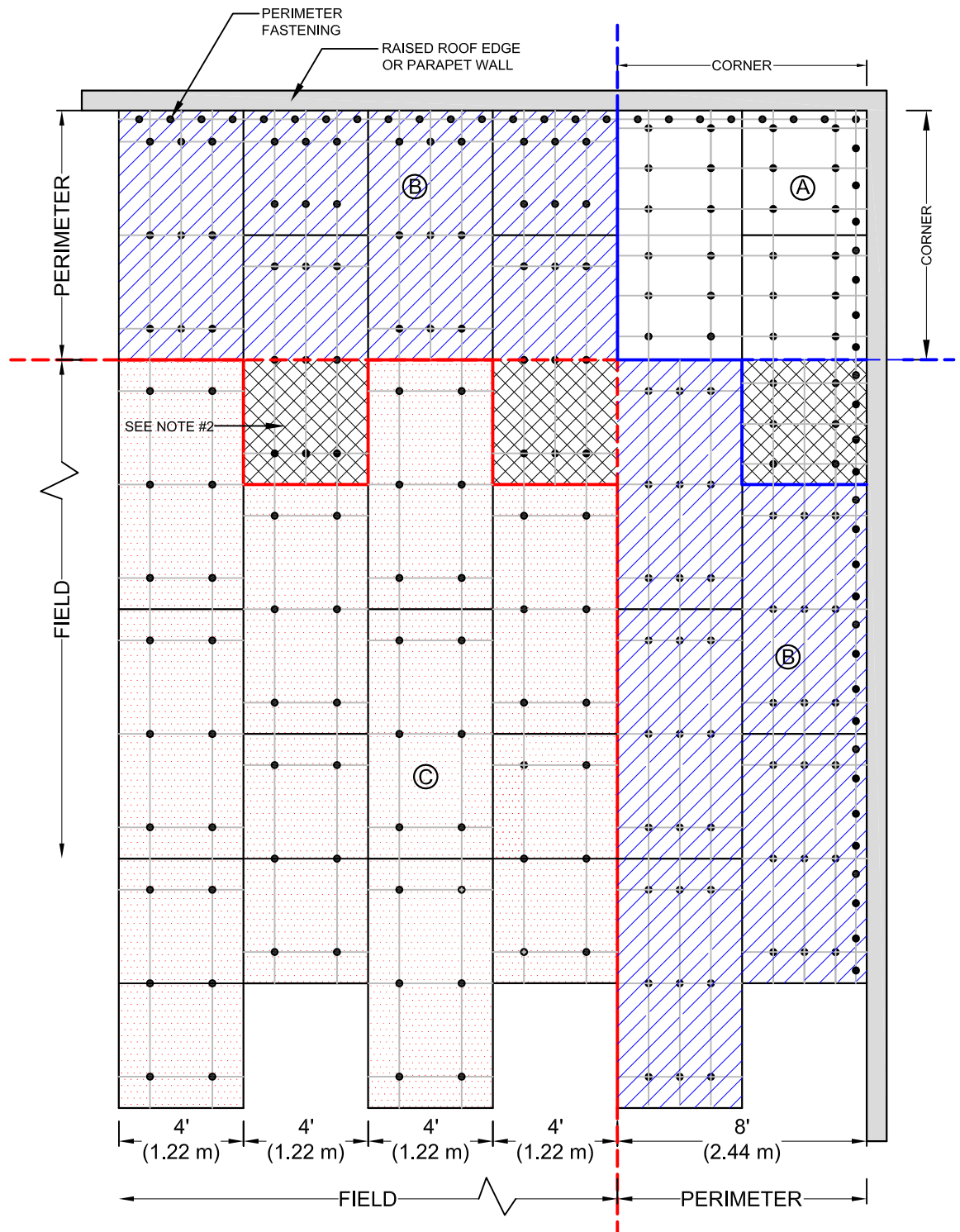

EverGuard
SINGLE-PLY ROOFING SYSTEMS
FIELD OF ROOF
SERIES

DRAWING #
107
SCALE
N.T.S.

RHINO BOND FASTENING ZONES & LOCATIONS
OVER APPROVED STEEL & CONCRETE DECKS

THIS DETAIL APPLIES TO:
RHINO BOND® ATTACHMENT SYSTEMS
REVISION DATE
2-19-16