

**STEP 1:**  
REFER TO DETAIL 301 FOR INSTALLATION OF THE ROOF MEMBRANE AT THE BASE OF THE WALL, NOTCHING OR OVERLAPPING THE TURNED UP EDGES WHERE THE CANTS MEET AT THE CORNER OF THE WALL

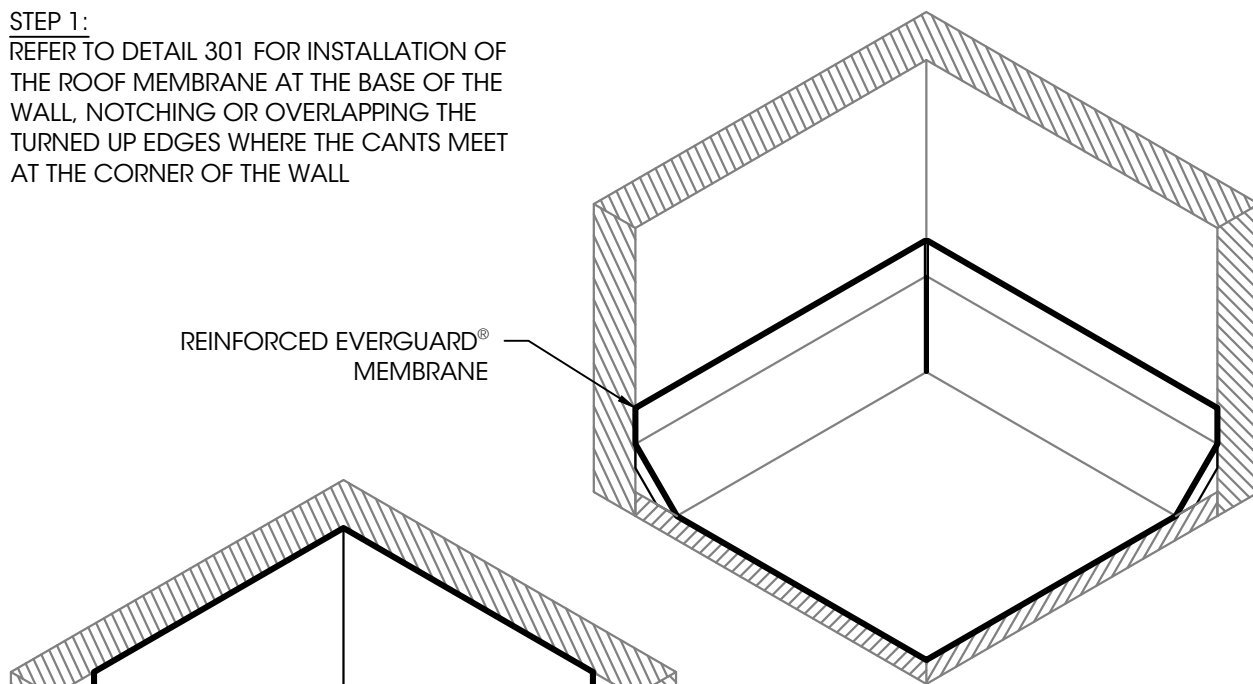

REINFORCED EVERGUARD®  
MEMBRANE

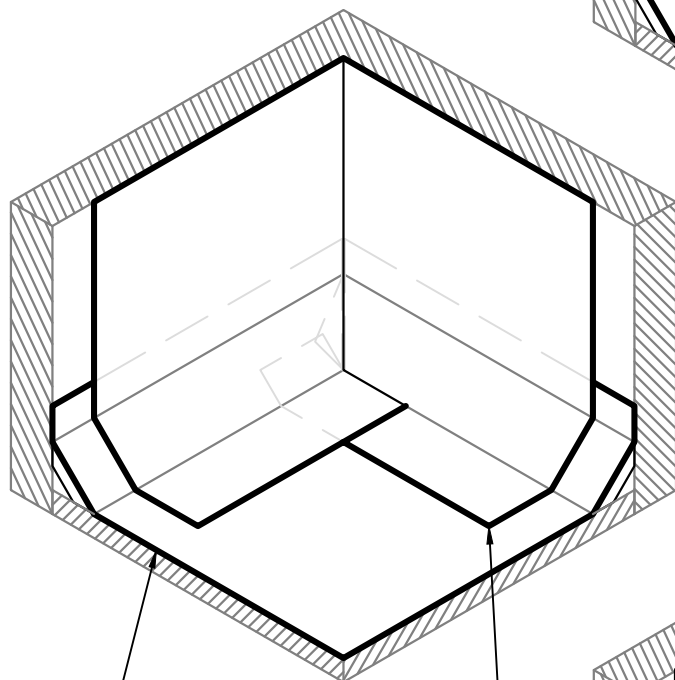

REINFORCED EVERGUARD®  
MEMBRANE

**STEP 3:**  
USING EVERGUARD® DETAILING MEMBRANE OR EVERGUARD® FLUTED CORNER PATCHES, REINFORCE THE JUNCTURES OF BOTH WALL FLASHING MEMBRANES AT THE CORNERS OF THE CANT. PATCHES MUST BE CONTINUOUSLY HEAT WELDED AT THE FULL PERIMETER.

**STEP 2:**  
REFER TO DETAIL 301 FOR INSTALLATION OF THE WALL FLASHING, NOTCHING AND OVERLAPPING THE BOTTOM EDGES WHERE THE CANTS MEET AT THE CORNER OF THE WALL. PROVIDE A CONTINUOUS HEAT-WELD AT ALL EXPOSED SEAMS.

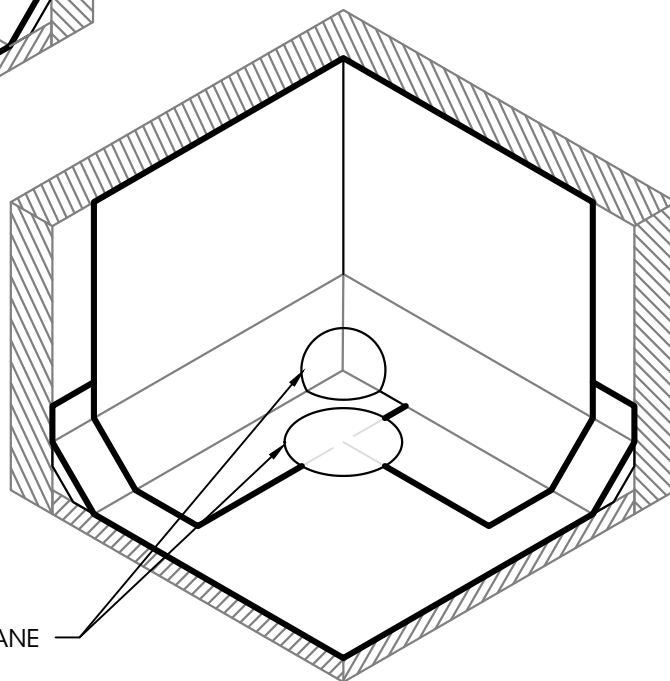

UNREINFORCED MEMBRANE



We  
protect  
what  
matters  
most™

**Product:**  
EverGuard PVC  
Fleece-back

**Installation  
Method:**  
Hybrid

**Maximum  
Warranty:**  
30 Years

**Date:**  
7/11/2025

**Scale:**  
None

**Detail No.**  
07 54 19  
**935**

## Flashing of Inside Corner with Cant Strip