

CORNER FASTENING

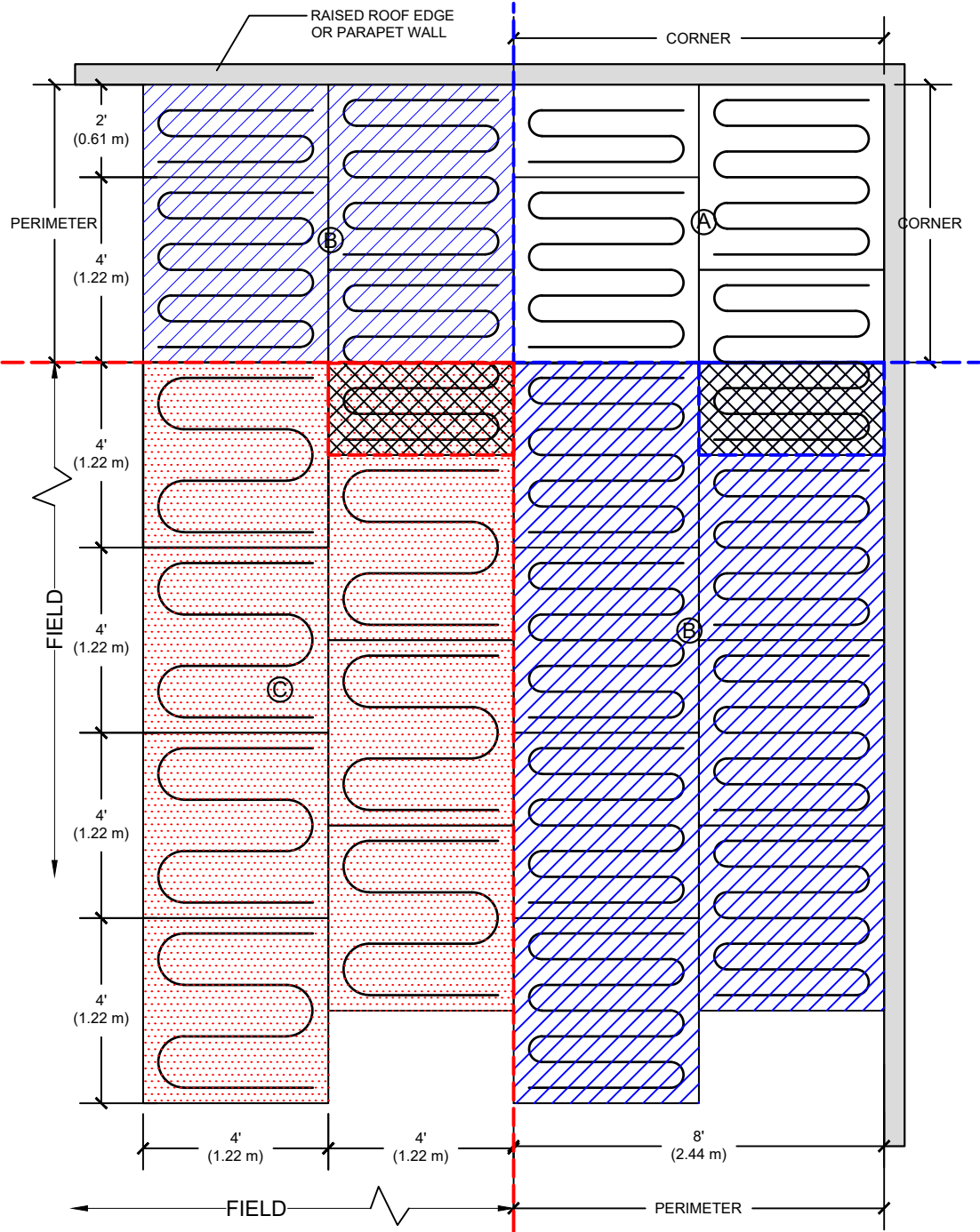
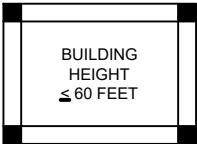

NOTE:

1. WHEN APPLYING MULTIPLE LAYERS OF INSULATION, IT IS REQUIRED TO RUN THE BEADS PERPENDICULAR TO THE PRECEDING LAYER.
2. IF A PORTION OF A BOARD EXTENDS INTO ANOTHER ZONE, IT MUST DEFER TO THE ZONE OF THE GREATER FASTENING PATTERN.

GAF

LOW RISE FOAM FASTENING ZONES & PATTERNS

DRAWING #
107C

THIS DETAIL APPLIES TO:
ADHERED SYSTEMS

ISSUE / REVISION DATE
2/27/25

SCALE
N.T.S.

LEGEND

- FIELD ZONE
- PERIMETER ZONE
- CORNER ZONE
- TRANSITION ZONE