

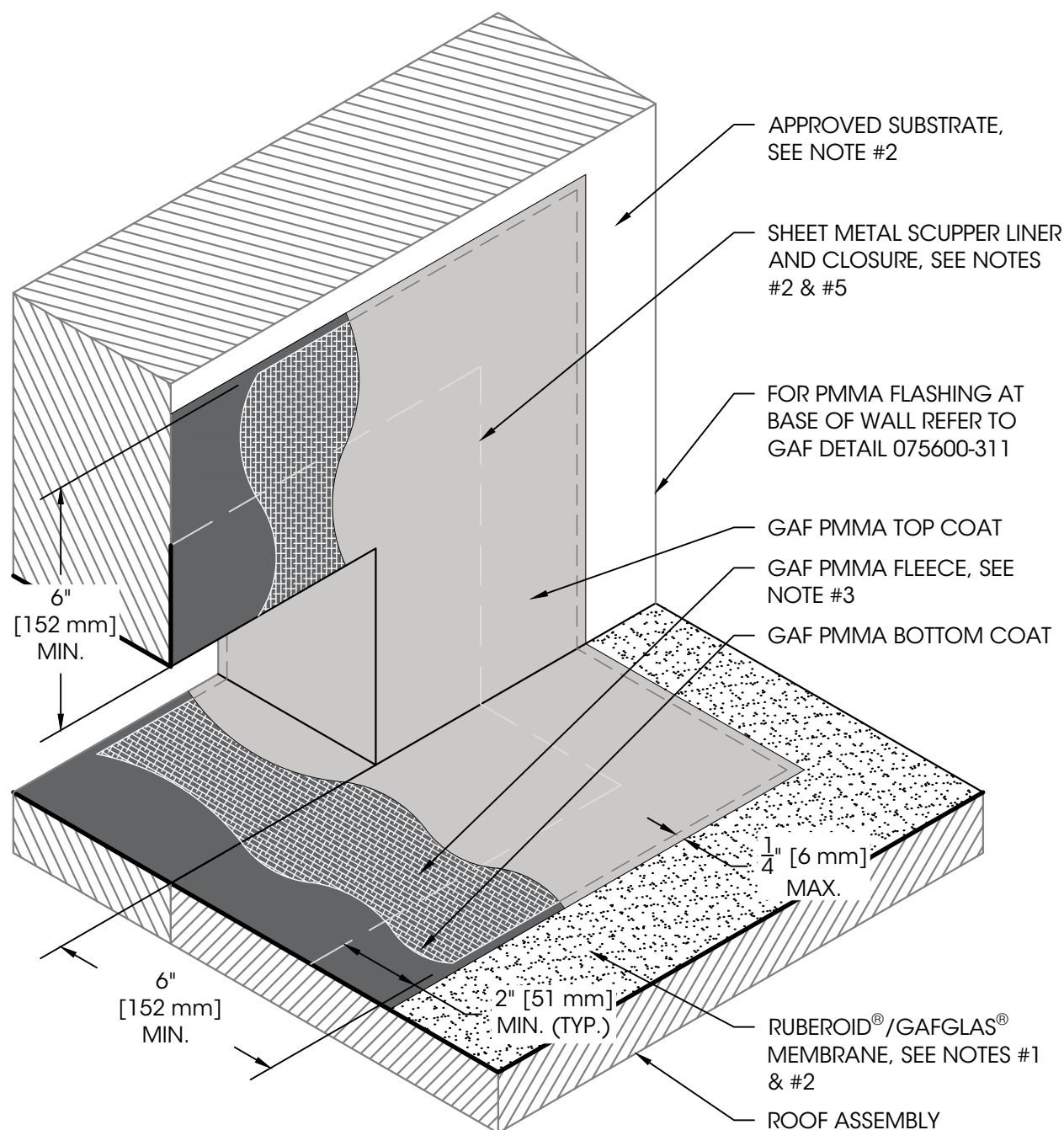

We
protect
what
matters
most™



NOTES:

1. APPROVED FOR USE OVER ANY RUBEROID® GRANULE SBS (HOT-MOPPED OR HEAT-WELDED) OR GAFGLAS® CAP SHEET (HOT-MOPPED).
2. REFER TO THE GAF PMMA FLASHING INSTALLATION INSTRUCTIONS FOR PROPER SURFACE TREATMENT OF ALL MATERIALS.
3. REFER TO GAF DETAILS 075600-906 & 075600-907 FOR GAF PMMA FLEECE CONFIGURATIONS, CUTTING, FOLDING, & LAPPING TECHNIQUES.
4. PMMA FLASHING IS COVERED UNDER THE APPLICABLE SYSTEM WARRANTY.
5. REFER TO NRCA GUIDELINES FOR ARCHITECTURAL METAL FLASHINGS FOR SCUPPER DETAILS.

Product:
GAF PMMA
Flashing

**Installation
Method:**
Over SBS/BUR

**Maximum
Warranty:**
See Note #4

Date:
12/19/2024

Scale:
Not To Scale

Detail No.
075600
316

Scupper Flashing