

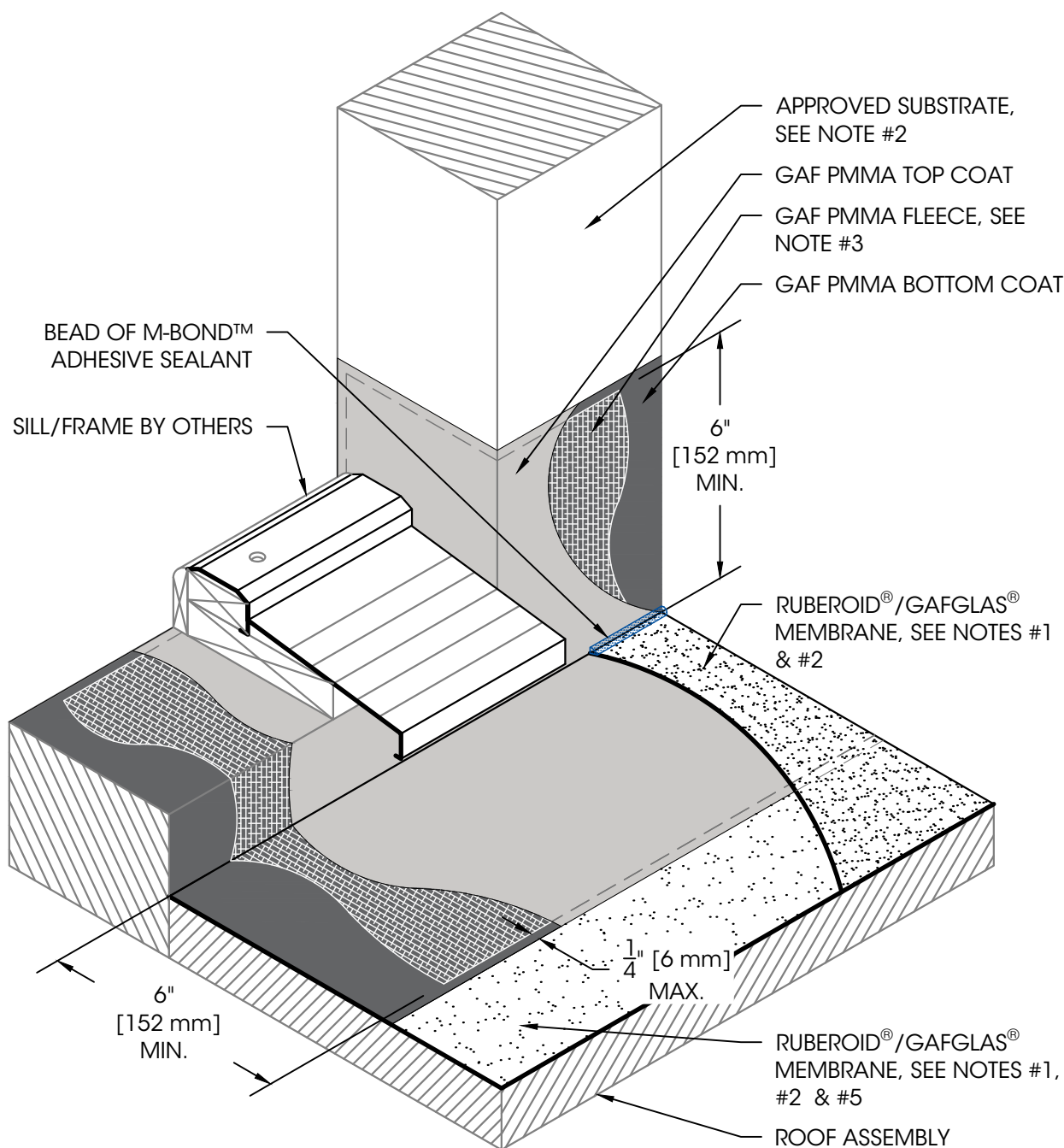

We
protect
what
matters
most™

Legend:
Sealant



NOTES:

1. APPROVED FOR USE BETWEEN ANY RUBEROID® SMOOTH SBS AND ANY RUBEROID® GRANULE SBS (HOT-MOPPED OR HEAT-WELDED) OR BETWEEN ANY GAFGLAS® PLY SHEET AND CAP SHEET (HOT-MOPPED).
2. REFER TO THE GAF PMMA FLASHING INSTALLATION INSTRUCTIONS FOR PROPER SURFACE TREATMENT OF ALL MATERIALS.
3. REFER TO GAF DETAILS 075600-906 & 075600-907 FOR GAF PMMA FLEECE CONFIGURATIONS, CUTTING, FOLDING, & LAPPING TECHNIQUES.
4. PMMA FLASHING IS COVERED UNDER THE APPLICABLE SYSTEM WARRANTY.
5. DO NOT GLAZE COAT THE GAFGLAS® PLY SHEET WITH HOT ASPHALT PRIOR TO THE APPLICATION OF THE GAF PMMA FLASHING.

Product:
GAF PMMA
Flashing

**Installation
Method:**
Interply SBS/BUR

**Maximum
Warranty:**
See Note #4

Date:
1/9/2025

Scale:
Not To Scale

Detail No.
075600
325

Sill/Threshold Flashing