

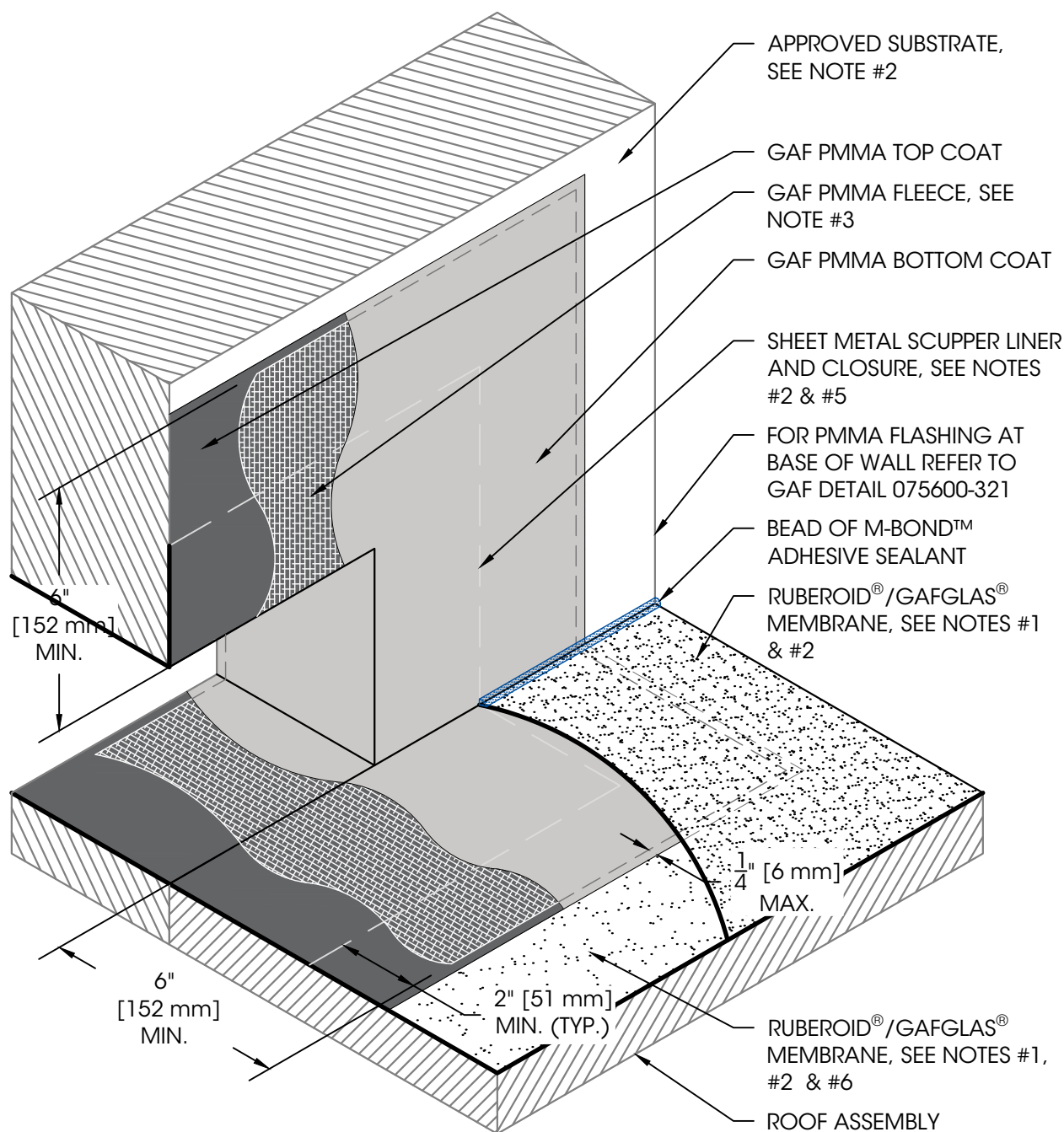

We  
protect  
what  
matters  
most™

**Legend:**  
Sealant



#### NOTES:

1. APPROVED FOR USE BETWEEN ANY RUBEROID® SMOOTH SBS AND ANY RUBEROID® GRANULE SBS (HOT-MOPPED OR HEAT-WELDED) OR BETWEEN ANY GAFGLAS®; PLY SHEET AND CAP SHEET (HOT-MOPPED).
2. REFER TO THE GAF PMMA FLASHING INSTALLATION INSTRUCTIONS FOR PROPER SURFACE TREATMENT OF ALL MATERIALS.
3. REFER TO GAF DETAILS 075600-906 & 075600-907 FOR GAF PMMA FLEECE CONFIGURATIONS, CUTTING, FOLDING, & LAPPING TECHNIQUES.
4. PMMA FLASHING IS COVERED UNDER THE APPLICABLE SYSTEM WARRANTY.
5. REFER TO NRCA GUIDELINES FOR ARCHITECTURAL METAL FLASHINGS FOR SCUPPER DETAILS.
6. DO NOT GLAZE COAT THE GAFGLAS® PLY SHEET WITH HOT ASPHALT PRIOR TO THE APPLICATION OF THE GAF PMMA FLASHING.

**Product:**  
GAF PMMA  
Flashing

**Installation  
Method:**  
Interply SBS/BUR

**Maximum  
Warranty:**  
See Note #4

**Date:**  
1/9/2025

**Scale:**  
Not To Scale

**Detail No.**  
075600  
**326**

## Scupper Flashing