

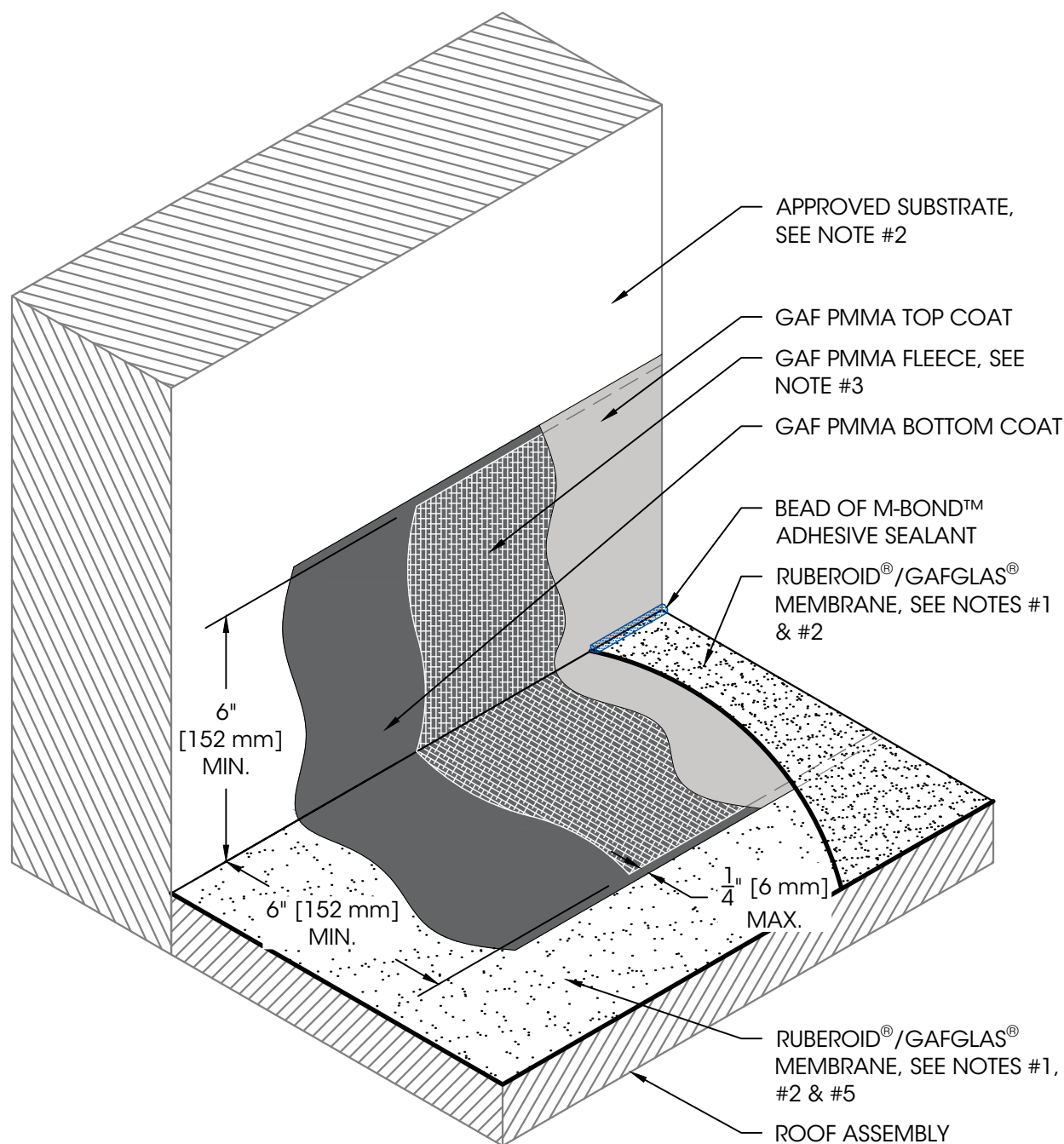

We  
protect  
what  
matters  
most™

**Legend:**  
Sealant



#### NOTES:

1. APPROVED FOR USE BETWEEN ANY RUBEROID® SMOOTH SBS AND ANY RUBEROID® GRANULE SBS (HOT-MOPPED OR HEAT-WELDED) OR BETWEEN ANY GAFGLAS® PLY SHEET AND CAP SHEET (HOT-MOPPED).
2. REFER TO THE GAF PMMA FLASHING INSTALLATION INSTRUCTIONS FOR PROPER SURFACE TREATMENT OF ALL MATERIALS.
3. REFER TO GAF DETAILS 075600-906 & 075600-907 FOR GAF PMMA FLEECE CONFIGURATIONS, CUTTING, FOLDING, & LAPPING TECHNIQUES.
4. PMMA FLASHING IS COVERED UNDER THE APPLICABLE SYSTEM WARRANTY.
5. DO NOT GLAZE COAT THE GAFGLAS® PLY SHEET WITH HOT ASPHALT PRIOR TO THE APPLICATION OF THE GAF PMMA FLASHING.

**Product:**  
GAF PMMA  
Flashing

**Installation  
Method:**  
Interply SBS/BUR

**Maximum  
Warranty:**  
See Note #4

**Date:**  
1/9/2025

**Scale:**  
Not To Scale

**Detail No.**  
075600  
**321**

## Flashing at Base of Wall