



We  
protect  
what  
matters  
most™

**Legend:**

Heat Weld



Adhesive



**Product:**  
EverGuard TPO

**Installation:**  
Cold Storage  
Systems

**Maximum  
Warranty:**  
—

**Date:**  
2/13/2025

**Scale:**  
Not To Scale

**Detail No.**  
075423

**130C**

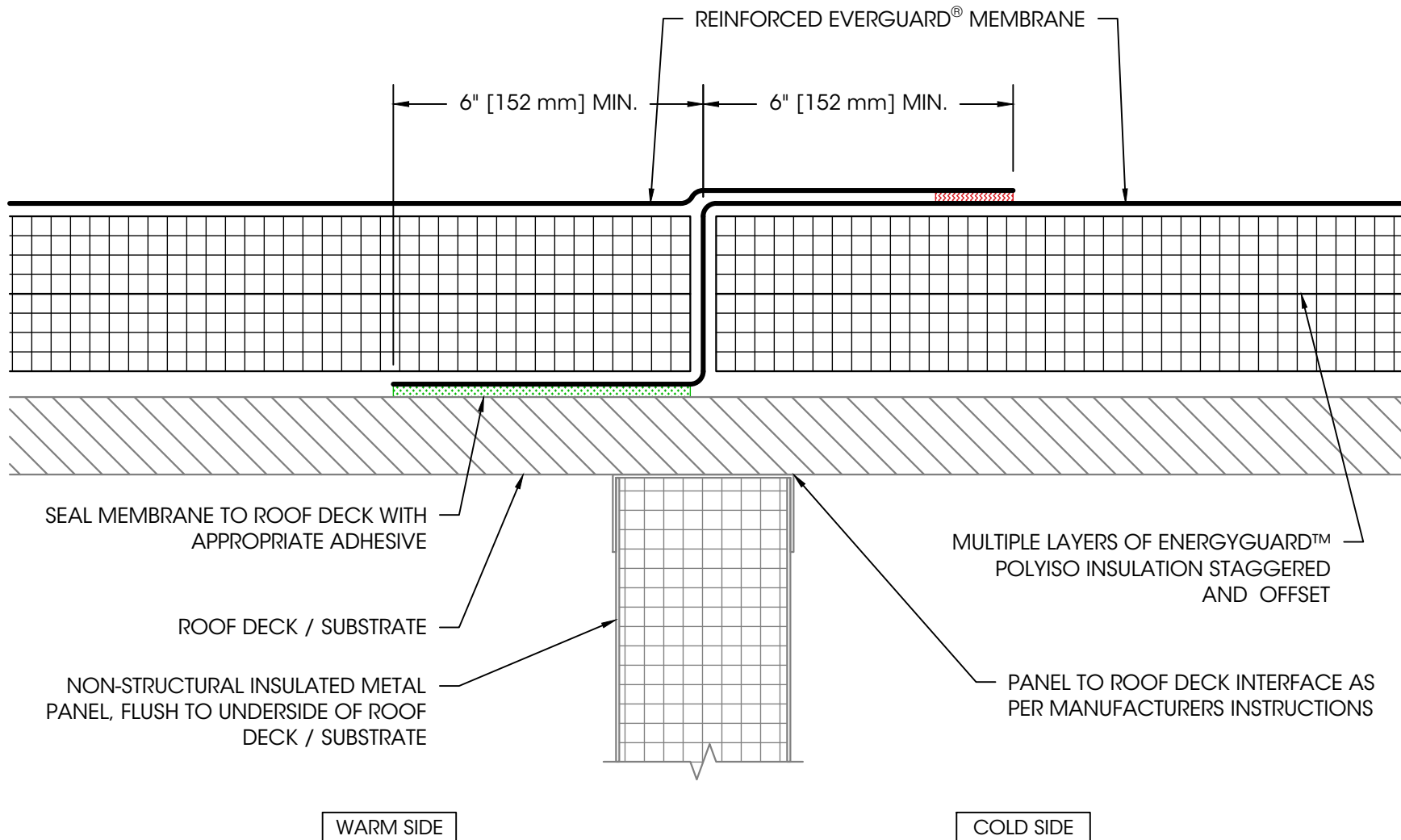

**NOTES:**

1. FOR STEEL ROOF DECKS: FILL TOPSIDE OF STEEL DECK FLUTES WITH CLOSED CELL SPRAY FOAM INSULATION PRIOR TO THE INSTALLATION OF ABOVE DECK INSULATION A MINIMUM OF 12" [305 mm] FROM FACE OF WALL ON EACH SIDE, BOTH SIDES OF WALL.
2. AIR SEAL WALL-TO-UNDERSIDE OF ROOF DECK INTERFACE AS PER ARCHITECTURAL DRAWINGS.

## Cold to Warm Transition - IMP Below Deck