

**20 YEAR MAX  
GUARANTEE**

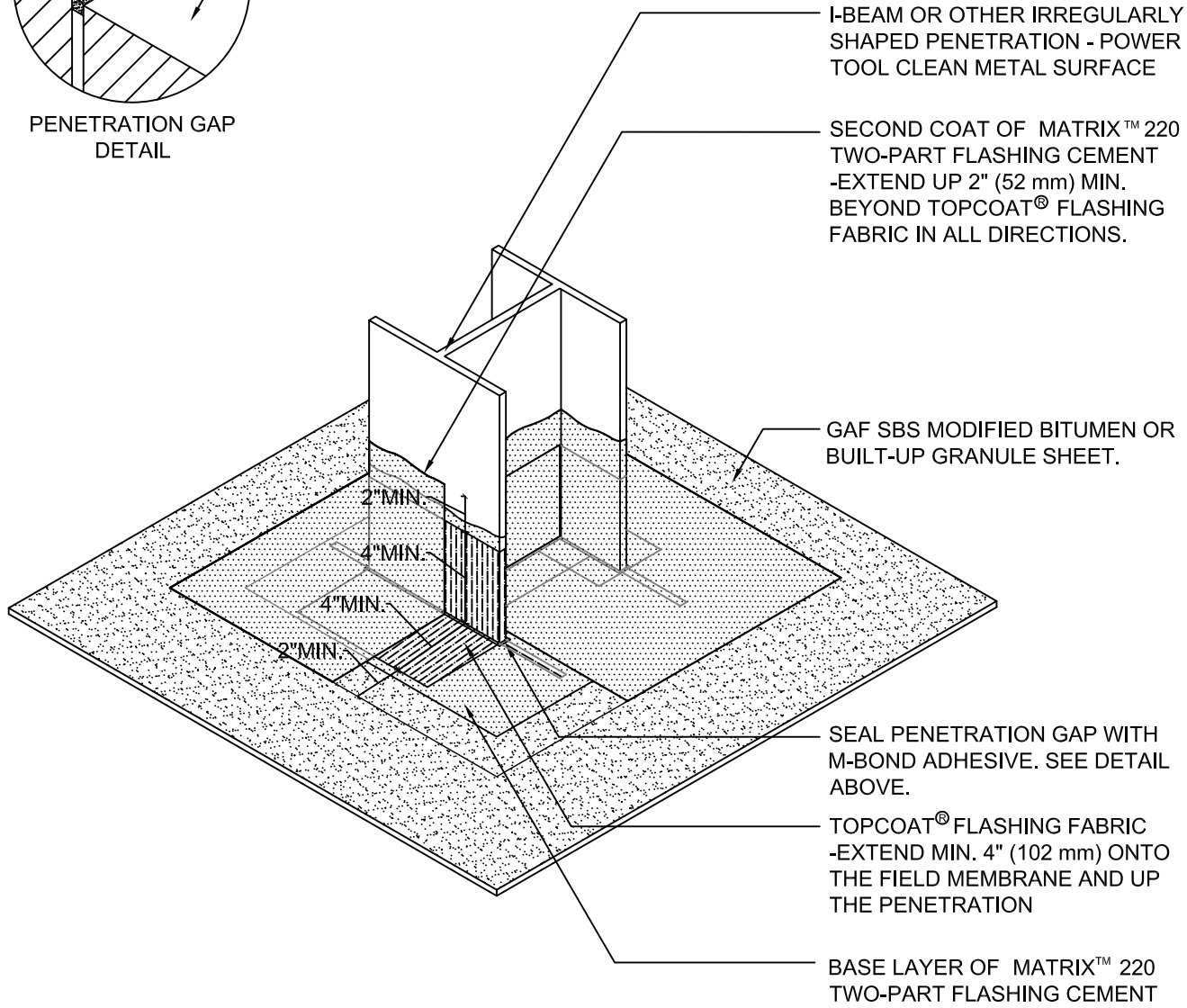

**NOTE:**

1. PENETRATION GAPS GREATER THAN 1/4" (6.4 mm) REQUIRE BACKER ROD BEFORE APPLICATION OF M-BOND ADHESIVE.

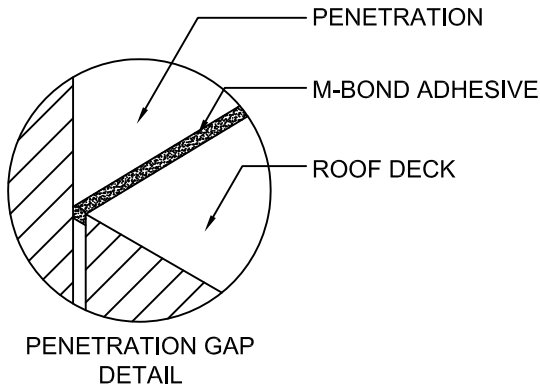

**MATRIX™ 220**  
TWO-PART FLASHING  
CEMENT  
ROOF  
PENETRATION  
SERIES

**I-BEAM PENETRATION FLASHING DETAIL**

DRAWING #  
**503**

SYSTEM  
**MX220**

SCALE  
N.T.S.

ISSUE/ REVISION DATE  
6-1-15