

**20 YEAR MAX
GUARANTEE**

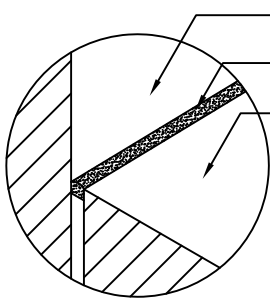

**PENETRATION GAP
DETAIL**

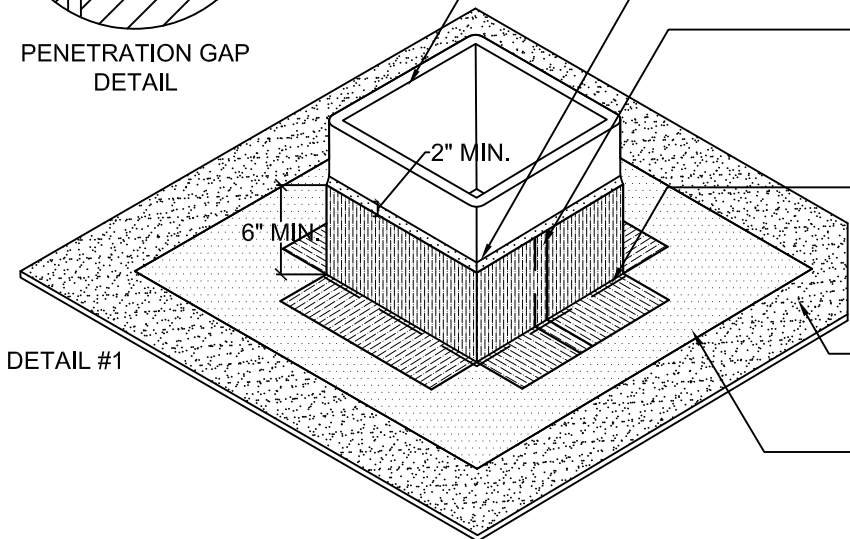

DETAIL #1

SQUARE PENETRATION - POWER TOOL
CLEAN METAL SURFACE

BASE LAYER OF MAJORSEAL™ EXTEND
2" MIN PAST UNITED™ COATINGS
ROOFMATE FABRIC

UNITED COATINGS™ ROOFMATE
FABRIC WRAPPED AROUND METAL
PENETRATION WITH 2" MIN. OVERLAP
AT ALL JOINTS.

FILL GAP WITH M-BOND ADHESIVE
PRIOR TO FIRST COAT OF MAJORSEAL™.
SEE PENETRATION GAP DETAIL ABOVE.

GAF SBS MODIFIED BITUMEN OR BUILT-UP
GRANULE SHEET.

MAJORSEAL™ BASE LAYER EXTEND OUT
IN FIELD TO ACCOMMODATE FABRIC
COLLAR IN DETAIL #2

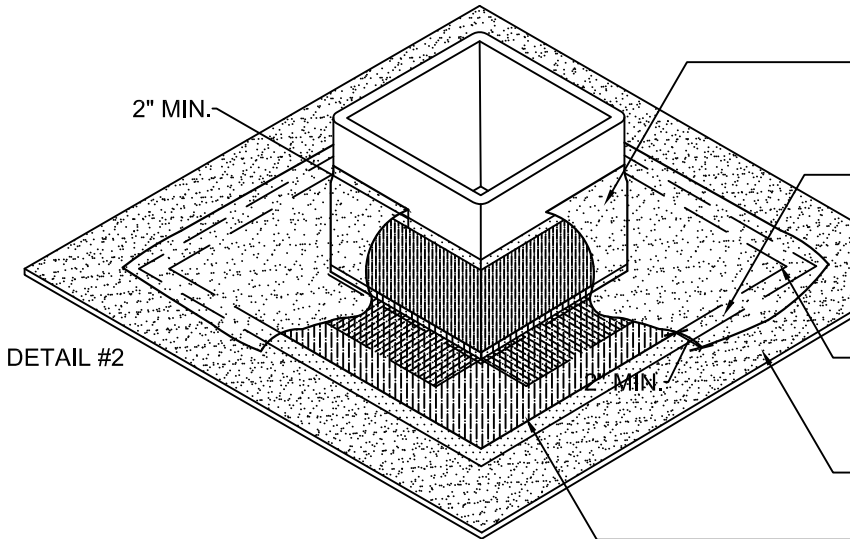

DETAIL #2

EXTEND OUTER COAT OF MAJORSEAL™
UP 2" MIN. ABOVE UNITED™ COATINGS
ROOFMATE FABRIC

TOP LAYER OF MAJORSEAL™
EXTENDING A MINIMUM OF
2" PAST TOPCOAT FLASHING
FABRIC IN ALL LOCATIONS.

SURFACE GRANULES APPLIED TO TOP
LAYER OF MAJORSEAL™ LIQUID FLASHING

GAF SBS MODIFIED BITUMEN OR BUILT-UP
GRANULE SHEET.

UNITED COATINGS™ ROOFMATE
FABRIC COLLAR CUT SNUG FIT AROUND
PENETRATION WITH 1/4" MIN. VERTICAL
UP TURN.

NOTE:

1. PENETRATION GAPS GREATER THAN 1/4" (6MM) REQUIRE BACKER ROD BEFORE APPLICATION OF M-BOND ADHESIVE.

 www.gaf.com 1 Campus Drive, Parsippany, NJ 07054	MAJORSEAL™ LIQUID FLASHING	LOW SQUARE POST PENETRATION FLASHING DETAIL	DRAWING # 510	SYSTEM MM
	ROOF PENETRATION SERIES		SCALE N.T.S.	ISSUE/ REVISION DATE 1-1-16