

**20 YEAR MAX
GUARANTEE**

WITH CUT-IN REGLET

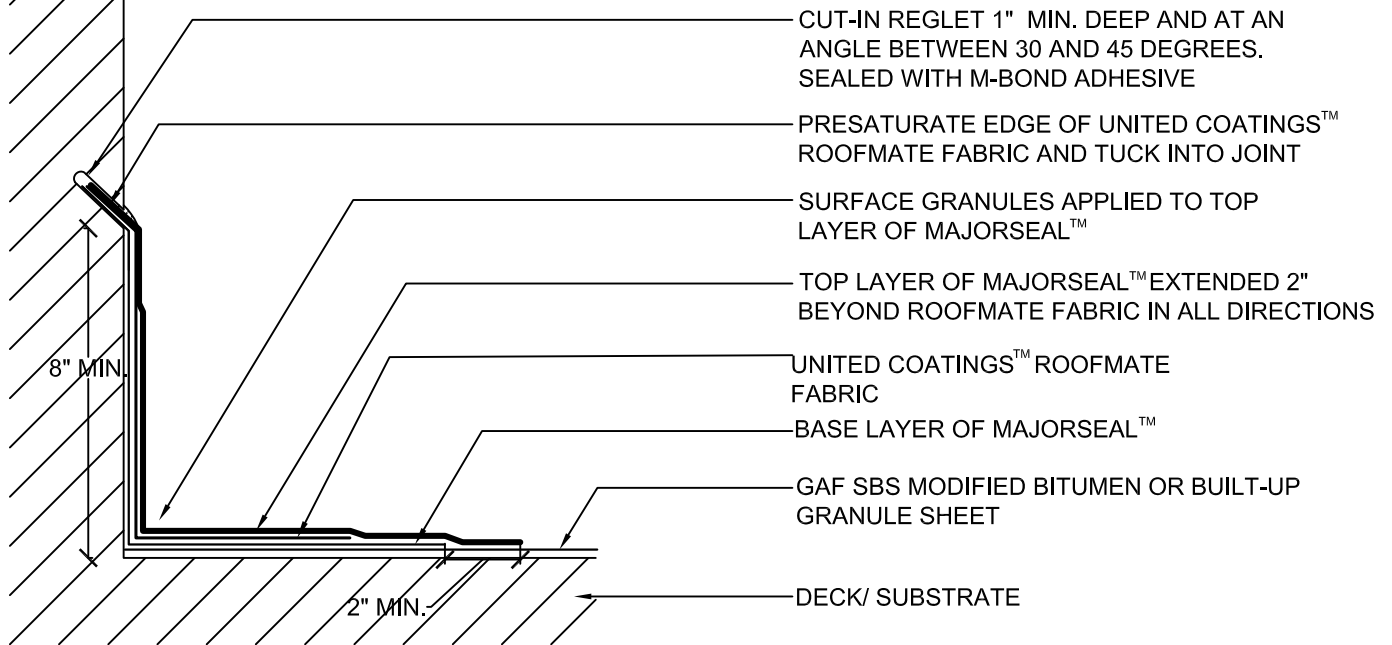

WITH COUNTERFLASHING

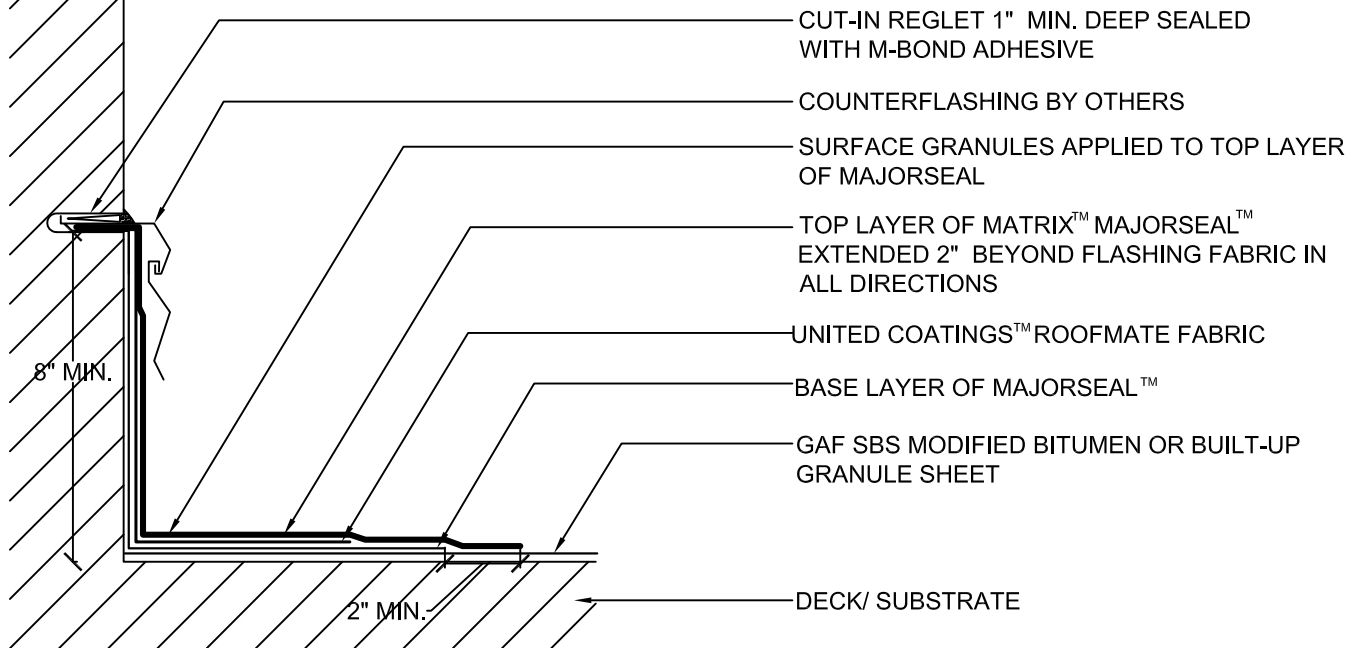

NOTE:

1. IF GAF GRANULE MEMBRANE IS LEFT EXPOSED OVERNIGHT BEFORE INSTALLING MAJORSEAL™ LIQUID FLASHING, A TEMPORARY NIGHT SEAL MUST BE INSTALLED. THE NIGHT SEAL MUST BE COMPLETELY REMOVED BEFORE INSTALLING THE FLASHING.



MAJORSEAL™
LIQUID FLASHING

ALTERNATE BASE FLASHING - 8" MIN.

DRAWING #

303

SYSTEM

MM

www.gaf.com
1 Campus Drive,
 Parsippany, NJ 07054

WALL & CURB
SERIES

SCALE

N.T.S.

ISSUE/ REVISION DATE

1-1-16