

DRILL-TEC™ RHINOBOND®
XHD PLATE



DRILL-TEC™ PURLIN
FASTENER

NOTE:

TPO= YELLOW PLATE
PVC= BLACK PLATE

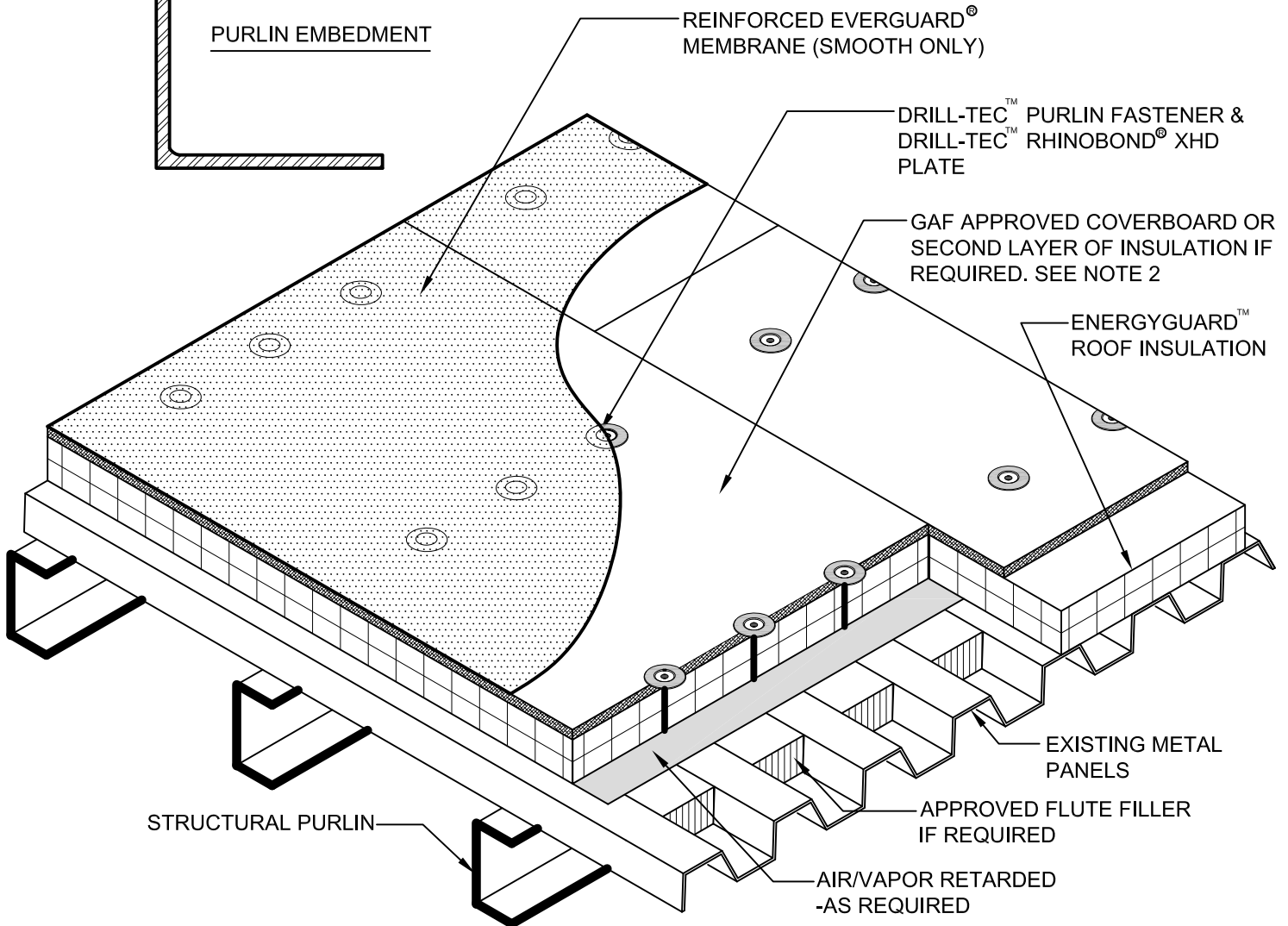

NOTE:

1. REFER TO THE DRILL-TEC™ RHINOBOND® ATTACHMENT TABLES FOR DETAILED INSTALLATION REQUIREMENTS REGARDING DECK TYPE, PLATE & FASTENER TYPE, AND SPACING.

2. TOP LAYER OF INSULATION DOES NOT HAVE TO BE STAGGERED.



DRAWING #

DRILL-TEC™ RHINOBOND® ASSEMBLY
PURLIN DETAIL

THIS DETAIL APPLIES TO:
Plate-Welded
Systems

www.gaf.com
1 Campus Drive,
Parsippany, NJ 07054

SCALE
N.T.S.

METAL RETROFIT

REVISION DATE
4-8-16