

ALTERNATE INSTALLATION

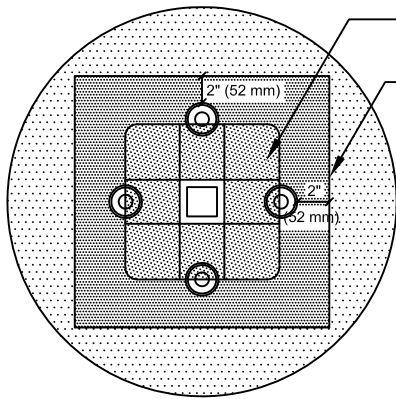

SEE NOTE #1

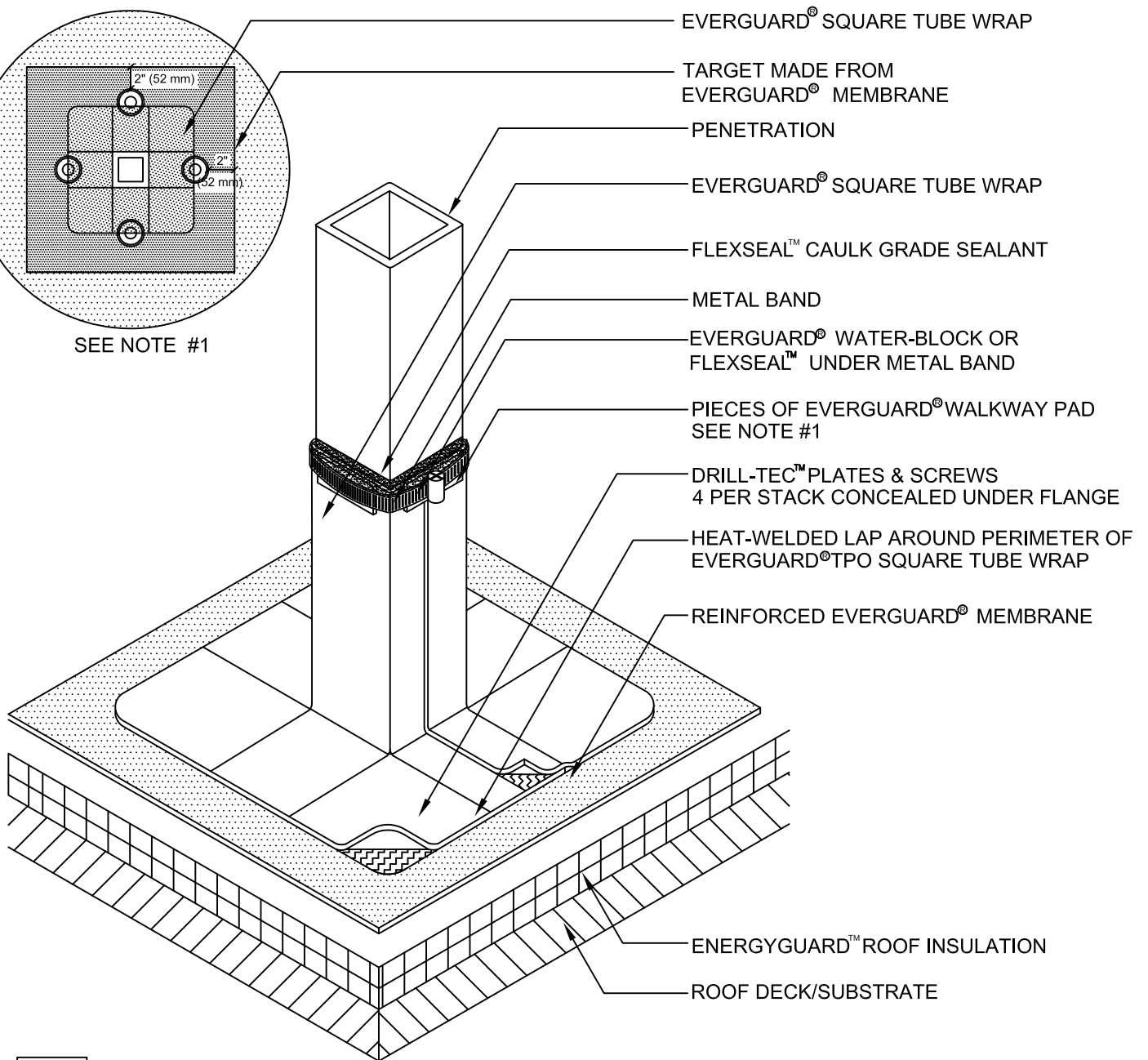

NOTE:

1. IF A TIGHTER FIT IS REQUIRED AT THE TOP OF THE WRAP, INSERT SLIVERS OF WALKWAY PAD BETWEEN THE BAND AND THE MEMBRANE ON ALL FOUR SIDES.
2. IF PLATES AND FASTENERS ENCROACH INTO THE SEAM AREA OF THE POCKET, THEN A TARGET MUST BE ADDED FIRST TO COVER FASTENERS.
3. 25 YEAR GUARANTEES AND ABOVE MUST USE EXTREME ACCESSORIES
4. APPLY EVERGUARD® TPO CUT EDGE SEALANT TO ALL CUT REINFORCED TPO EDGES (REFER TO EVERGUARD® DETAIL 115).



EverGuard
SINGLE-PLY ROOFING SYSTEMS
ROOF PENETRATION
SERIES

DRAWING #

527

SCALE
N.T.S.

SQUARE TUBE WRAP DETAIL

THIS DETAIL APPLIES TO:

ALL SYSTEMS

REVISION DATE
6-22-16

www.gaf.com
1 Campus Drive,
Parsippany, NJ 07054