

# XYZ Contractor



123 Contractor Road  
Contractor City, State, Zip  
123-456-7891

Includes



## Sample Commercial QuickMeasure Report

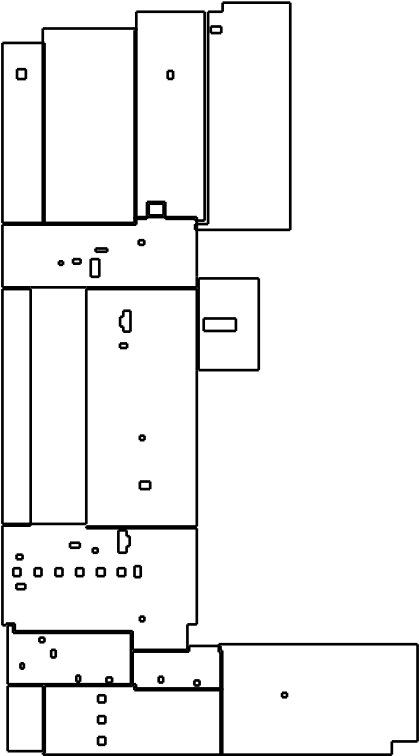

**Contents**

Overview	1
Top View	2
Side Views	3
Lengths	4
Pitches	5
Areas	6
Summary	7
Materials	8

**Measurements**

Roof Area	57,635 sq ft
Roof Facets	14
Predominant Pitch	0 / 12
Eaves	1,778 ft





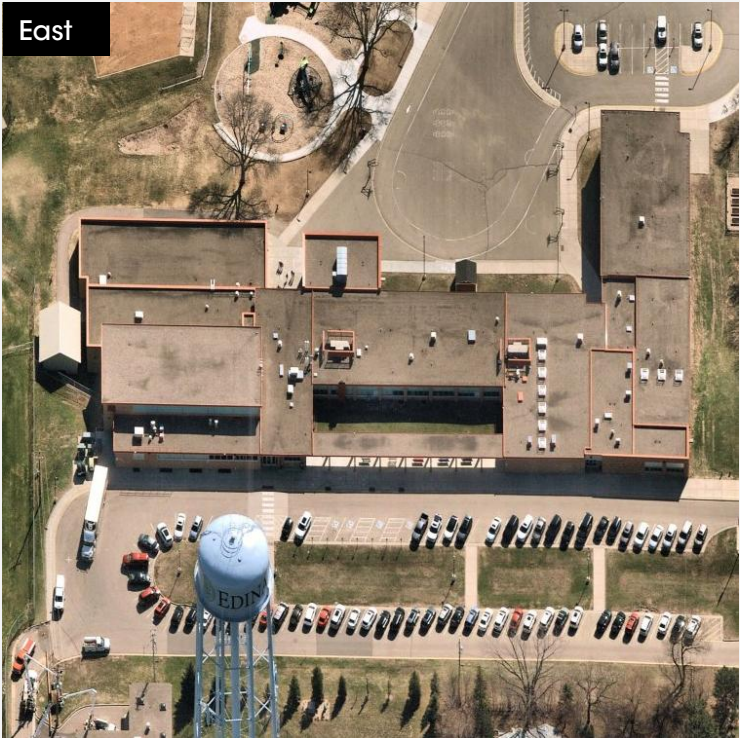



Flash	Step	Drip
1,441	0	1,778

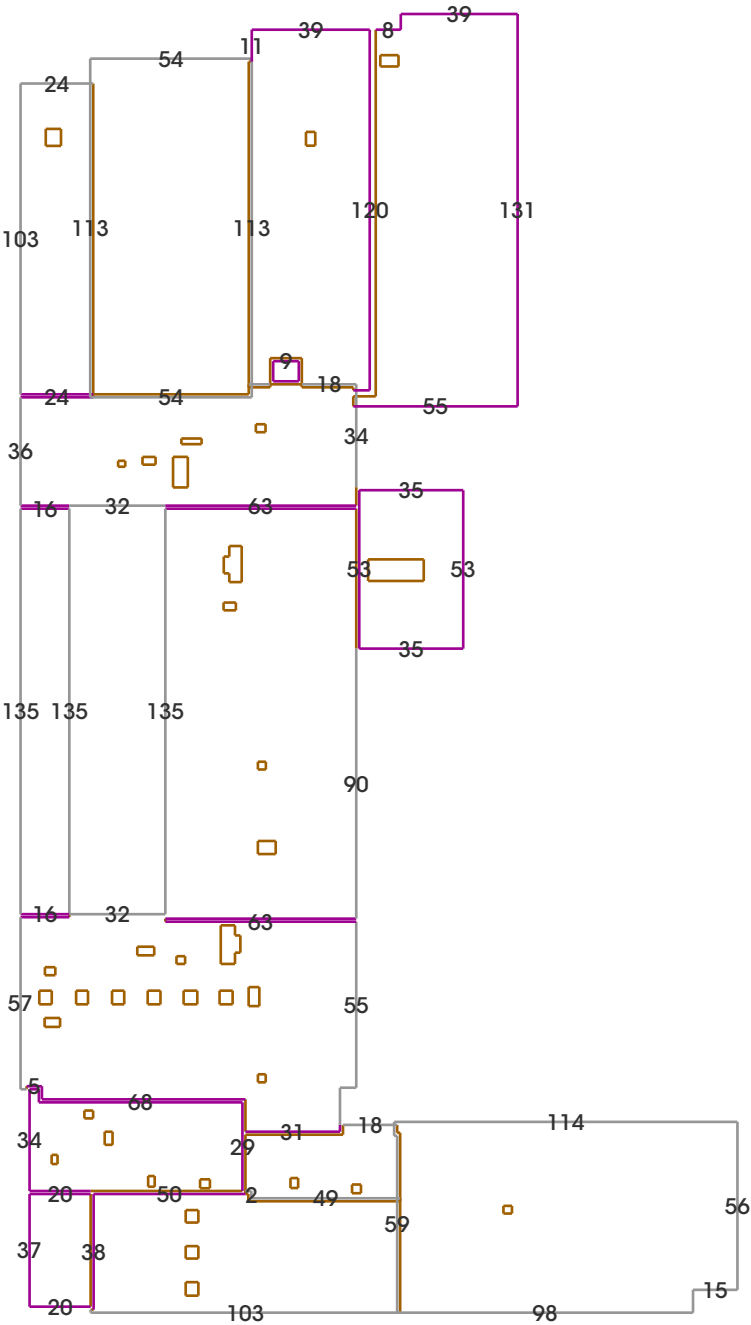

Eave	Parapet
1,778	1,422

Lengths in feet

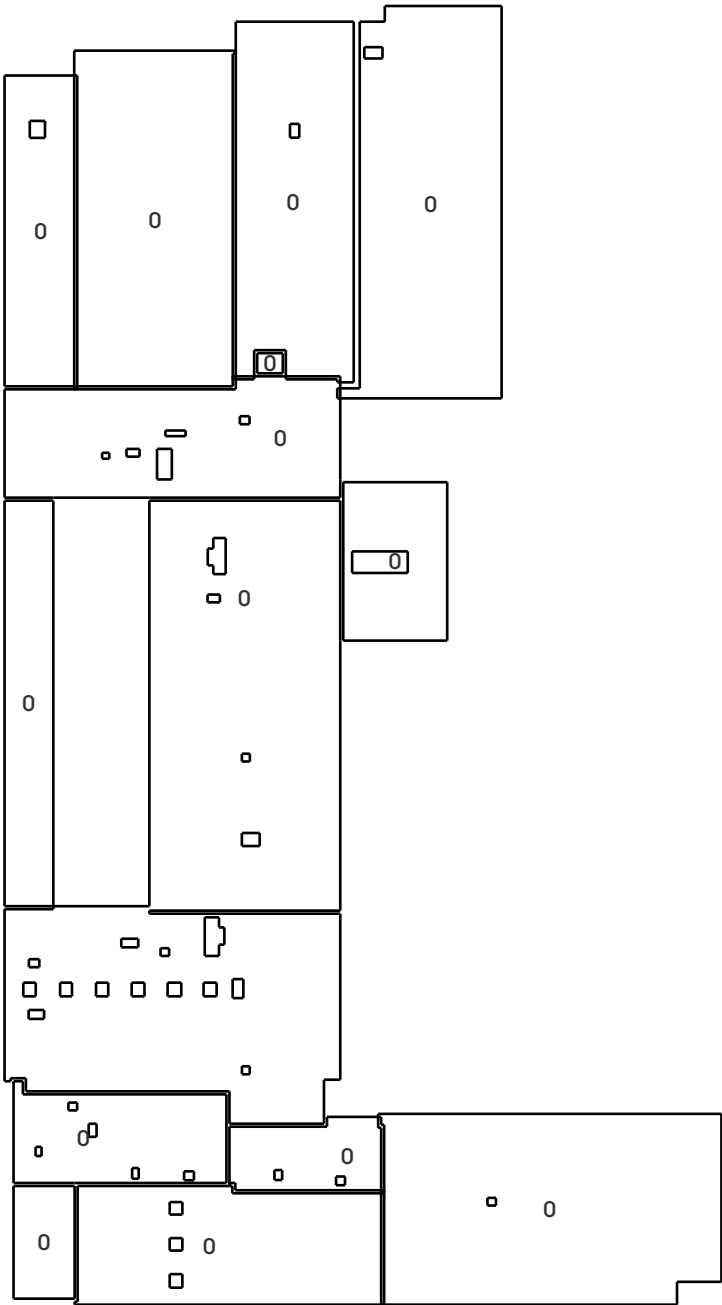

Pitches in inches per foot

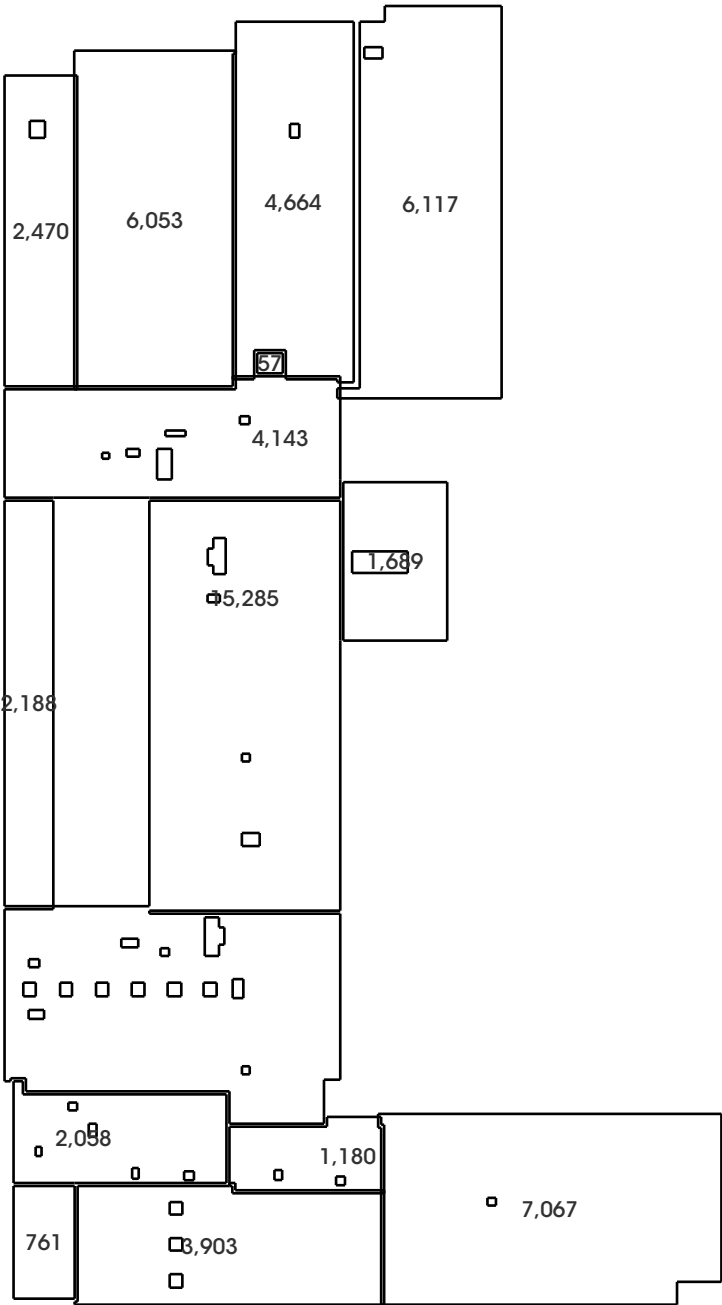

Areas in square feet





Pitch	0
Area	57,635
Percent	100%

Waste	0%	5%	10%	12%	15%	17%	20%
Area	57,635	60,516	63,398	64,551	66,280	67,432	69,161
Squares	577	606	634	646	663	675	692

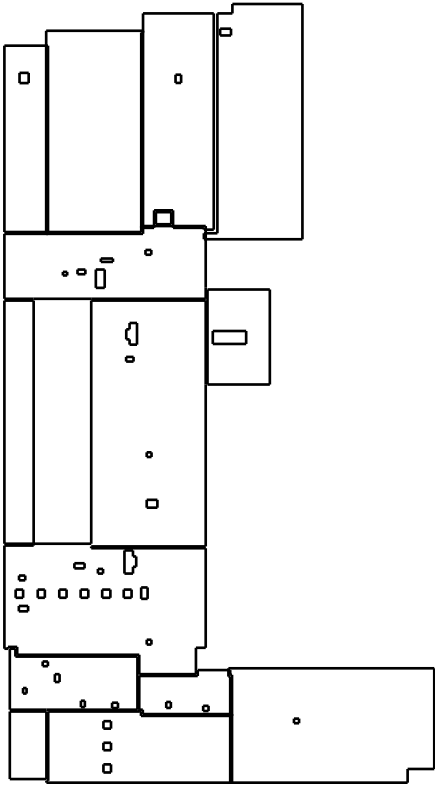

Roof Area	57,635 sq ft
Roof Facets	14
Pitch	0 / 12
Eaves	1,778 ft
Flash	1,441 ft
Drip Edge	1,778 ft
Parapets	1,422 ft
Penetrations	37
Pen. Area	772 sq ft
Pen. Perimeter	644 ft

Notes: 1) Measurements are rounded to the nearest whole number. 2) Rakes are defined as sloped roof edges. 3) Eaves are defined as level roof edges. 4) Flashing pertains to level roof edges and excludes valleys. 5) Step flashing pertains to sloped roof edges and excludes areas around penetrations. 6) Drip edge = eaves + rakes. 7) Waste table excludes additional materials needed for ridges, hips, valleys, etc. 8) Suggested waste factor is based on the roof complexity and is provided for guidance purposes only. You should confirm the appropriate waste factor prior to ordering.





Substrate	Metal			Asphalt			TPO			EPDM		
Limited Warranty Term (Years)	10	15	20	10	15	20	10	15	20	10	15	20

Premium Acrylic

Foundation Coat	-	-	-	289	289	289	289	289	289	289	289	289
Top Coat	173	231	346	173	231	346	173	231	346	173	231	346

Silicone

Unisil Low Solids	231	317	404	289	375	462	231	317	404	231	317	404
Unisil High Solids	173	231	289	202	260	289	173	231	289	173	231	289

Primers / Cleaners

Multi-Purpose Primer	-	-	-	133	133	133	-	-	-	-	-	-
Cleaning Concentrate	18	18	18	18	18	18	18	18	18	18	18	18
Metal Roof Primer	47	47	47	-	-	-	-	-	-	-	-	-
TPO Red Primer	-	-	-	-	-	-	29	29	29	-	-	-
EPDM Activator Cleaner	-	-	-	-	-	-	-	-	-	24	24	24

Quantities of 5-gallon pails

Suggested waste is 5 to 10%

Notes: 1) These approximate quantities are based on estimated measurements and are for guidance purposes only. You should always confirm quantities prior to ordering and ensure you are following local building code requirements. 2) Product quantities are listed in 5-gallon pails. Quantities are rounded up to the nearest complete pail. 3) Primers are referenced as a guide and recommended when applying to various substrates. 4) Before coating is applied, an adhesion test is required to ensure an adhesion minimum of 2.0 pounds per linear inch (PLI). Test patches should be applied with rates listed on the quick specs. 5) Applicators should account for nominal waste and soak factors in various substrates when needing to achieve wet/dry mil thickness as required by the quick specs and specifications. 6) Roof coatings product calculations are calculated for areas with a 1/12 pitch and below. 7) Refer to the limited warranty on GAF liquid-applied roof coatings, available at [gaf.com](http://gaf.com), for complete coverage and restrictions. For application rates and other requirements for system guarantees and warranties, see liquid-applied roofing manual at [gaf.com](http://gaf.com).

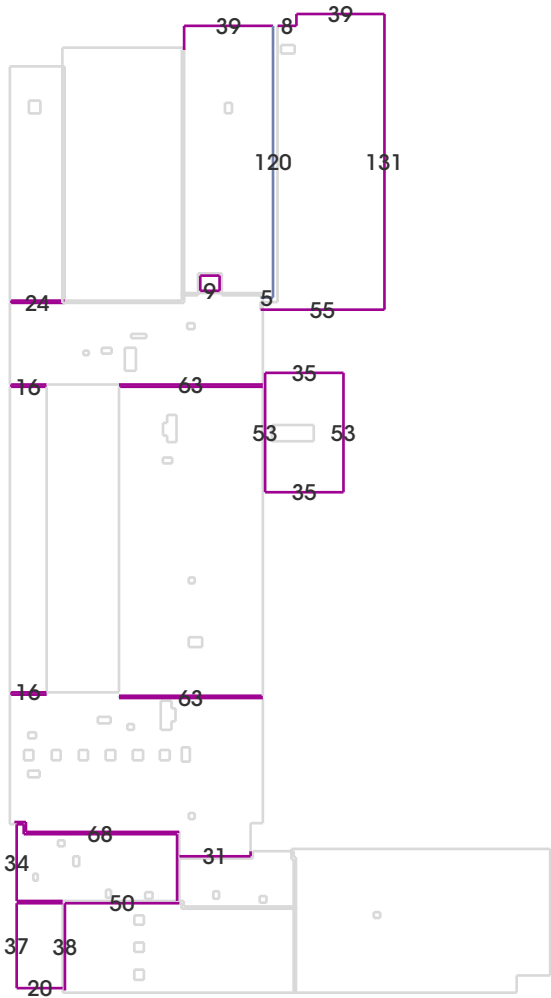

	Length (ft)	Height (in)	Vertical Area (sq ft)	Wall Width (in)
	1,296	12	1,296	12
	125	12	125	24



Flash	Step	Drip
1,441	0	1,778

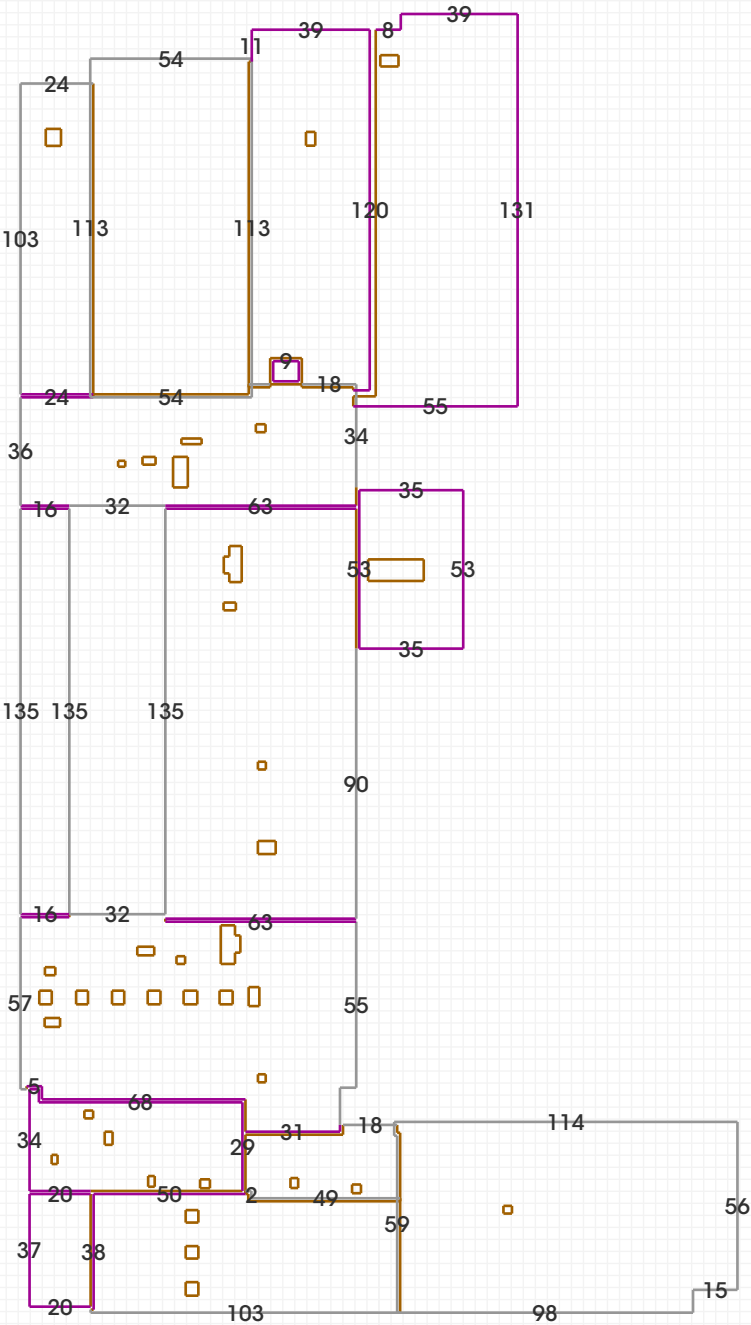

4 ft x 4 ft grid  
Lengths in feet







[View Online](#)