

**FOR JOBS UP TO 50  
SQUARES ONLY**

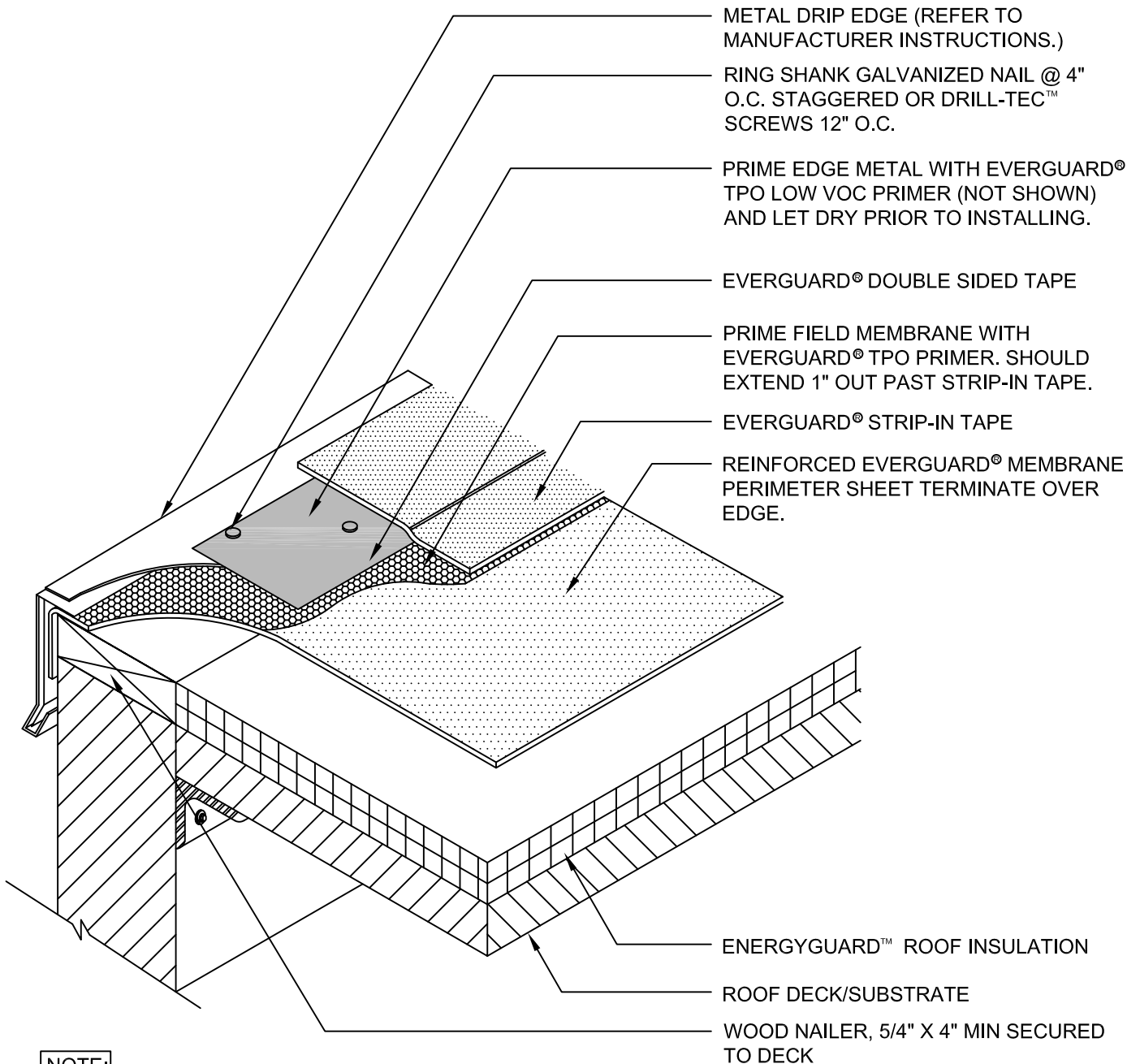

METAL DRIP EDGE (REFER TO MANUFACTURER INSTRUCTIONS.)

RING SHANK GALVANIZED NAIL @ 4" O.C. STAGGERED OR DRILL-TEC™ SCREWS 12" O.C.

PRIME EDGE METAL WITH EVERGUARD® TPO LOW VOC PRIMER (NOT SHOWN) AND LET DRY PRIOR TO INSTALLING.

EVERGUARD® DOUBLE SIDED TAPE

PRIME FIELD MEMBRANE WITH EVERGUARD® TPO PRIMER. SHOULD EXTEND 1" OUT PAST STRIP-IN TAPE.

EVERGUARD® STRIP-IN TAPE

REINFORCED EVERGUARD® MEMBRANE PERIMETER SHEET TERMINATE OVER EDGE.

ENERGYGUARD™ ROOF INSULATION

ROOF DECK/SUBSTRATE

WOOD NAILER, 5/4" X 4" MIN SECURED TO DECK

**NOTE:**

1. THIS DETAIL IS NOT TO BE USED ON SLOPES GREATER THAN 1/12.
2. APPLY TOPCOAT® FLEXSEAL™ CAULK GRADE TO ALL EVERGUARD® STRIP-IN TAPE EDGES.
3. MEMBRANE AND METAL MUST BE PRIMED AND DRY PRIOR TO APPLYING EVERGUARD® DOUBLE SIDED TAPE.



**EverGuard**  
SINGLE-PLY ROOFING SYSTEMS  
ROOF EDGE SERIES

DRAWING #  
**713**

**ROOF EDGE WITH  
STRIP-IN TAPE DETAIL**

THIS DETAIL APPLIES TO:  
**Taped Seam  
Systems**

www.gaf.com  
1 Campus Drive,  
Parsippany, NJ 07054

SCALE  
N.T.S.

REVISION DATE  
5-1-15