

RAPID SEAM™ MAX 10 YR GUARANTEE

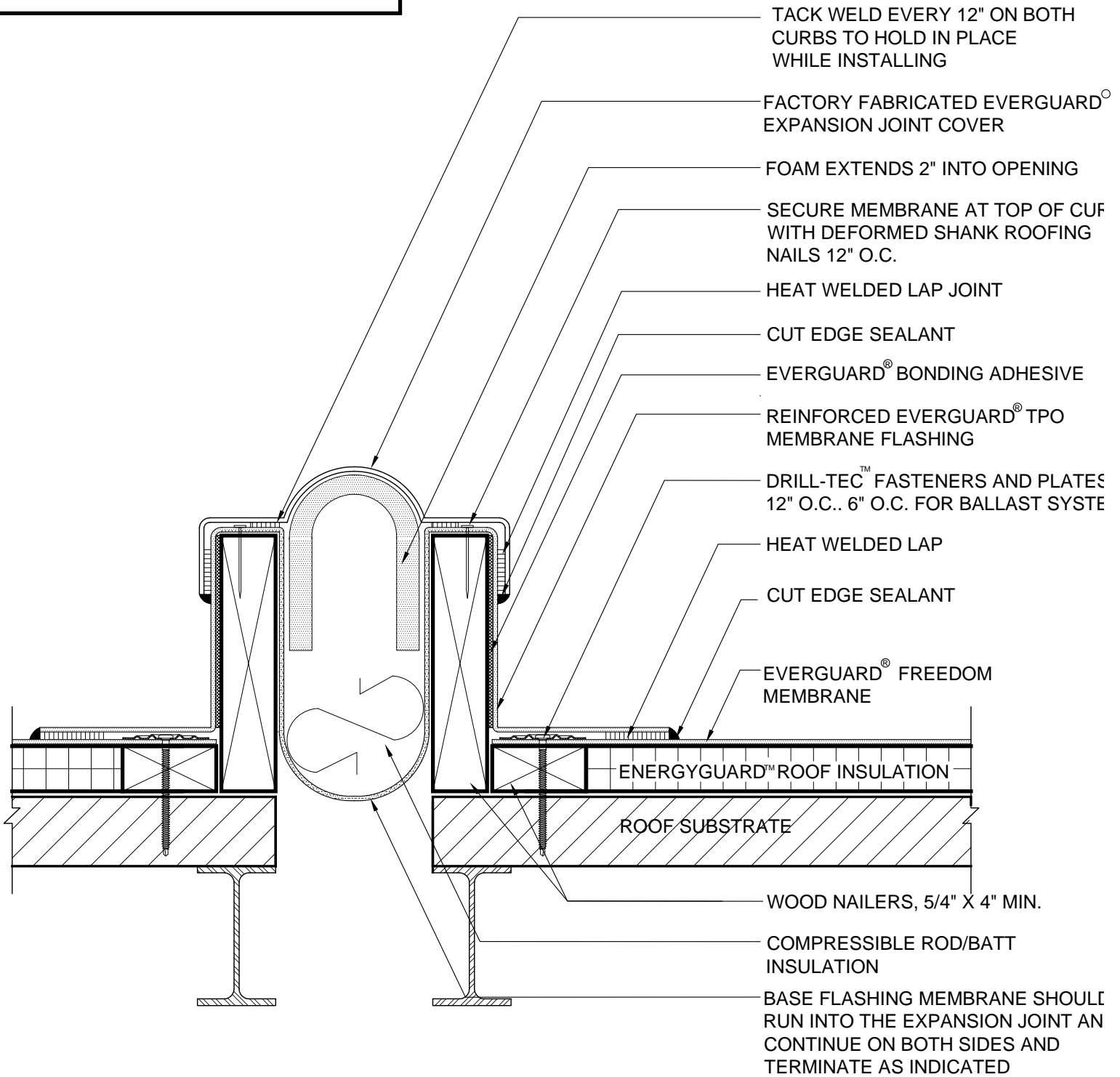

NOTE:

1. ALL FLASHINGS ON EXPANSION JOINTS MUST BE ADHERED.
2. APPLY EVERGUARD® TPO CUT EDGE SEALANT TO ALL CUT REINFORCED TPO EDGES (REFER TO DETAIL FD 115).



EverGuard® Freedom
Self-Adhering Roofing System

EXPANSION JOINT SERIES

FACTORY FABRICATED EXPANSION JOINT DETAIL- CURB TYPE

RAPID SEAM & HEATWELD

DRAWING #
402A

SCALE
N.T.S.

SYSTEM
FD

ISSUE/ REVISION DATE
3-1-10