

ALTERNATE INSTALLATION

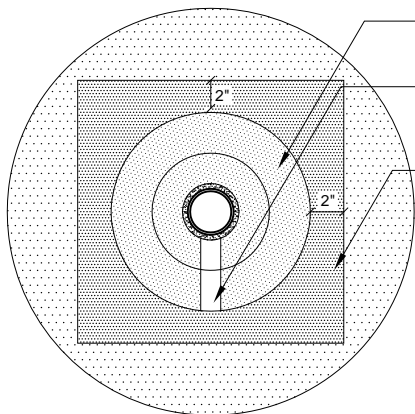

SEE NOTE #2

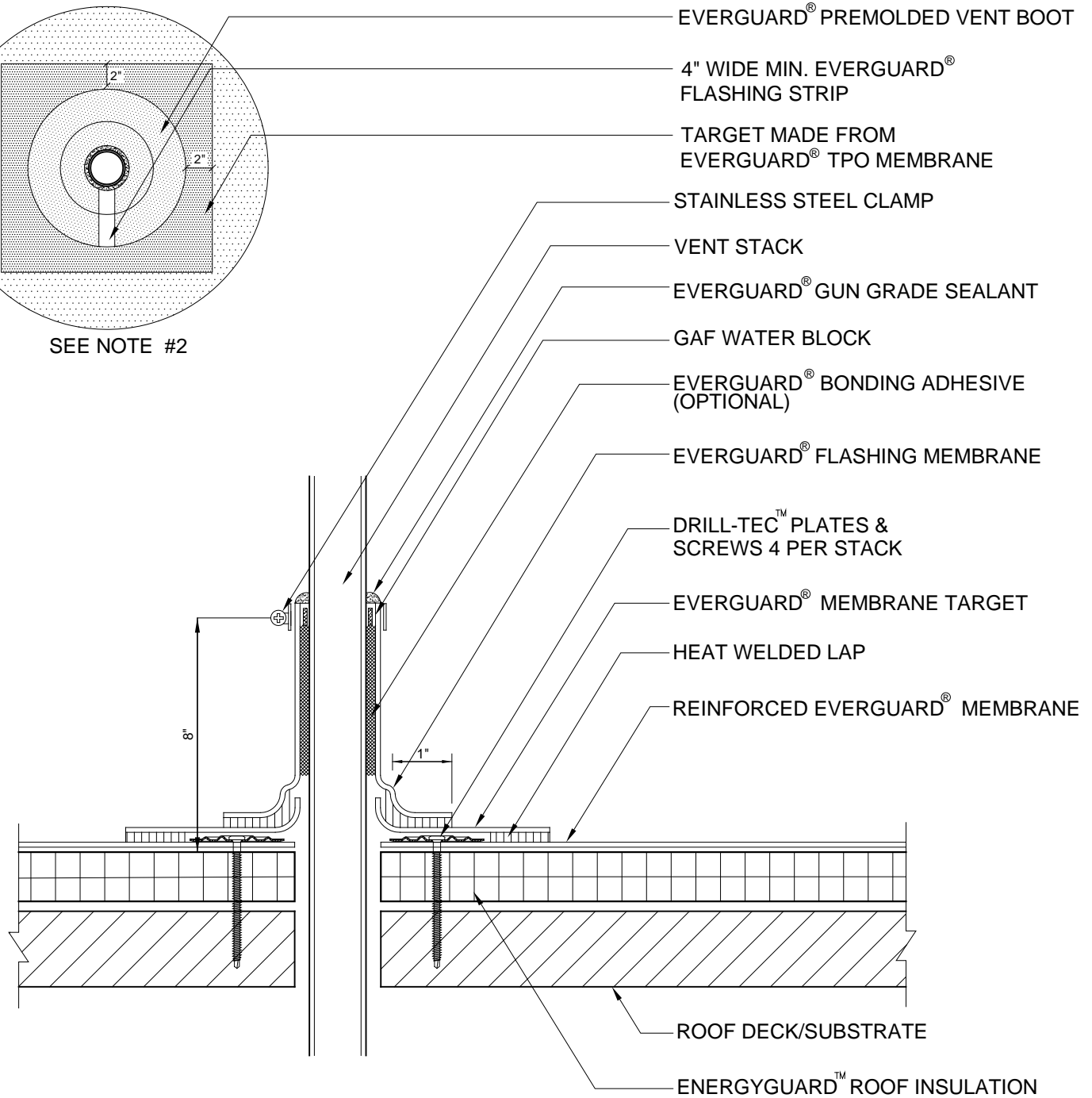

NOTE:

1. IF TARGET MEMBRANE MUST BE SPLIT TO FIT AROUND STACK, A MIN. 4" WIDE EVERGUARD® FLASHING STRIP MUST BE HEAT WELDED OVER SPLIT.
2. IF THE PLATES AND FASTENERS INTRUDE INTO BOOT FLANGE AREA, THEN A TARGET MUST FIRST BE INSTALLED OVER PLATES AND FASTENERS BEFORE BOOT INSTALLATION.
3. APPLY HEAT TO UNREINFORCED FLASHING AND FORM BY HAND PRIOR TO HOT AIR WELDING.
4. APPLY EVERGUARD® TPO AND PVC CUT EDGE SEALANT TO ALL CUT REINFORCED TPO AND PVC EDGES (REFER TO DETAIL MA/FA/BA 115).



ROOF PENETRATION SERIES

FIELD-WRAPPED PENETRATION FLASHING

DRAWING #

507

SCALE

N.T.S.

SYSTEM

MA/FA/BA

ISSUE/REVISION DATE

3-01-10