

REINFORCED EVERGUARD[®] MEMBRANE

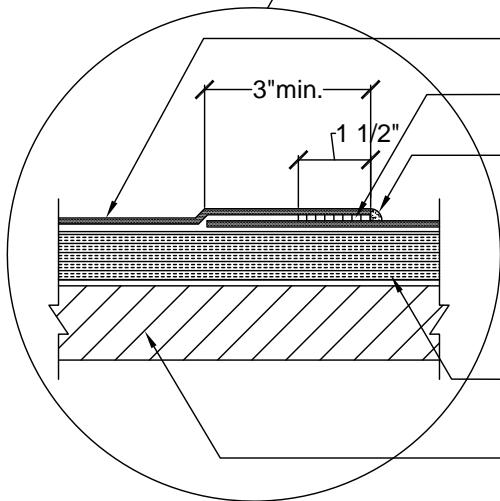

REINFORCED EVERGUARD[®] MEMBRANE

HEAT WELDED LAP

EVERGUARD[®] CUT EDGE SEALANT

ENERGYGUARD[™] ROOF INSULATION

ROOF DECK/SUBSTRATE

NOTE:

1. FOR HEAT WELDING LAPS USE 1-1/2" WELD WITH AUTOMATIC MACHINE WELDER AND 2" WELD WITH HAND WELDER.
2. T-JOINTS REQUIRED ON 60 & 80 MIL TPO AND 80 MIL PVC. (REFER TO MA/FA/BA 105)
3. APPLY EVERGUARD[®] TPO AND PVC CUT EDGE SEALANT TO ALL CUT REINFORCED TPO AND PVC EDGES (REFER TO DETAIL MA/FA/BA 115).



www.gaf.com
1361 Alps Rd.
Wayne, NJ 07470



FIELD OF ROOF
SERIES

END LAP DETAIL

FOR 45 MIL TPO AND 60 MIL PVC MEMBRANE

DRAWING #

104

SCALE

N.T.S.

SYSTEM

MA/FA/BA

ISSUE/ REVISION DATE

7-01-11