

GAF PERIMETER EDGE METAL



Internal metal chair drainage system eliminates caulked joints.

True welded radius, matching corners, end caps, and other accessories are factory fabricated.

Pre-punched holes and supplied fasteners for proper attachment.

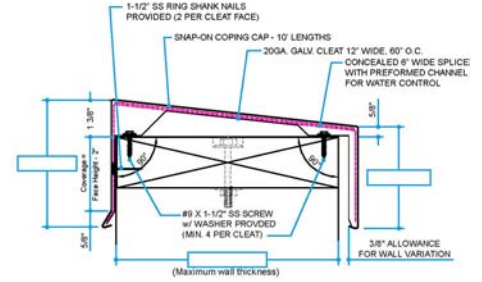

M-Weld Snap-on Coping

The coping utilizes a metal chair which functions as both a gutter chair with its raised ribs and as an internal splice plate in the same color and finish as the coping cap. Standard 20 Gauge galvanized steel cleat. A heavy 16 gauge cleat is available for high wind areas.

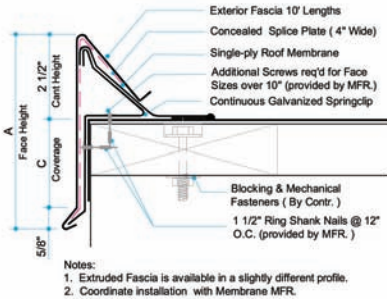

Snap-on system that doesn't require field crimping assuring fast, clean installation.

Stainless steel ring shank roofing nails provided for maximum hold power with pre-punched fastener holes.



EverGuard Snap-on Fascia

EverGuard fascia system is the ideal low-cost solution for EPDM or single ply 60 mil thick or less.



Clamps single ply membrane against building perimeter like a termination bar.

Allows use of high-torque screws (provided) without penetrating top surface of membrane.

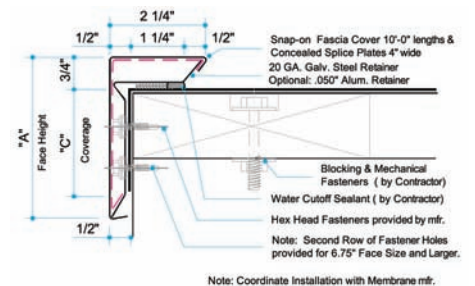

EverGuard EZ Fascia

This classic product features a two-piece design with a snap-on fascia and rigid termination bar to assure wind and water stay out of the roof membrane.

GAF Materials Corporation
1361 Alps Road, Wayne, NJ 07470
Phone: 800-477-2741 • Fax: 283-4289

GAF® Quality You Can Trust
Since 1886...from
North America's Largest
Roofing Manufacturer
GAF MATERIALS CORPORATION

GAF PERIMETER EDGE METAL



Clamps single ply roof membrane against building like a termination bar preventing leaks and blow-offs.

Extruded retainer in three sizes: 3.75" for one nailer, 5.25" for two nailers and 6.75" for three nailers of coverage.

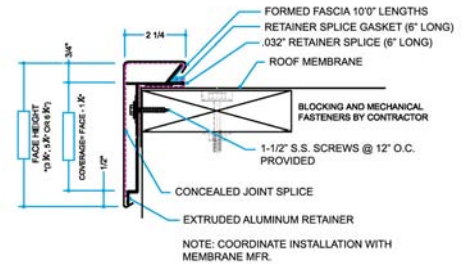

EverGuard EZ Fascia EX

For those who prefer an extruded retainer, you now have a choice with EverGuard EZ Fascia EX.

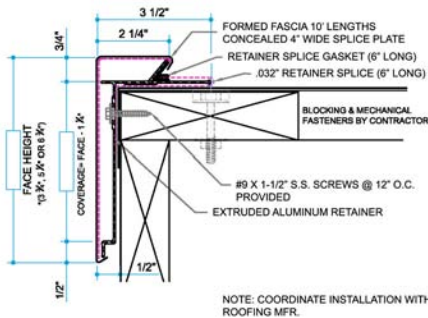

Clamps BUR or Modified Bitumen plies like a termination bar preventing leaks and blow-offs.

Extruded retainer available for standard face sizes 3.75", 5.25", 6.75" and 8.25".



M-Weld EZ Fascia EX

M-Weld EZ Fascia EX for Mod Bit retainer features a wide base flange to securely hold down BUR and Modified roofing plies.



Gravel stop style (at left) to retain gravel and water or Box style (at right) for easy drainage.

Modified Bitumen Roofing plies bond together through metal flange to create exceptional seal.

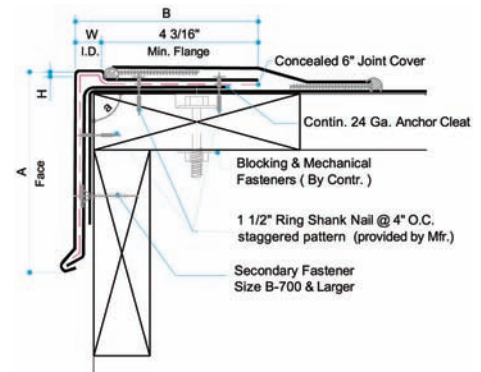

M-Weld Gravel Stop MB Fascia

The M-Weld Gravel Stop MB system uses a continuous pattern of offset holes in the flange through which two layers of roofing plies can bond together, sandwiching the metal flange between them.

GAF PERIMETER EDGE METAL

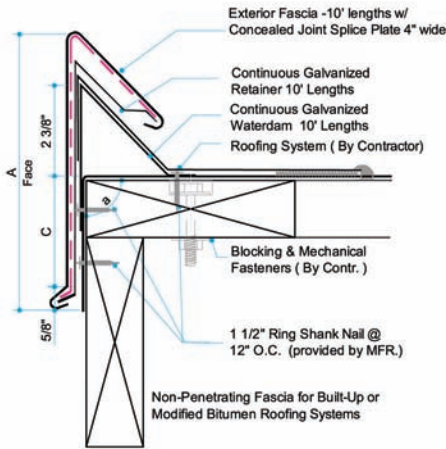

M-Weld Gravel Guard MB is a three-part system consisting of a continuous galvanized steel water dam, exterior fascia, and a continuous galvanized steel retainer to lock the assembly together.



M-Weld Gravel Guard MB Fascia

M-Weld Gravel Guard MB Fascia grips the roofing plies without the need for exposed fasteners.



M-Weld Gravel Guard MB is a three-part system consisting of a continuous galvanized steel water dam, exterior fascia, and a continuous galvanized steel retainer to lock the assembly together.

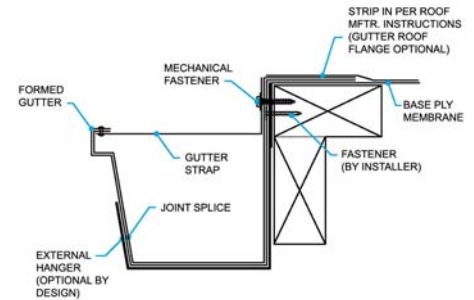

Formed Gutter with optional Drain Thru Gravel Stop

Formed gutter is custom sized to meet your special requirements. Designed with internal straps for smooth, clean lines and ease of installation. External hangers are optional.

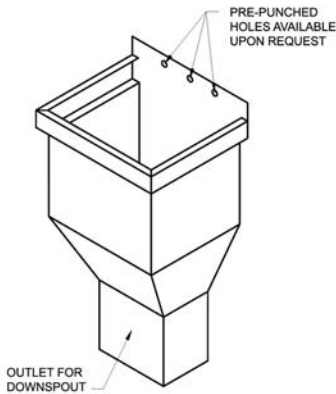

Conductor heads and scuppers are factory fabricated in the size and shape to meet your unique requirements. Blanks are cut using computer controlled equipment for precise, professional appearance.

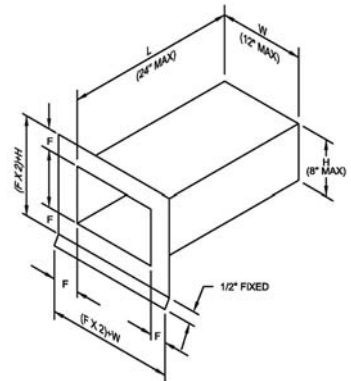

Conductor Heads and Scuppers

Conductor Heads and Scuppers are factory welded from .050" or .063" aluminum and in your choice of finish.

GAF PERIMETER EDGE METAL

Standard Colors and Materials

Kynar 500® Aluminum & Galvanized Steel Pre-finished Colors

Available in .032", .040", .050" Aluminum and 24ga, G-90 galvanized steel.

***Seven colors** also available in pre-finished .063" aluminum.

Color samples printed here are approximations. For exact colors, request actual metal color sample chips. Color cards are available by request.

Pre-finished aluminum and galvanized steel coated with Kynar® 500 covered by 20-year limited warranty.



A-01* Statuary Bronze



A-07 Mission Red



A-13 *Forest Green



A-21 Slate Blue



A-02 Concord Cream



A-08 Black



A-14 Patina Green



A-22 Mint Green



A-03 Redwood



A-09 *Dove Gray

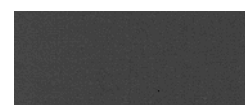

A-15 Rocky Gray



A-23 * Bone White



A-04 Siam Blue



A-10 Rawhide



A-18 Regal Blue



A-24 Hartford Green



A-05 *Medium Bronze



A-11 Chocolate Brown



A-19 Turquoise



A-25 Boysenberry

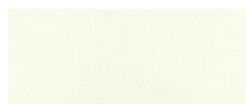

A-06 *Sandstone

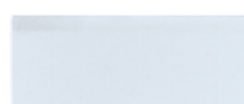

A-12 *Ascot White



A-20 Shale Gray

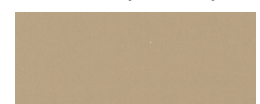

A-26 Sierra Tan

Materials and Finishes

GAF offers 24 standard colors of coil coated Kynar 500® on steel and aluminum in 24 gauge galvanized steel, .032", .040" and .050" aluminum. In addition, the seven colors marked with an asterisk are available in .063" aluminum. Paint grip galvanized steel, copper, and 304 2B stainless are available by request.

Kynar 500® fluoropolymer coating is a high-performance architectural finish offering unparalleled resistance to weathering, aging and pollution. Post-finished Kynar is available in a wide range of colors. A limited twenty (20) year warranty is available on the standard coil-coated colors shown above. A limited ten (10) year warranty is available on custom post-coated applications.

GAF offers anodized finishes in clear, medium bronze, dark bronze and black. Anodize is available as coil coated or batch anodize process.

Important Note: Due to shade variations in the anodizing process, it is recommended that the contractor work with the architect or building owner to sort and install products in the arrangement best suited to the owners preference. GAF offers no warranty to anodize finishes and will not be held responsible for shade variation inherent in the anodize process.

Kynar 500® Finish carries a warranty against cracking, fading and chalking. Coated materials are non-staining and virtually maintenance free. Any surface residue is easily removed with mild, non-abrasive detergents. Minor scratches may be touched up with an air dry touch-up of the same color. Kynar 500® is a registered trademark of Atofina Chemicals, Inc.

GAF Materials Corporation

1361 Alps Road, Wayne, NJ 07470

Phone: 800-477-2741 • Fax: 283-4289



Quality You Can Trust
Since 1886...from
North America's Largest
Roofing Manufacturer

GAF MATERIALS
CORPORATION