

INTERMITTENT
FASTENING KEY
54" WITH BONDING
ADHESIVE
24" DRY

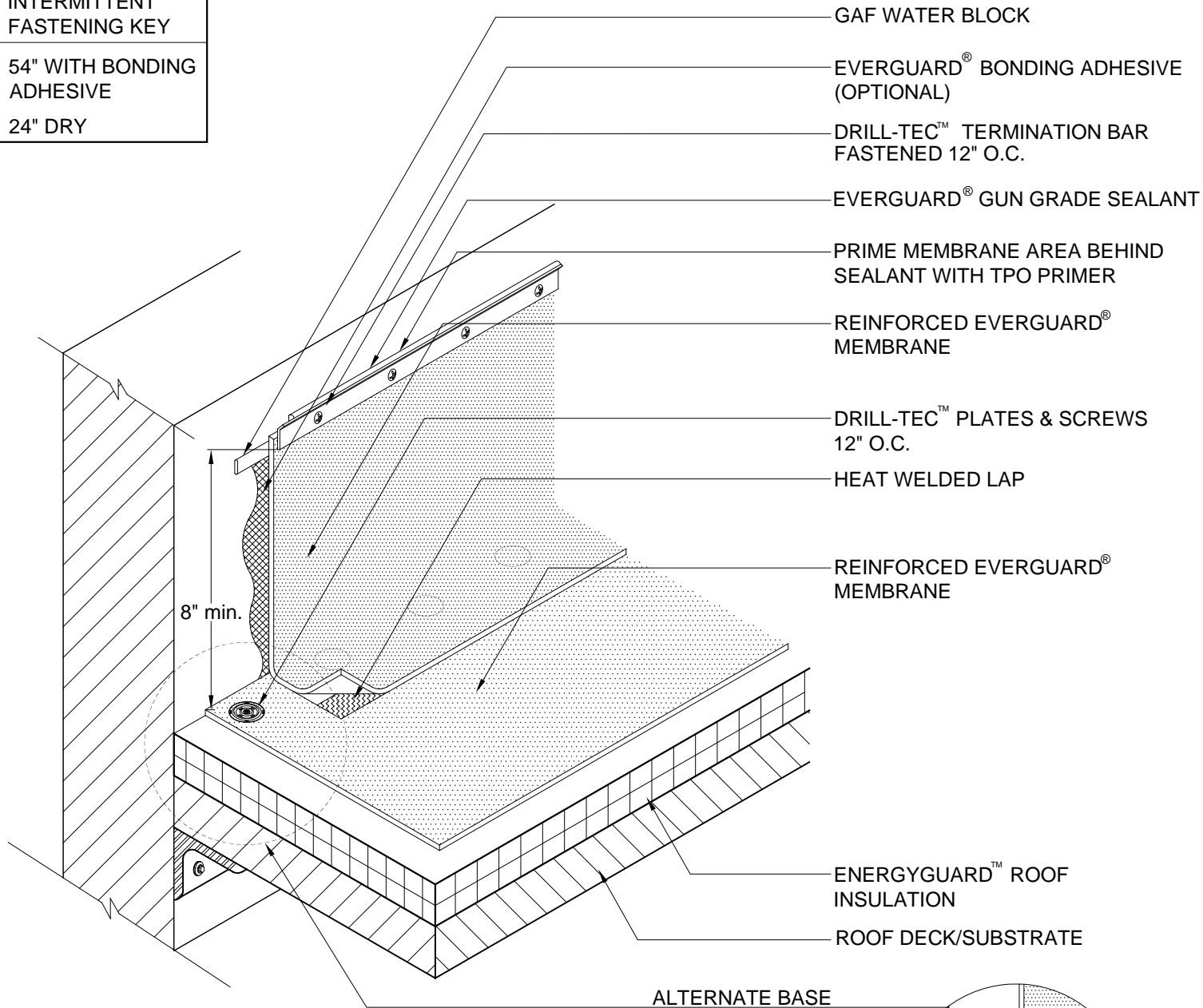

ALTERNATE BASE
REFER TO DETAIL 307

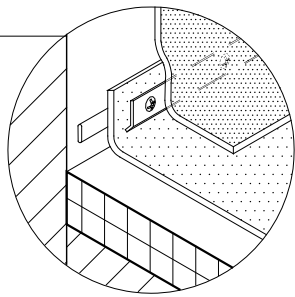

NOTE:

1. STONE/PAVER BALLAST (NOT SHOWN) REQ'D FOR BA SYSTEMS.
2. PLATES & SCREWS 6" O.C. REQ'D FOR BA SYSTEMS.
3. INCREASED FASTENING TO 6" O.C. MAY BE REQUIRED TO KEEP CONSTANT COMPRESSION OF BAR TO WALL.
4. FOR INSULATION THICKNESS GREATER THAN 8" CONTACT GAFMC CONTRACTOR SERVICES FOR ALTERNATE MEMBRANE ATTACHMENT REQUIREMENTS.FOR ALTERNATE ATTACHMENT REQUIREMENTS. THESE METHODS MAY INCLUDE THE USE OF A HARD BOARD COVERING THE ASSEMBLY.
5. APPLY EVERGUARD® TPO AND PVC CUT EDGE SEALANT TO ALL CUT REINFORCED TPO AND PVC EDGES (REFER TO DETAIL MA/FA/BA 115).

15 YEAR MAX
WARRANTY



**WALL/CURB FLASHING WITH
TERMINATION BAR DETAIL**

DRAWING #	SYSTEM
302	MA/FA/BA
SCALE	ISSUE/ REVISION DATE
N.T.S.	6-01-10