

UNREINFORCED T-JOINT
COVER PATCHES MIN. 4" IN
DIAMETER. (NOTE: NOT
REQUIRED IF USING
EVERGUARD FLASHING
MEBRANE

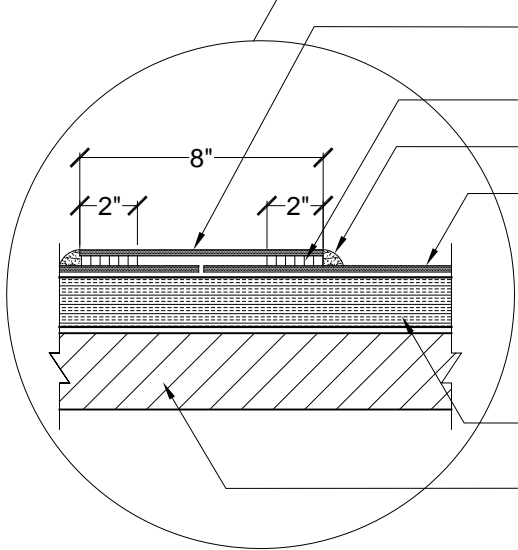

8" REINFORCED EVERGUARD® MEMBRANE OR EVERGUARD
FLASHING MEMBRANE
HEAT WELDED LAP
EVERGUARD® CUT EDGE SEALANT
REINFORCED EVERGUARD® FLEECE-BACK MEMBRANE SHEET
ENERGYGUARD™ ROOF INSULATION
ROOF DECK/SUBSTRATE

NOTE:

1. THE FOLLOWING APPLIES FOR MA SYSTEMS ONLY: FOR INSULATION THICKNESSES GREATER THAN 8" CONTACT GAF CONTRACTOR SERVICES FOR ALTERNATE ATTACHMENT REQUIREMENTS. THESE METHODS MAY INCLUDE THE USE OF A HARD BOARD COVERING THE ASSEMBLY.
2. FOR HEAT WELDING LAPS, USE 1 1/2" WELD WITH MACHINE ROBOT WELDER AND 2" WELD WITH HAND WELDER.
3. APPLY EVERGUARD® TPO AND PVC CUT EDGE SEALANT TO ALL CUT REINFORCED TPO AND PVC EDGES (REFER TO DETAIL MA/FA/BA 115).



FIELD OF ROOF
SERIES

COVER STRIP END LAP DETAIL

FOR FLEECEBACK MEMBRANE ONLY

DRAWING #

103

SCALE

N.T.S.

SYSTEM

MA/FA/BA

ISSUE/REVISION DATE

9-01-09