

**FOR JOBS UP TO 50
SQUARES ONLY**

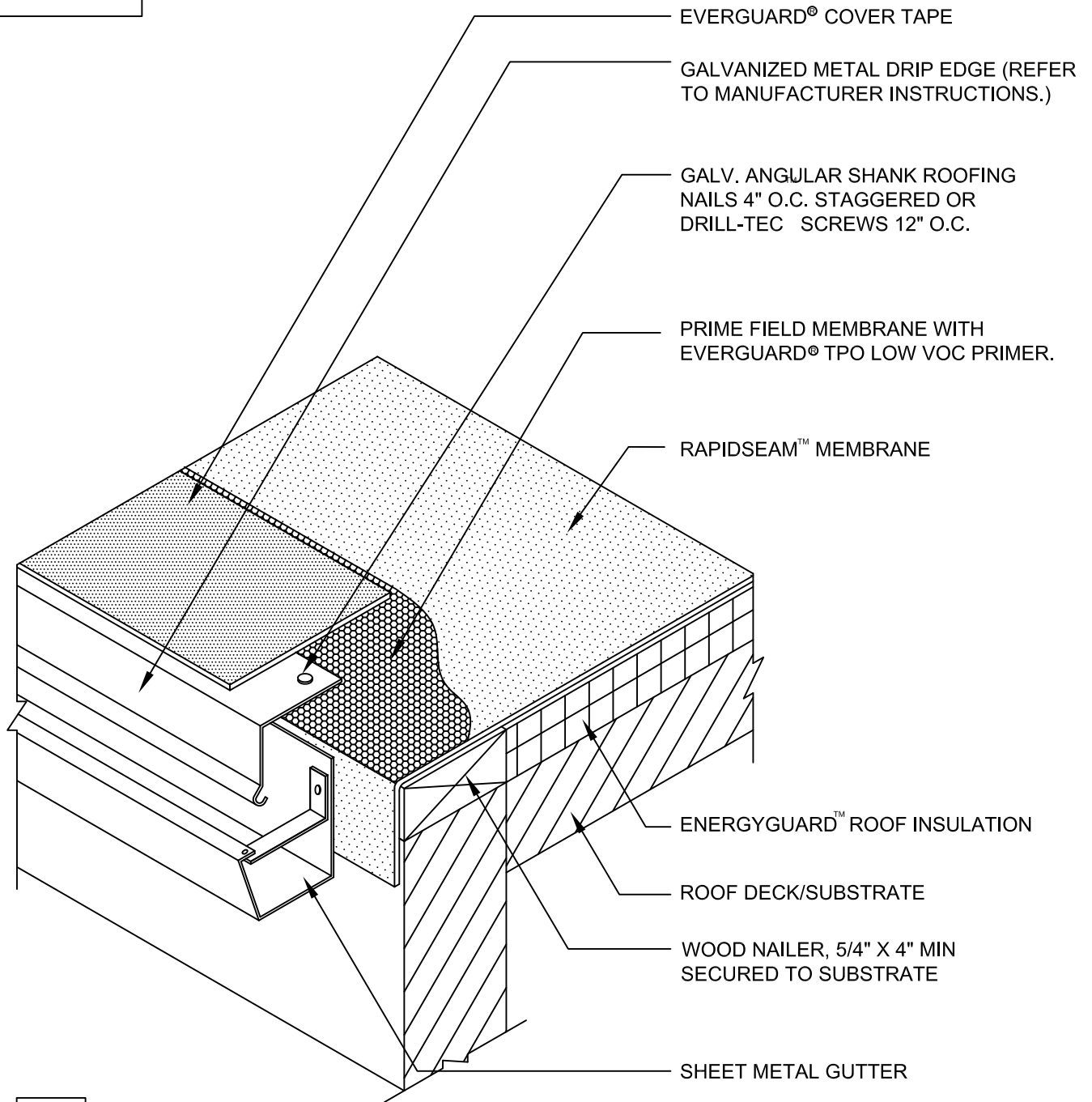

NOTE:

1. BE SURE TO CLEAN METAL AND MEMBRANE WITH EVERGUARD® TPO SEAM CLEANER BEFORE PRIMING.
2. APPLY FLEXSEAL™ CAULK GRADE SEALANT TO ALL EVERGUARD® STRIP-IN TAPE EDGES.
3. MEMBRANE MUST BE PRIMED AND DRY PRIOR TO APPLYING EVERGUARD® DOUBLE SIDED TAPE.
4. HANGERS MUST TERMINATE INTO FASCIA, NOT INTO ROOF SURFACE



EverGuard
SINGLE-PLY ROOFING SYSTEMS
ROOF EDGE SERIES

DRAWING #

711

GUTTER EDGE DETAIL

THIS DETAIL APPLIES TO:

**RapidSeam
Systems**

www.gaf.com
1 Campus Drive,
Parsippany, NJ 07054

SCALE
N.T.S.

TPO ONLY

REVISION DATE
5-26-16