

**RAPID SEAM™  
MAX 10 YR  
GUARANTEE**

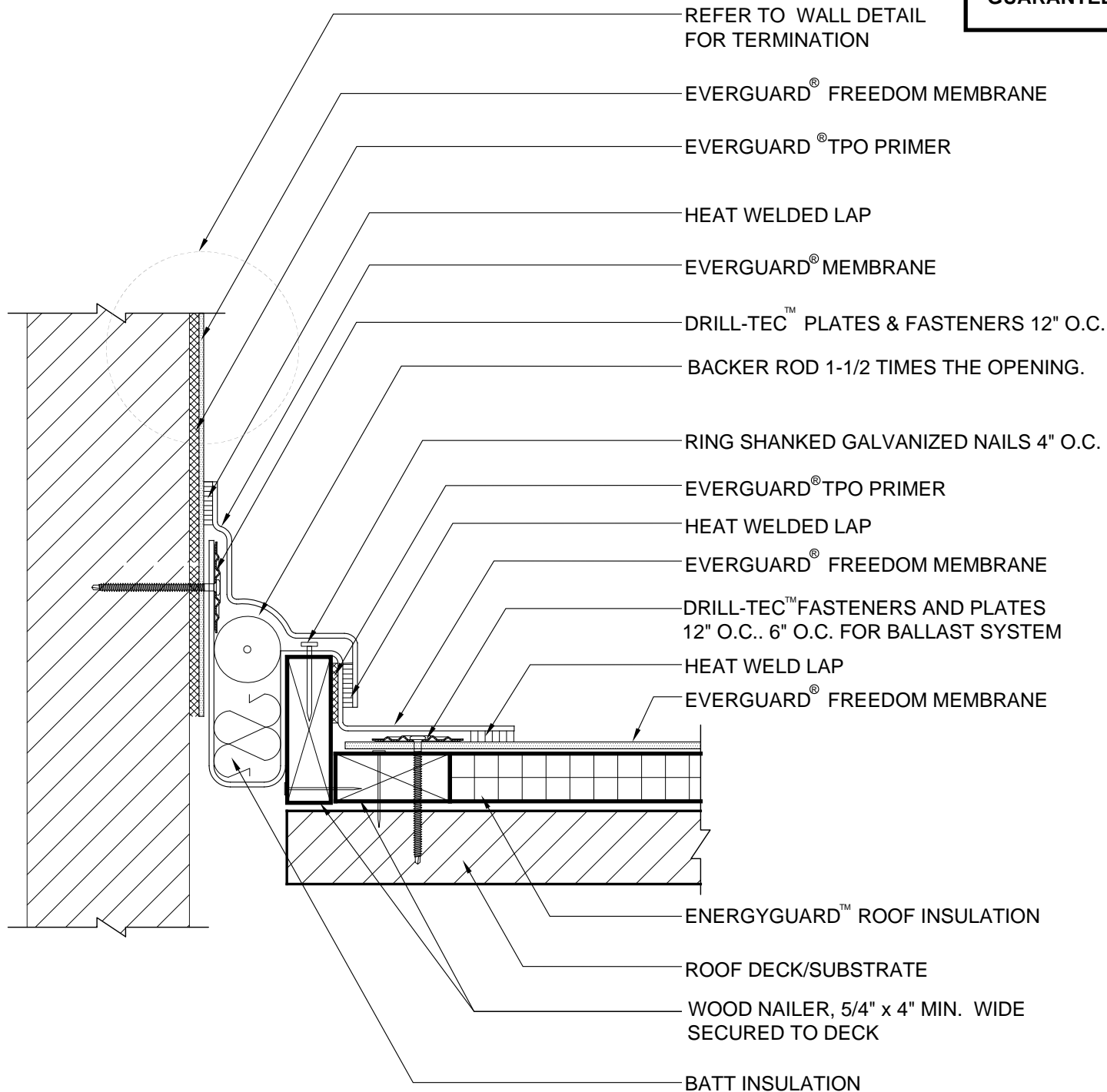

**NOTE:**

1. FIELD FABRICATED EXPANSION JOINT SHOULD NOT BE FLEECE-BACK OR SELF ADHERING MEMBRANE. USE STANDARD EVERGUARD MEMBRANE
2. APPLY EVERGUARD® TPO AND PVC CUT EDGE SEALANT TO ALL CUT REINFORCED TPO AND PVC EDGES ( REFER TO DETAIL MA/FA/BA 115 ).



**EverGuard® Freedom™**  
Self-Adhering Roofing System

EXPANSION JOINT SERIES

**FIELD FABRICATED WALL EXPANSION JOINT DETAIL - CURB TYPE**

RAPID SEAM & HEATWELD

DRAWING #  
**404B**

SCALE  
N.T.S.

SYSTEM  
**FD**

ISSUE/ REVISION DATE  
**3-1-10**