

**20 YEAR MAX  
GUARANTEE**

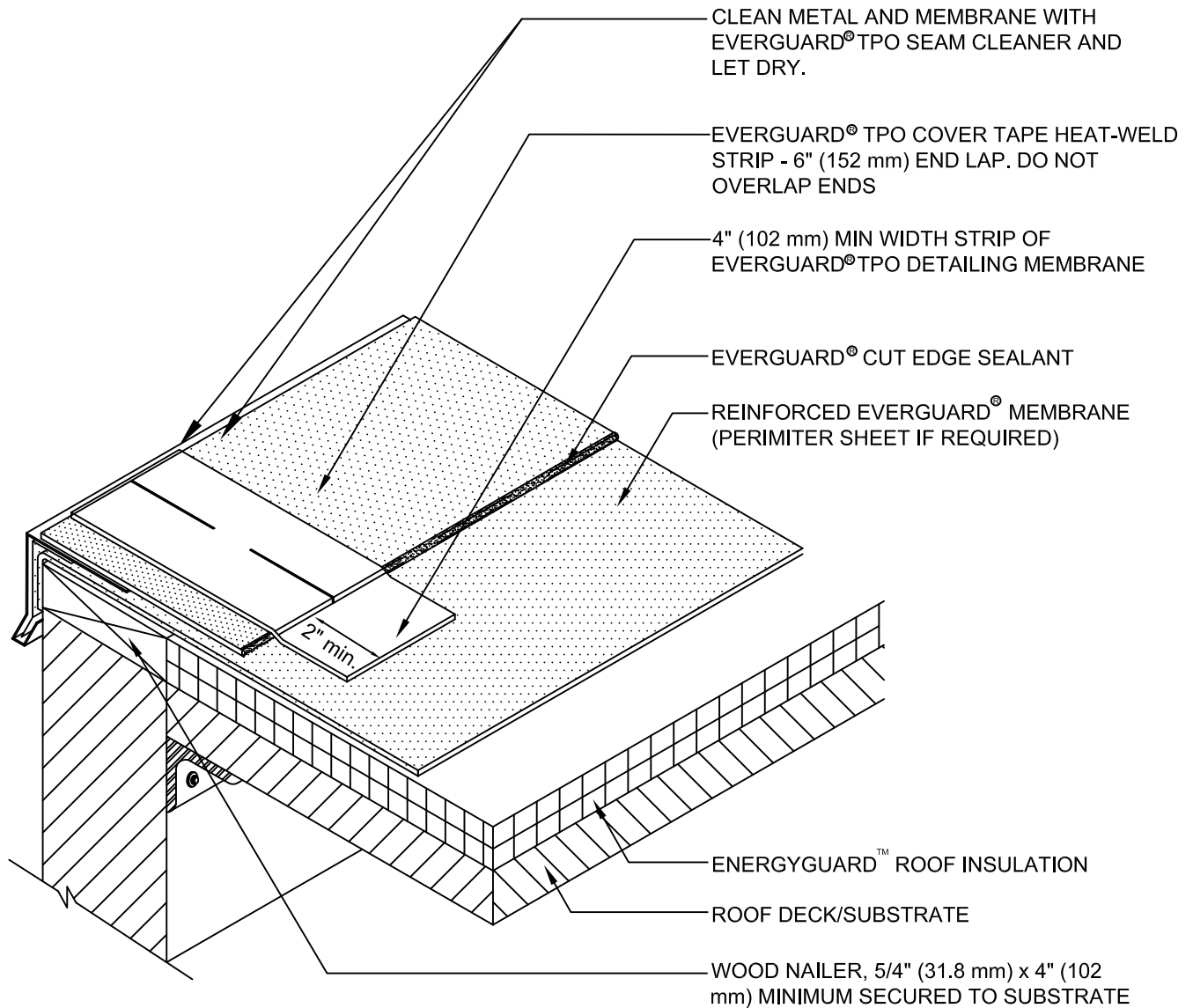

**NOTE:**

1. EVERGUARD® TPO COVER TAPE HEATWELD STRIP ONLY TO BE USED WITH TPO MEMBRANE SYSTEMS ONLY.
2. PRIME THE METAL ONLY WITH EVERGUARD TPO PRIMER. DO NOT SPILL PRIMER ON WELDED SEAM AREA.
3. HEAT WELD THE MEMBRANE (NON-ADHESIVE SIDE ONLY) TO MEMBRANE AREA USING EITHER A ROBOTIC OR HAND WELDER TO SPEC.
4. REFER TO DETAIL 218 FOR EVERGUARD® COVER TAPE HEATWELD ROOF EDGE INSTALLATION.
5. FOR INSULATION THICKNESS GREATER THAN 8" (203 mm), A HARD BOARD IS REQUIRED ON MECHANICALLY FASTENED SYSTEMS ONLY.
6. APPLY EVERGUARD® TPO CUT EDGE SEALANT TO ALL CUT REINFORCED TPO EDGES (REFER TO EVERGUARD® DETAIL 115).



**EverGuard**  
SINGLE-PLY ROOFING SYSTEMS  
ROOF EDGE SERIES

DRAWING #

**219**

**COVER TAPE HEATWELD STRIP  
END JOINT AT ROOF EDGE DETAIL**

**THIS DETAIL APPLIES TO:**  
Adhered Systems  
Self - Adhered Systems  
TriPosite Systems  
Mechanically Attached Systems

www.gaf.com  
1 Campus Drive,  
Parsippany, NJ 07054

SCALE  
N.T.S.

REVISION DATE  
6-20-16