

**20-YEAR MAX
GUARANTEE**

TPO ONLY

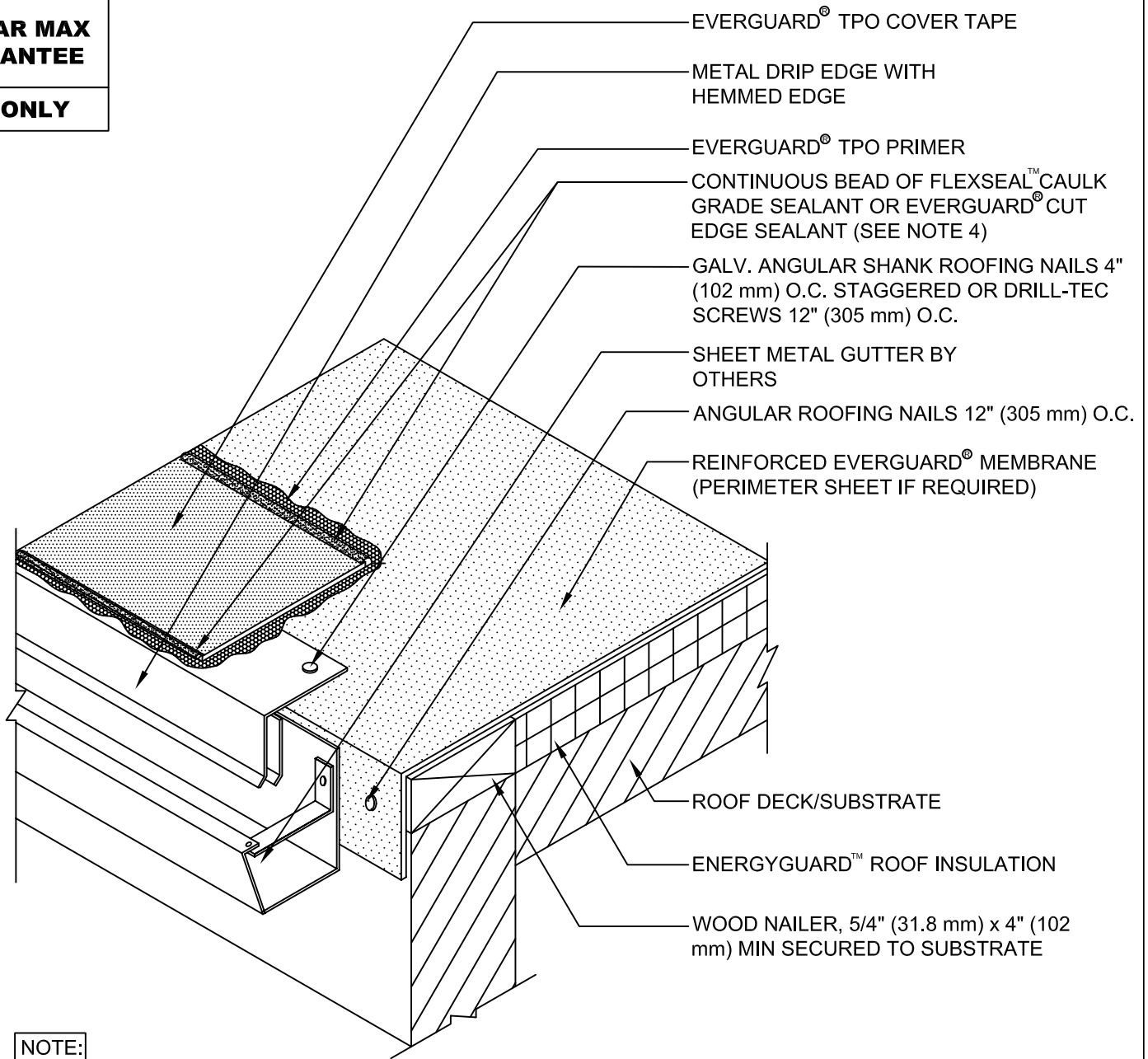

NOTE:

1. FOR INSULATION THICKNESS GREATER THAN 8" (203 mm), A HARD BOARD IS REQUIRED ON MECHANICAL SYSTEMS ONLY.
2. CLEAN METAL AND MEMBRANE WITH EVERGUARD® TPO SEAM CLEANER AND ALLOW TO DRY. ONCE DRY, PRIME METAL AND MEMBRANE WITH EVERGUARD® TPO PRIMER BEFORE INSTALLING EVERGUARD® TPO COVER TAPE.
3. THIS DETAIL IS **NOT** TO BE USED ON SLOPES GREATER THAN 1:12. FOR SLOPES GREATER THAN 1:12, REFER TO EVERGUARD® DETAIL 218 OR 219 .
4. FLEXSEAL™ CAULK GRADE SEALANT SHOULD BE FEATHERED OUT AND APPLIED TO BOTH INSIDE AND OUTSIDE EDGES. ENSURE PRIMER EXTENDS UNDER FLEXSEAL™ CAULK GRADE SEALANT.
5. APPLY EVERGUARD® TPO CUT EDGE SEALANT TO ALL CUT REINFORCED TPO EDGES (REFER TO EVERGUARD® DETAIL 115).



EverGuard
SINGLE-PLY ROOFING SYSTEMS
ROOF EDGE SERIES

DRAWING #
214B

**COVER TAPE AT GUTTER EDGE
DETAIL**

THIS DETAIL APPLIES TO:
Adhered Systems
Mechanically Attached
Systems
Self - Adhered Systems

www.gaf.com
1 Campus Drive,
Parsippany, NJ 07054

SCALE
N.T.S.

REVISION DATE
10-3-17