

FLASHING KEY

- 24" - 54" (610 mm -1.37 m)
REQUIRES BONDING ADHESIVE
- UP TO 24" (610 mm) DRY HUNG

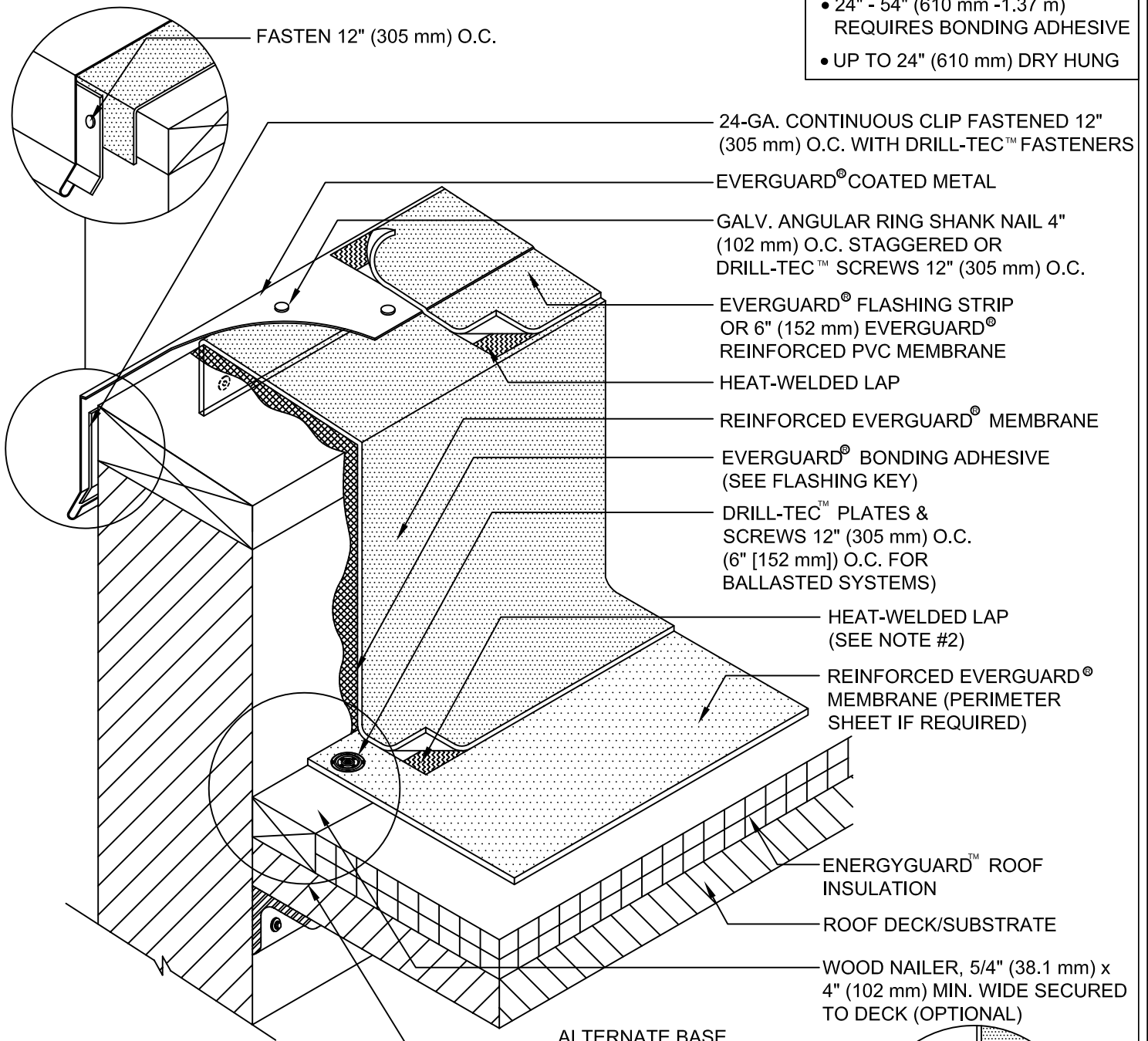

FASTEN 12" (305 mm) O.C.

24-GA. CONTINUOUS CLIP FASTENED 12" (305 mm) O.C. WITH DRILL-TEC™ FASTENERS

EVERGUARD® COATED METAL

GALV. ANGULAR RING SHANK NAIL 4" (102 mm) O.C. STAGGERED OR DRILL-TEC™ SCREWS 12" (305 mm) O.C.

EVERGUARD® FLASHING STRIP OR 6" (152 mm) EVERGUARD® REINFORCED PVC MEMBRANE

HEAT-WELDED LAP

REINFORCED EVERGUARD® MEMBRANE

EVERGUARD® BONDING ADHESIVE (SEE FLASHING KEY)

DRILL-TEC™ PLATES & SCREWS 12" (305 mm) O.C. (6" [152 mm]) O.C. FOR BALLASTED SYSTEMS)

HEAT-WELDED LAP (SEE NOTE #2)

REINFORCED EVERGUARD® MEMBRANE (PERIMETER SHEET IF REQUIRED)

ENERGYGUARD™ ROOF INSULATION

ROOF DECK/SUBSTRATE

WOOD NAILER, 5/4" (38.1 mm) x 4" (102 mm) MIN. WIDE SECURED TO DECK (OPTIONAL)

ALTERNATE BASE
REFER TO EVERGUARD® DETAIL 307

NOTE:

1. FOR INSULATION THICKNESS GREATER THAN 8" (203 mm), A HARD BOARD IS REQUIRED ON MECHANICALLY FASTENED SYSTEMS ONLY.
2. IF EVERGUARD®FREEDOM™ MEMBRANE IS USED, BONDING ADHESIVE IS NOT NEEDED AND WALL MUST BE PRIMED
3. APPLY EVERGUARD® TPO CUT EDGE SEALANT TO ALL CUT REINFORCED TPO EDGES (REFER TO EVERGUARD® DETAIL 115).

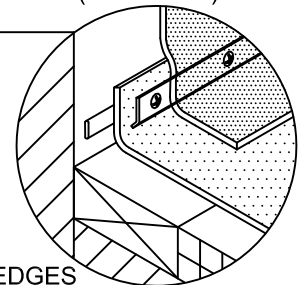

EverGuard
SINGLE-PLY ROOFING SYSTEMS
PARAPET WALL &
CURB SERIES

DRAWING #

304

SCALE
N.T.S.

**WALL FLASHING WITH COATED
METAL EDGE DETAIL**

THIS DETAIL APPLIES TO:

ALL SYSTEMS

REVISION DATE
6-20-16

www.gaf.com
1 Campus Drive,
Parsippany, NJ 07054