

PLAN VIEW

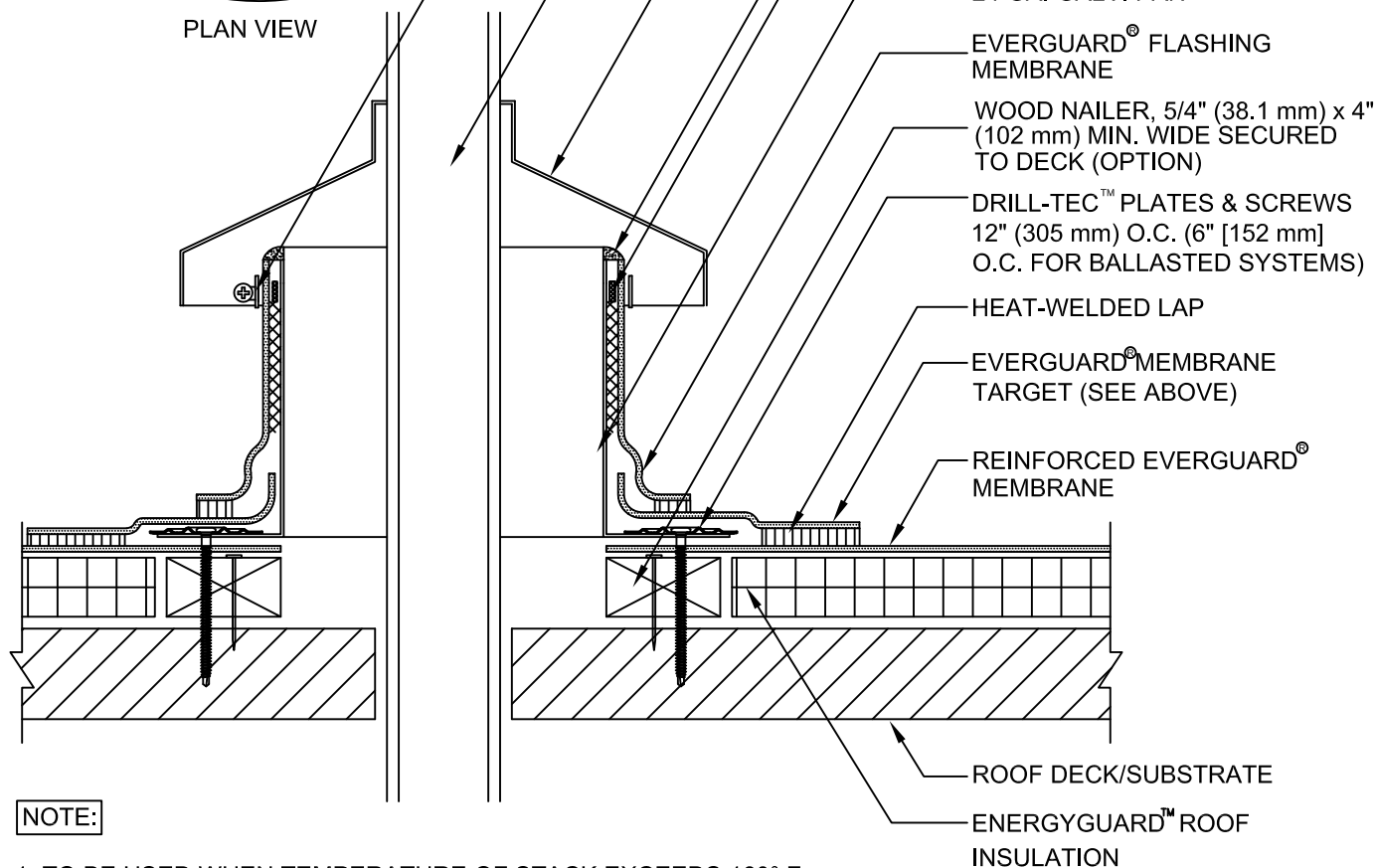

NOTE:

1. TO BE USED WHEN TEMPERATURE OF STACK EXCEEDS 160° F.
2. FOR INSULATION THICKNESS GREATER THAN 8" (203 mm), A HARD BOARD IS REQUIRED ON MECHANICAL SYSTEMS ONLY.
3. APPLY HEAT TO DETAIL MEMBRANE AND FORM BY HAND PRIOR TO INSTALLING.
4. APPLY EVERGUARD® TPO CUT EDGE SEALANT TO ALL CUT REINFORCED TPO EDGES (REFER TO EVERGUARD® DETAIL 115).



EverGuard
SINGLE-PLY ROOFING SYSTEMS
ROOF PENETRATION
SERIES

DRAWING #

508

SCALE
N.T.S.

**HIGH TEMPERATURE STACK
FLASHING DETAIL**

THIS DETAIL APPLIES TO:

ALL SYSTEMS

REVISION DATE
5-25-16

www.gaf.com
1 Campus Drive,
Parsippany, NJ 07054