

## GAF EnergyGuard™ Polyiso Wall Sheathing

GAF's EnergyGuard Polyiso Wall Sheathing is intended to be installed on residential construction only. Application types include:

- Framed stud walls (exterior & interior)
- Re-siding
- Exterior masonry walls
- Vaulted/cathedral ceilings
- Interior basement walls

The following are general application instructions. Be sure to review complete instructions at [www.gaf.com](http://www.gaf.com).

### Interior Basement Walls... General Application Instructions:

- Install EnergyGuard™ Polyiso Wall Sheathing boards to the interior side of the basement masonry wall so that the longer edge is positioned vertically against the field of the wall. Make sure the board joints are in contact with each other, with the printed side facing the interior.
- Seal all interior openings and penetrations with all-weather sealant, such as silicone caulk, prior to taping. Make sure all areas are clean prior to sealing and taping to ensure proper adhesion.
- Center and apply 3" (76 mm) wide foil flashing tape to all board joints. Make sure all areas are clean prior to taping to ensure proper adhesion.
- Apply tape in accordance with the manufacturer's application instructions.

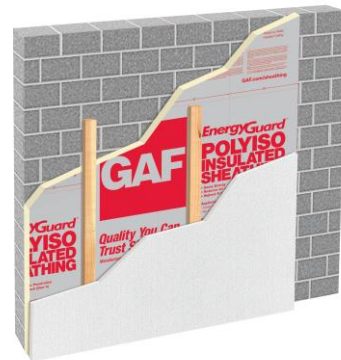

### Installation with Wood Furring

- Spot fasten all boards to wall using construction-grade adhesive following the adhesive manufacturer's instructions.

- Center and apply 3" (76 mm) wide foil flashing tape to all board joints. Make sure all areas are clean prior to taping to ensure proper adhesion.
- Apply tape in accordance with the manufacturer's application instructions.
- Install wood furring strips a maximum 16" (406mm) o.c. vertically over the EnergyGuard™ Polyiso Wall Sheathing boards with appropriate masonry mechanical fasteners.
- Be sure to install furring strips over the vertical joints of the insulation boards.
- Fasteners must be long enough to penetrate through the furring strip into the concrete wall at least 3/4" (19mm). Do not overdrive the fasteners.

#### **Installation with Conventional Stud Wall**

- Spot fasten all EnergyGuard™ Polyiso Wall Sheathing boards to the masonry basement wall using construction-grade adhesive following the adhesive manufacturer's instructions.
- Center and apply 3" (76 mm) wide foil flashing tape to all board joints. Make sure all areas are clean prior to taping to ensure proper adhesion.
- Apply tape in accordance with the manufacturer's application instructions.
- Construct a conventional stud wall that firmly applies pressure to the installed EnergyGuard™ Polyiso Wall Sheathing boards.
- Install batt insulation in between studs as required by local codes.
- Always cover EnergyGuard™ Polyiso Wall Sheathing boards with a code-approved interior cladding system such as 1/2" (13mm) gypsum board. Install gypsum boards in accordance with the gypsum board manufacturer's application instructions.
- In areas of high humidity or as required by local code, install a vapor retarder.

#### **NOTE:**

1. The insulation boards must be separated from the interior of the building by an approved thermal barrier in accordance with IBC Section 2603.4 or IRC Section R316.4 as applicable. Contact your local building code official for requirements on fire barriers. **Do not leave boards exposed to the weather or near high heat sources.** In addition, the insulation shall not come into contact with hot objects.
2. EnergyGuard™ Polyiso Wall Sheathing boards can be applied to most oil-base waterproofing coatings. Refer to coating manufacturer's instructions.

For other types of application or further information, contact our Technical Services at **800-ROOF-411** (800-766-3411) or [www.gaf.com](http://www.gaf.com).